

**Apple ID: username
@students.princehenrys.co.uk**



Prince Henry's Grammar School
SPECIALIST LANGUAGE COLLEGE



iPad- Personal Setup

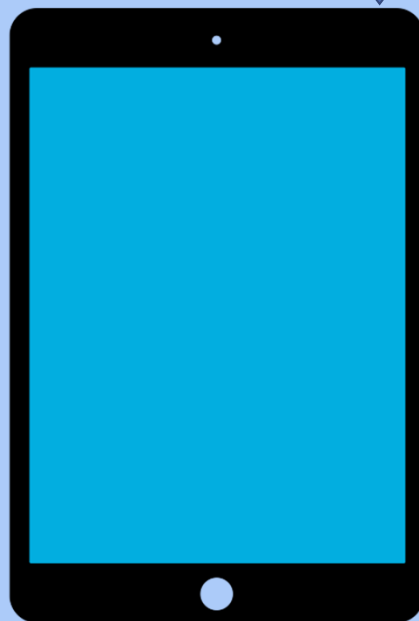

TURN ON YOUR IPAD

If your iPad is not already on, turn it on now using the button at the top right hand corner.

GETTING STARTED

Hello

> slide to set up

This is the first screen you will be presented with. Swipe from left to right to dismiss this message.

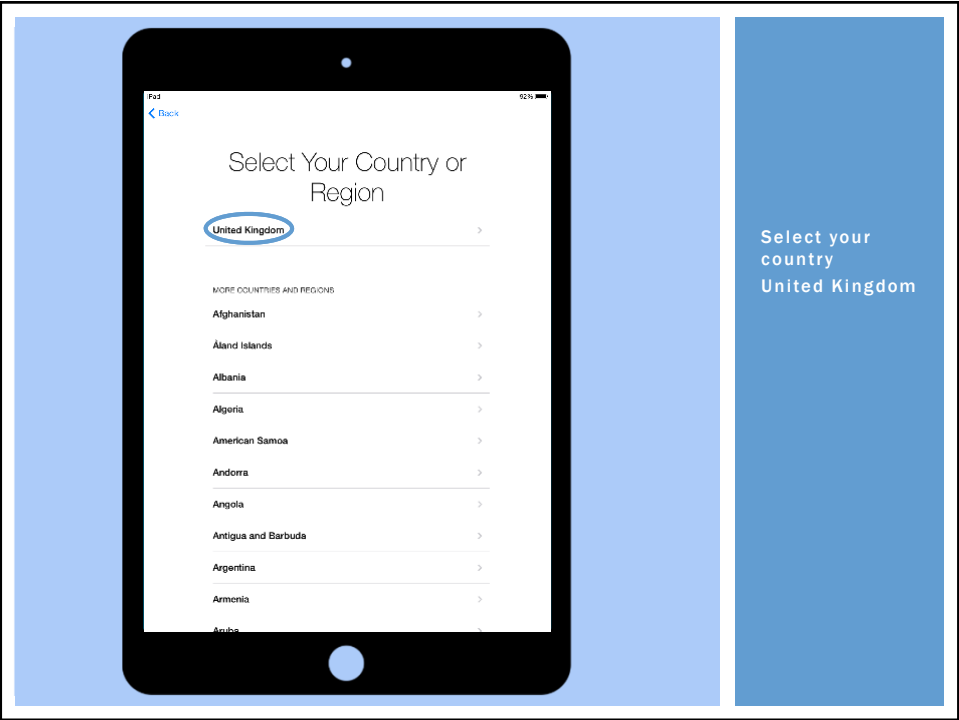
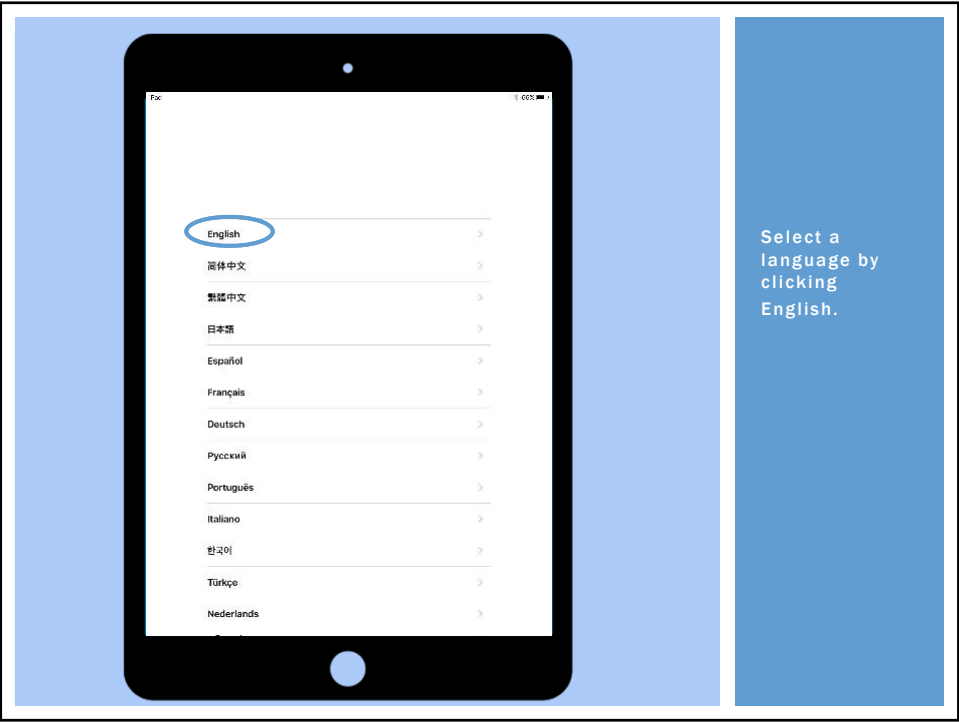

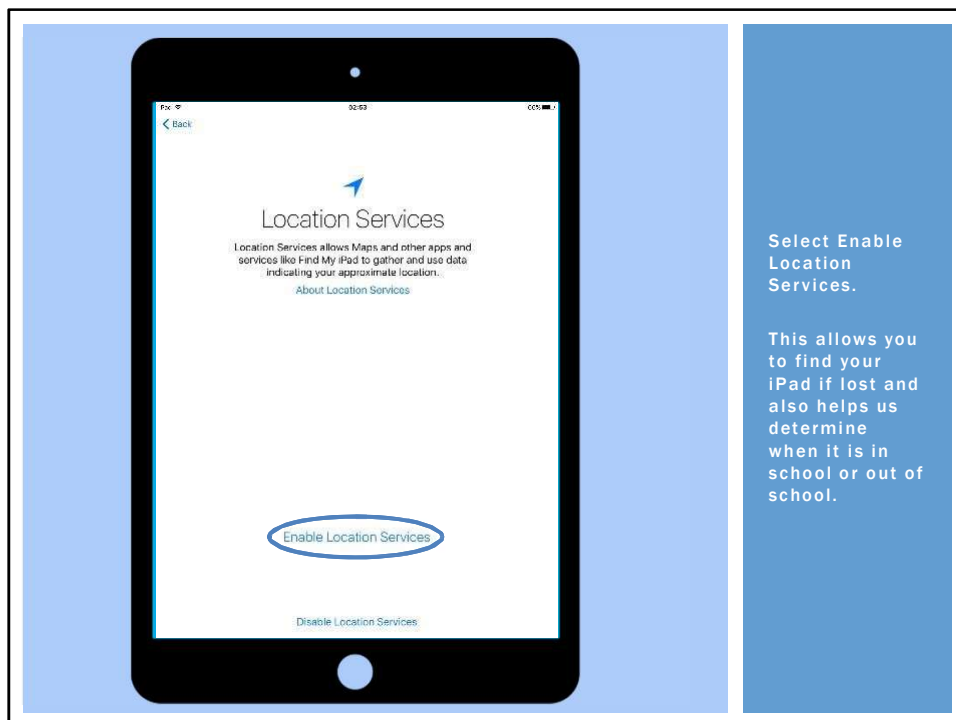
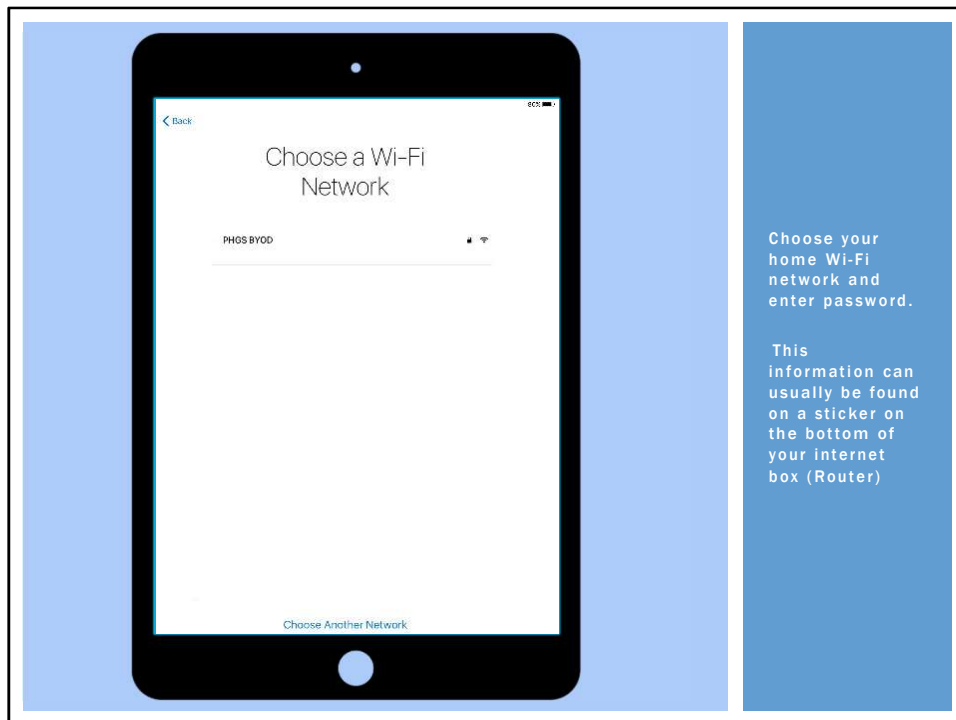

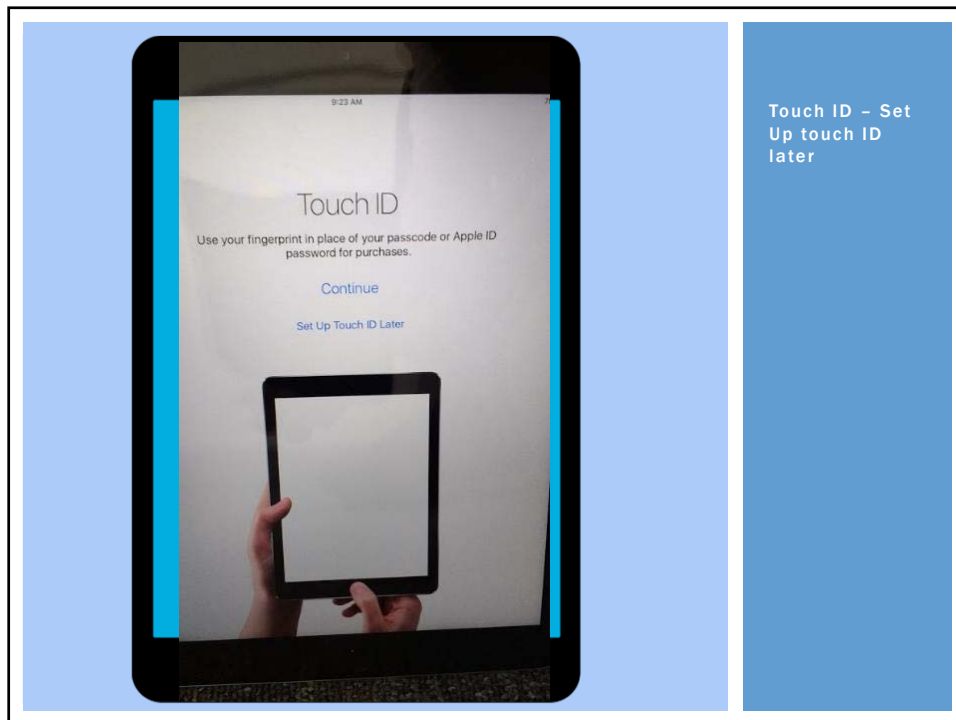

Touch ID – Set
Up touch ID
later

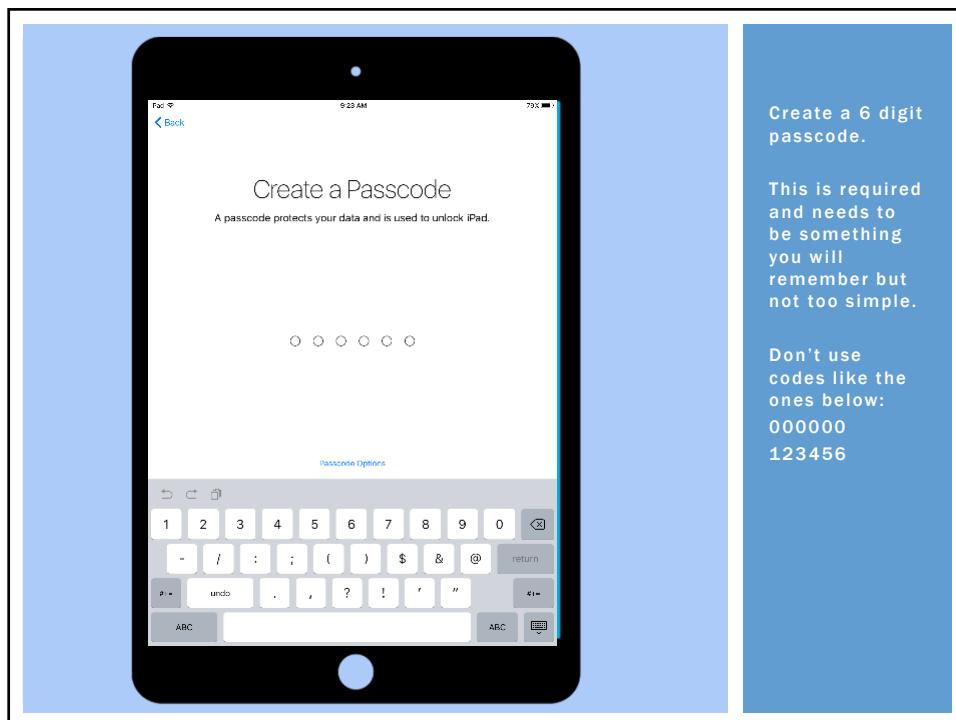

Create a 6 digit
passcode.

This is required
and needs to
be something
you will
remember but
not too simple.

Don't use
codes like the
ones below:
000000
123456

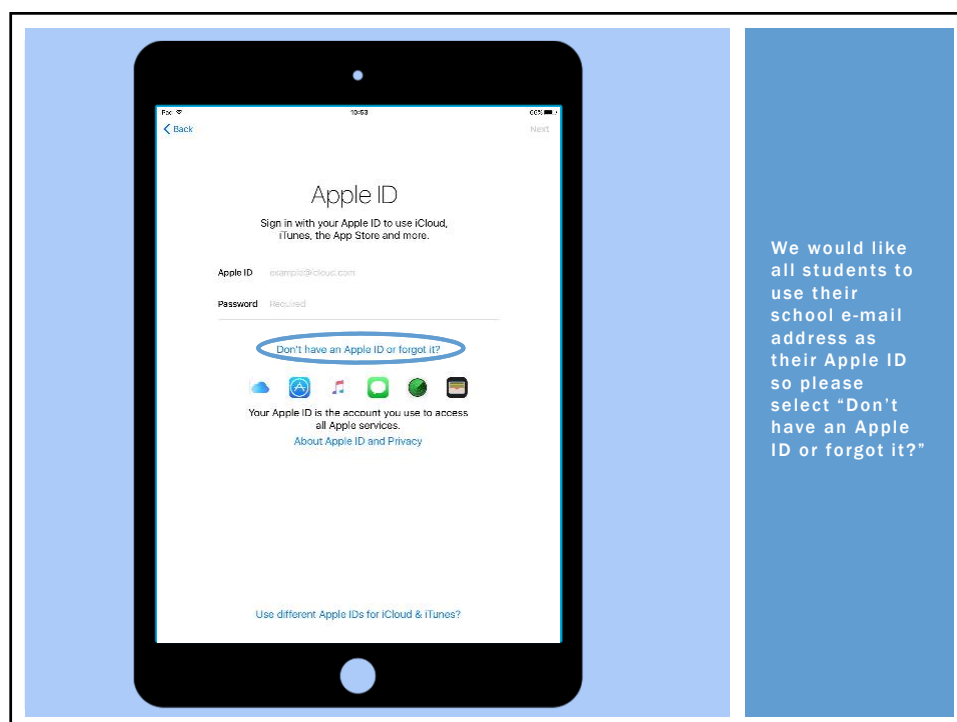
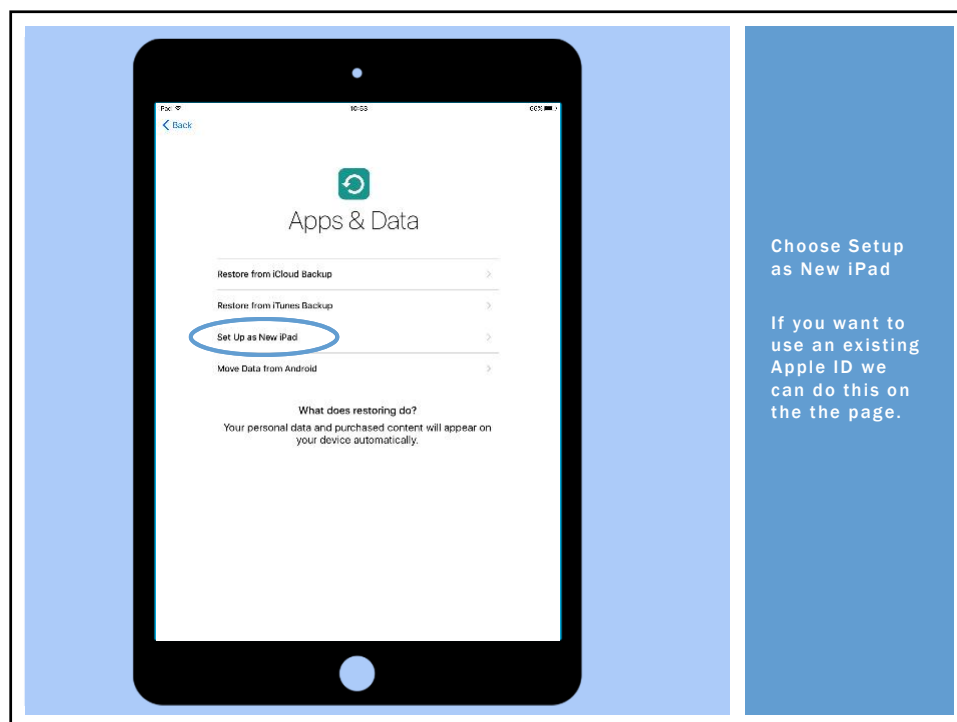

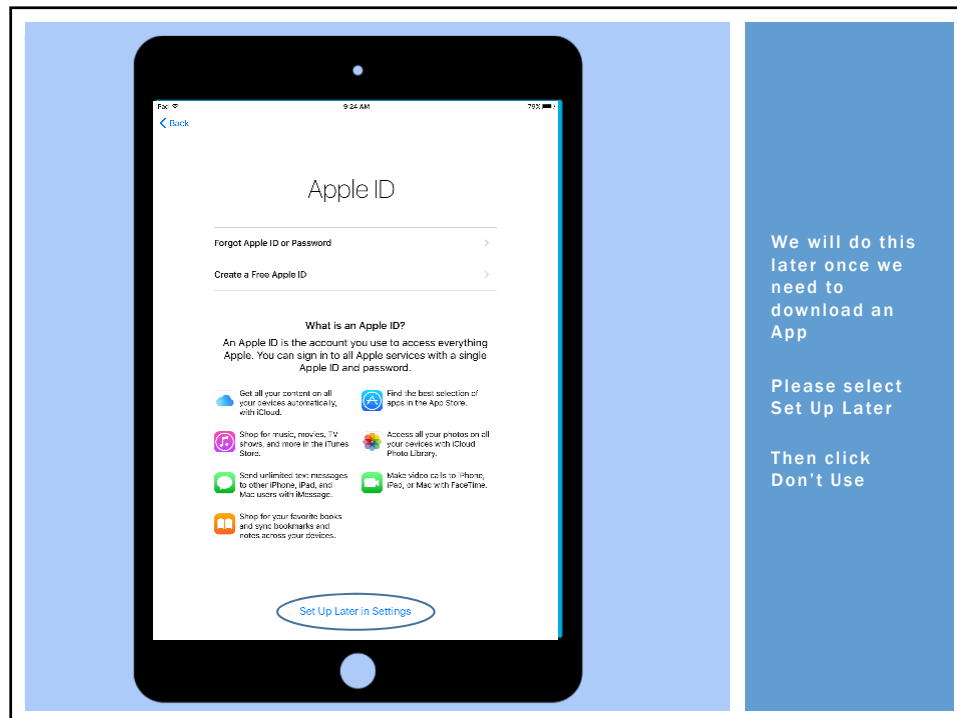

We will do this later once we need to download an App

Please select Set Up Later

Then click Don't Use

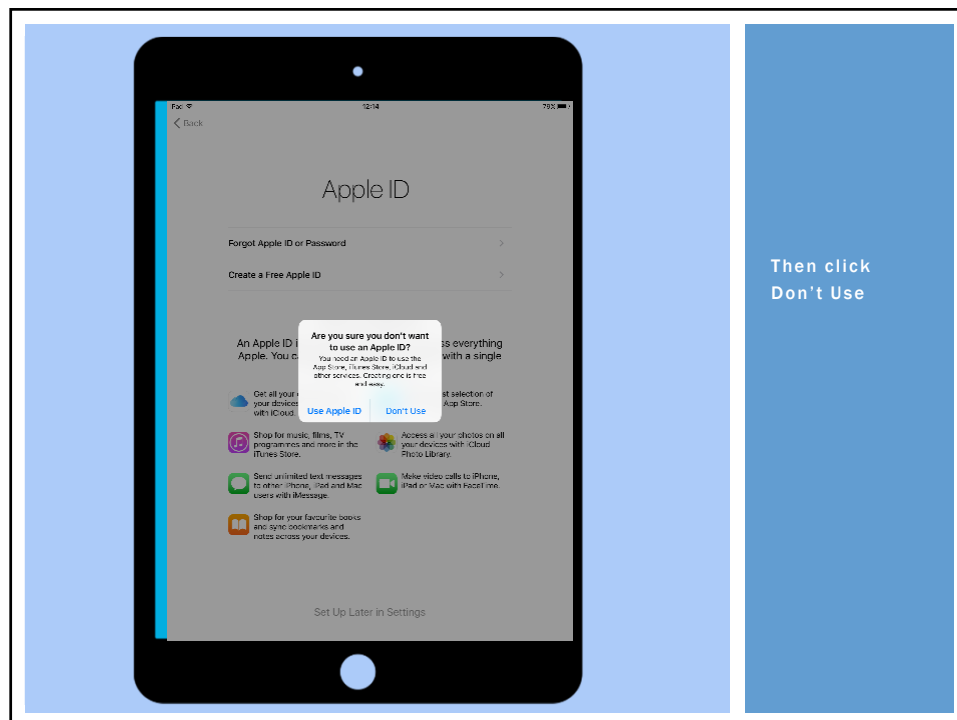

Then click Don't Use

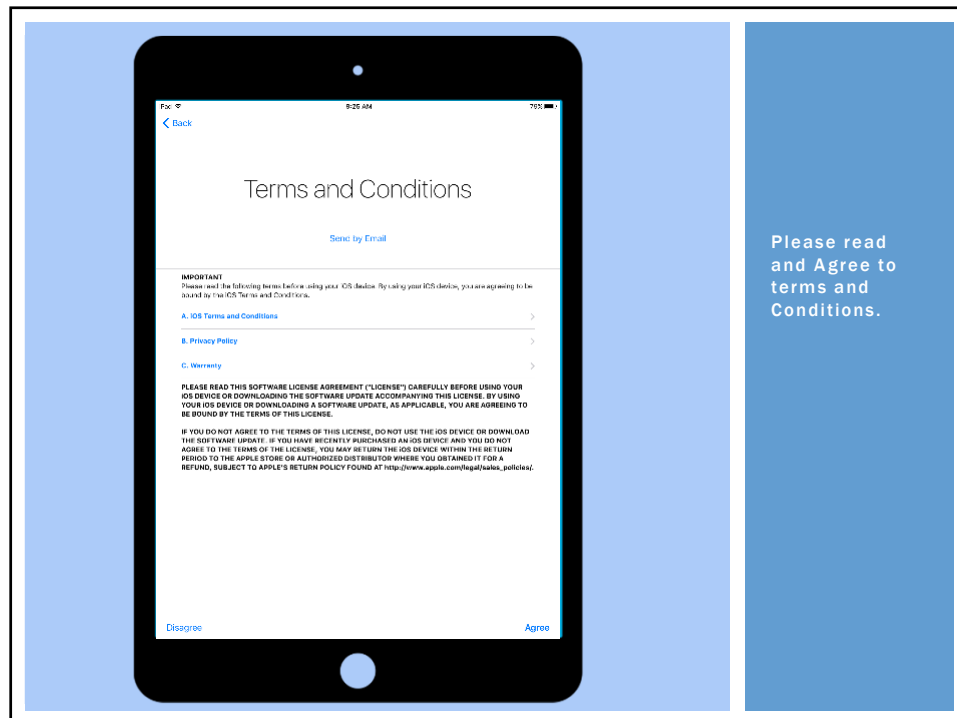

Please read
and Agree to
terms and
Conditions.

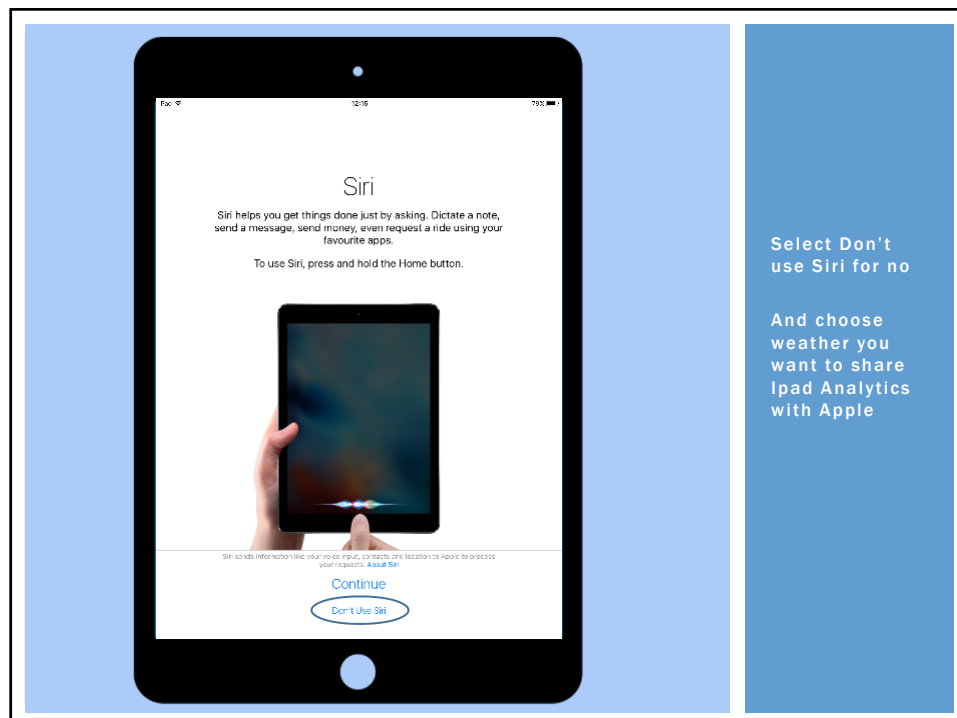

Select Don't
use Siri for no

And choose
weather you
want to share
Ipad Analytics
with Apple

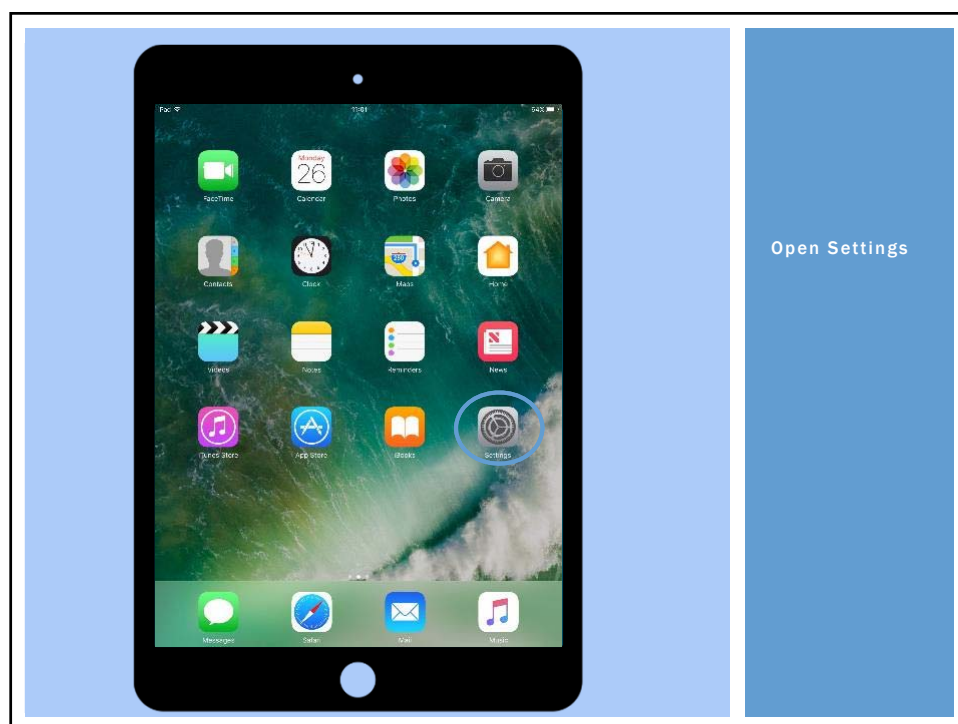
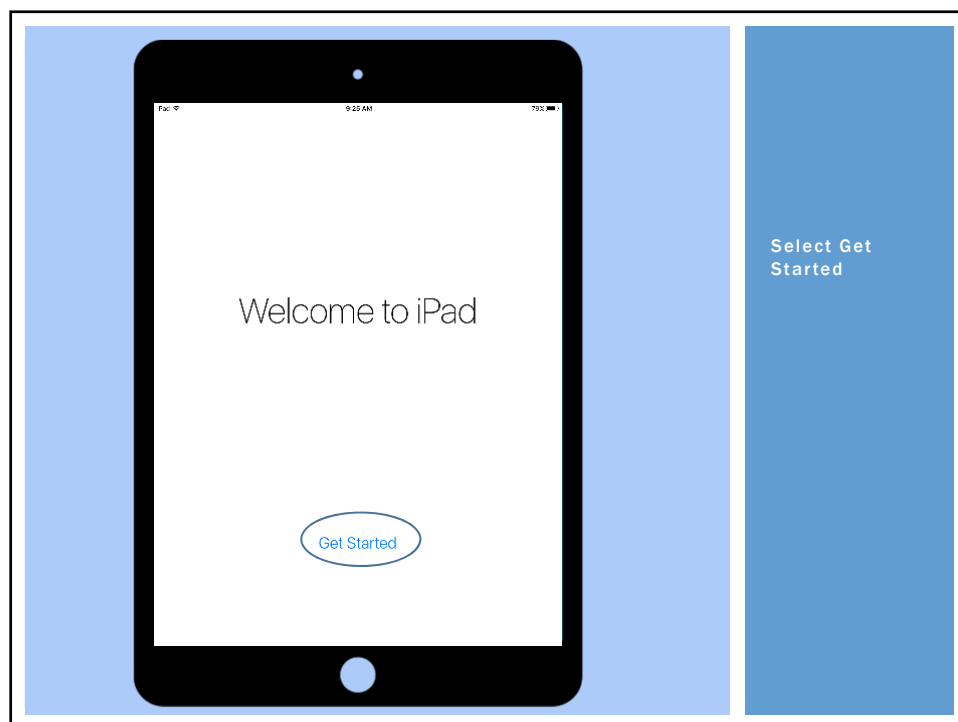

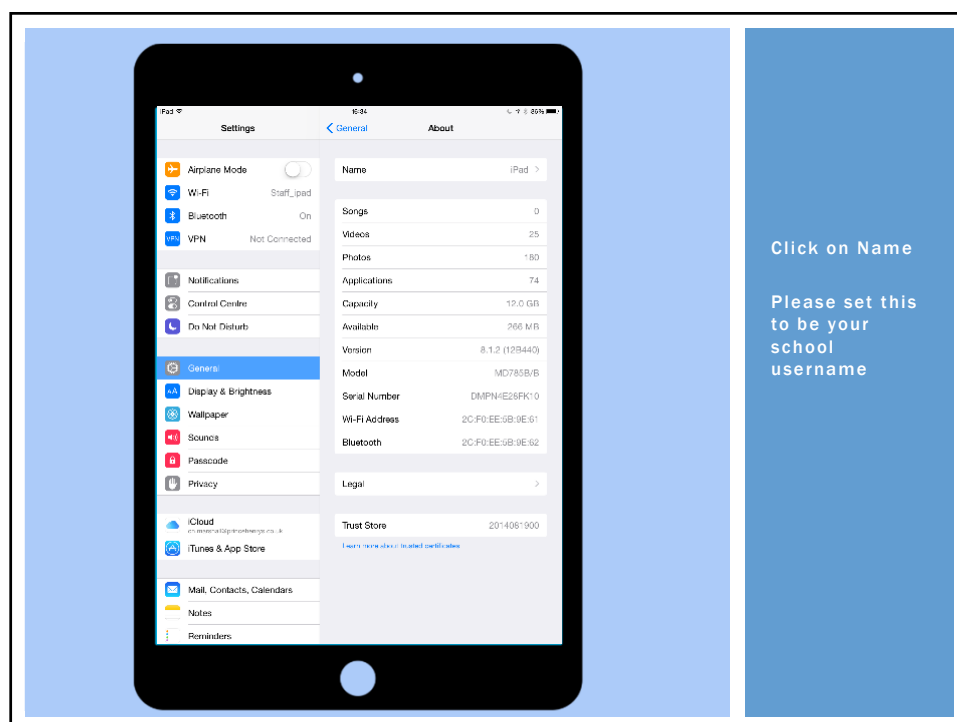
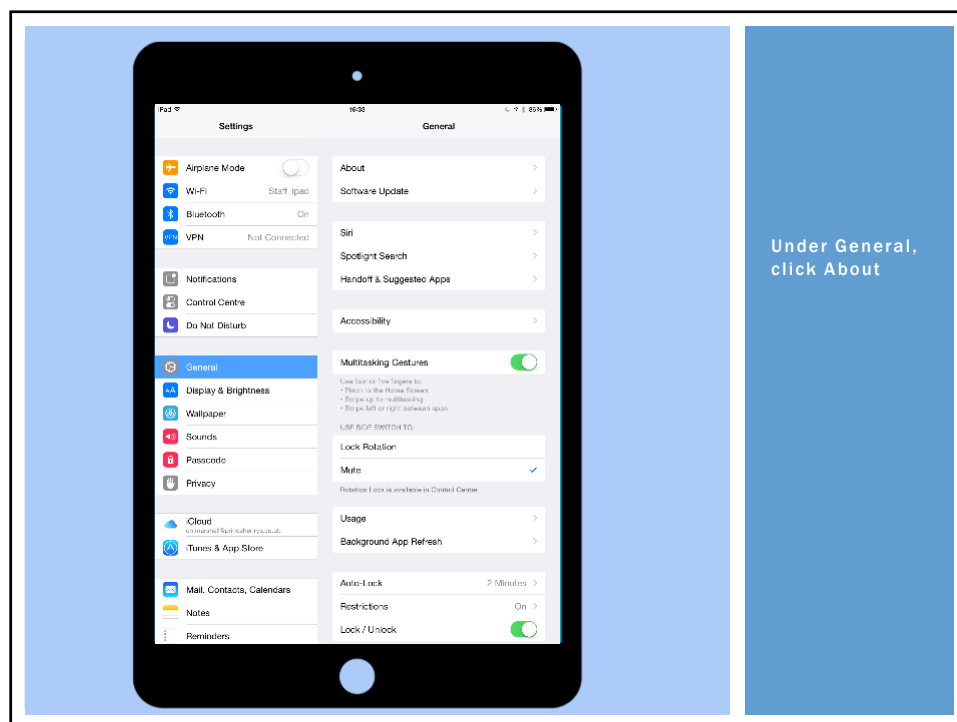

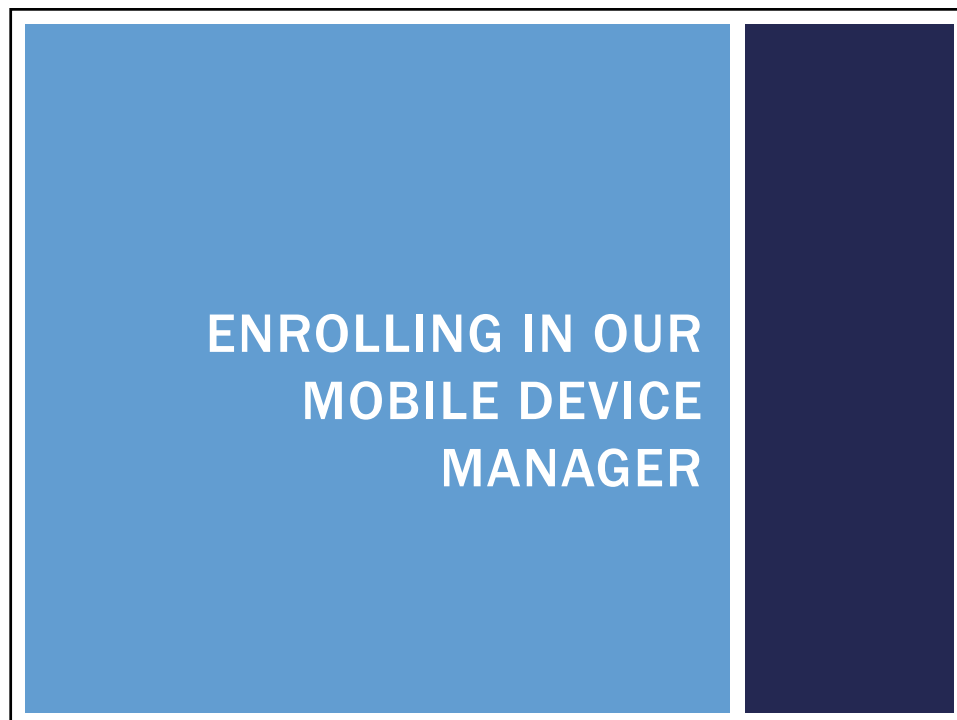
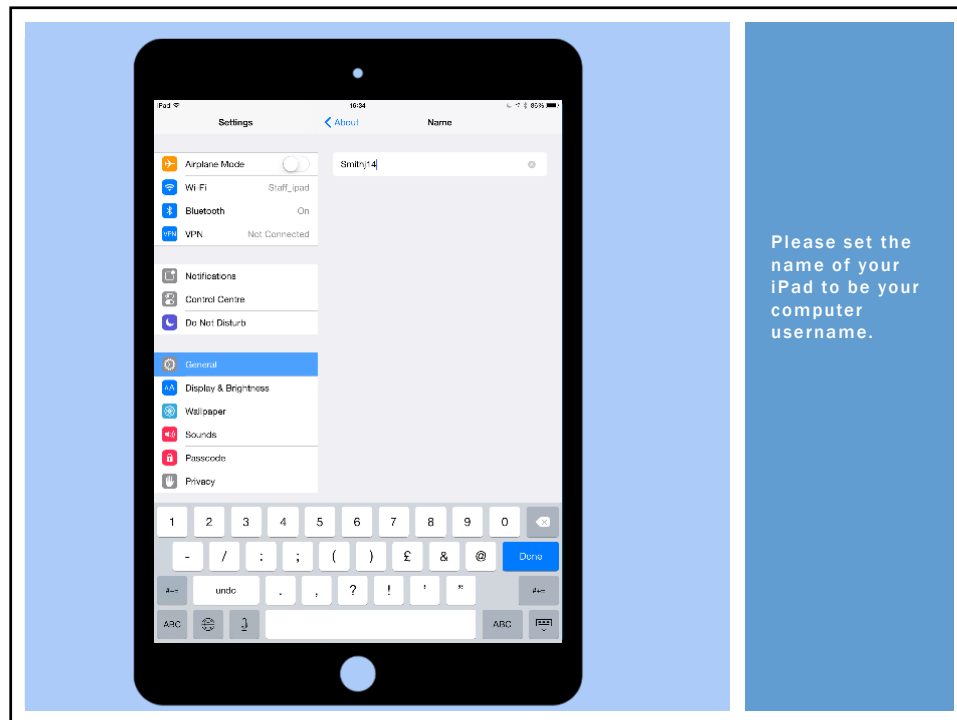

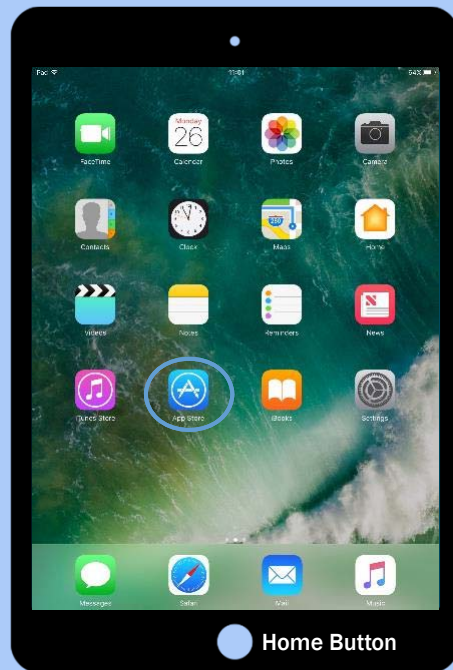

Press Home button and then Open up the App Store to install your first App.

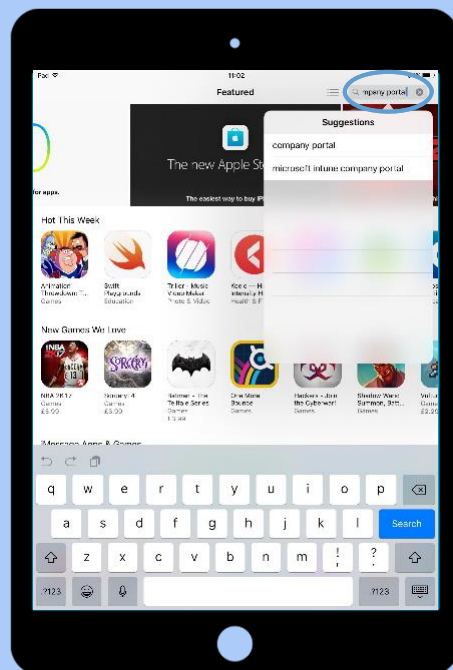

Type in
Company portal
And click
"Microsoft
Intune
Company
Portal"

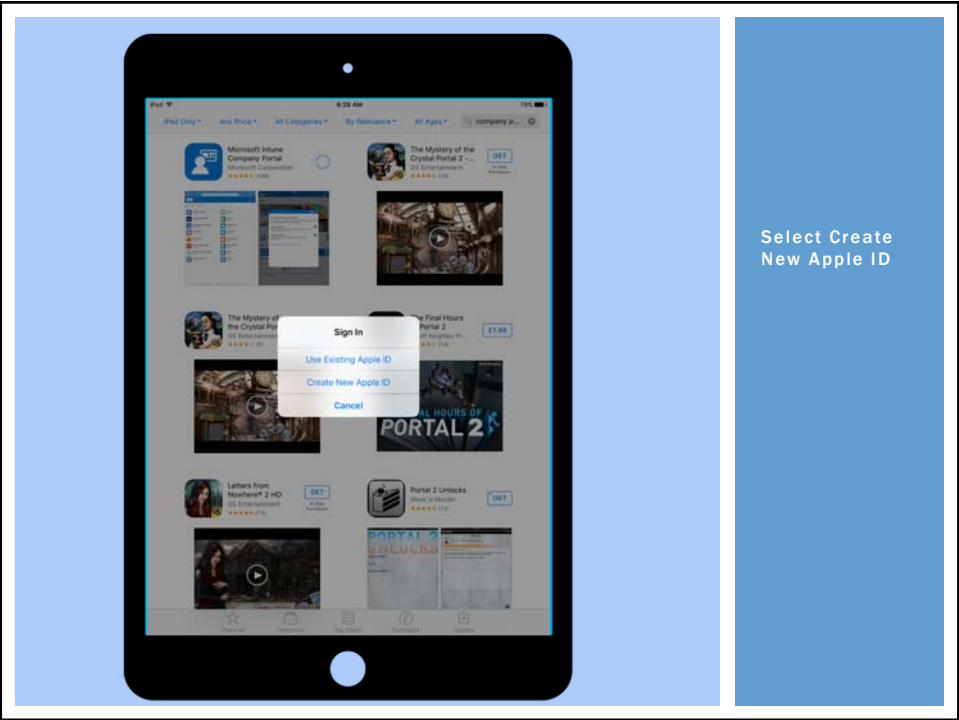
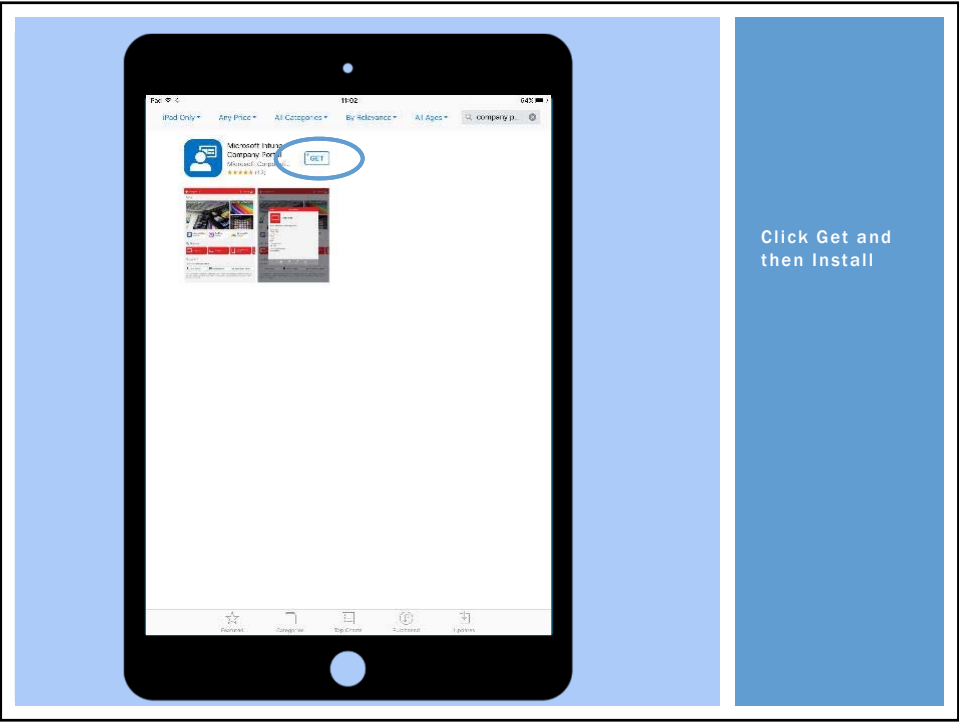

CREATING A NEW APPLE ID

- As your child is under 13 you we need to open an Apple ID account and manage it on behalf of your child. You can then pass this account over to them when they reach 13 if you like.
- **For now the account belongs to you, the parent, so please fill the details in for yourself. If you use your child's details and date of birth the account will fail to create.**
- Please use the e-mail address provided by the school for the Apple ID. This will allow us to help you more in the event of a forgotten password etc.

@students.princehenrys.co.uk

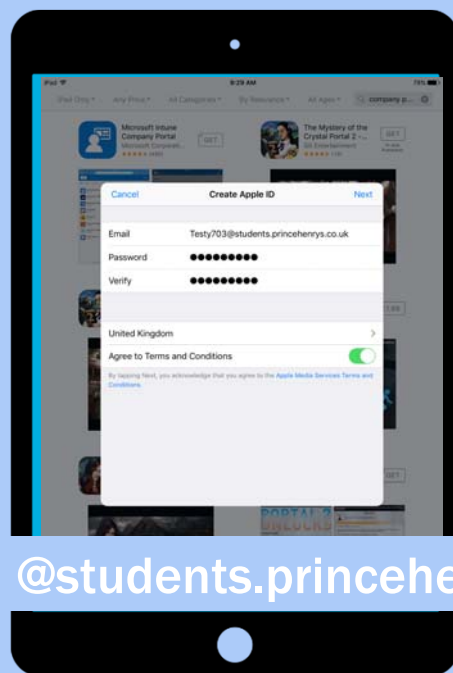

Please enter your
Child email address

Eg
Smithj17@students.princehenrys.co.uk

Please choose a
secure password with
at least 8 characters
including 1 capital
letter and a number.

@students.princehenrys.co.uk

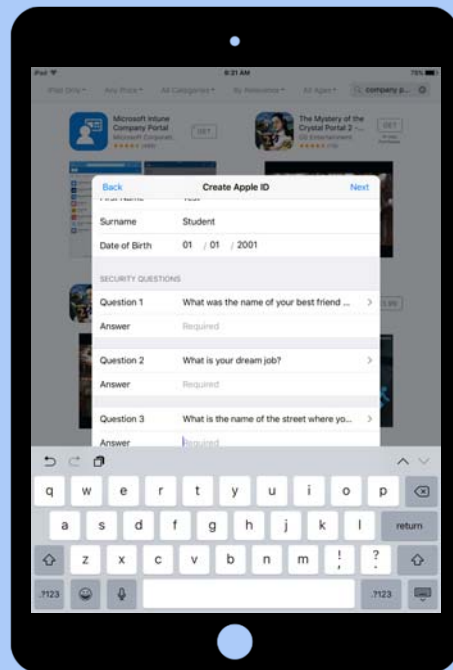

Enter your Name and
DOB

Please don't use your
child's DOB as this
will not work and
account will fail to
create

Please Select 3
questions and answer
them

Try to choose
questions where the
answer can not
change and make
sure your spelling is
correct, you will use
these questions to
recover your
password if forgotten.

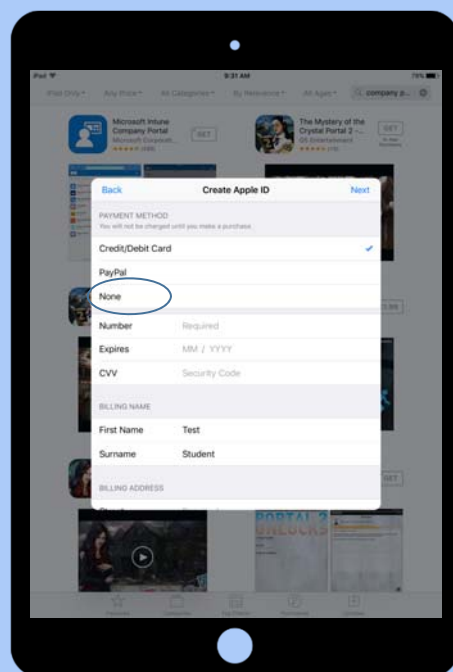

Credit/Debit
Card

Select None

Enter Name
and address
and contact
number.

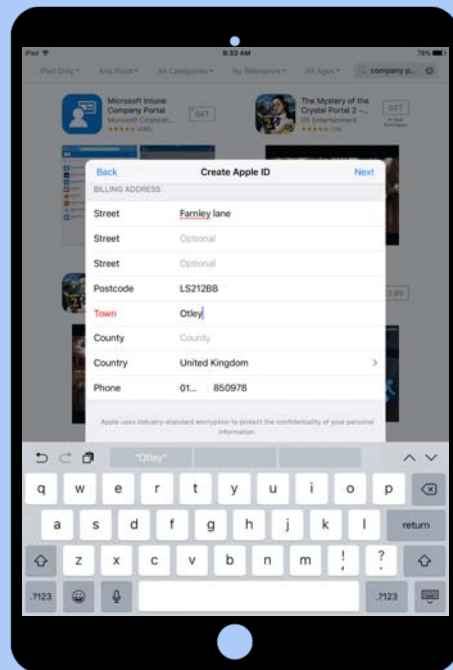

Enter your Address
and Phone number.

Note the phone
number can be
used by Apple to
send an automated
message for
password reset if
requested.

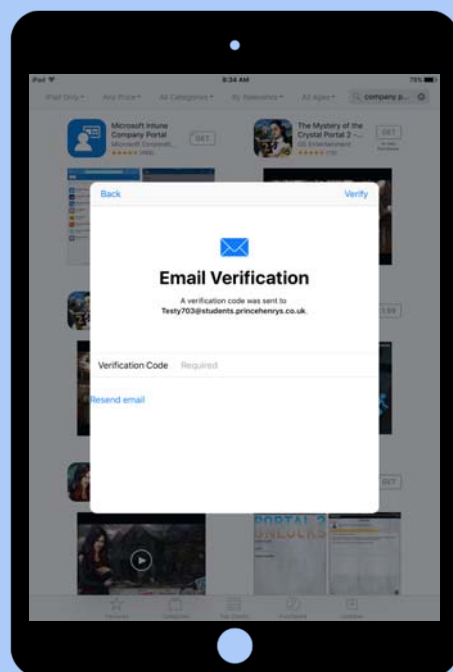

Please ask your
child to check
school email
for a 5 digit
code from
Apple.

Enter this and
click Verify

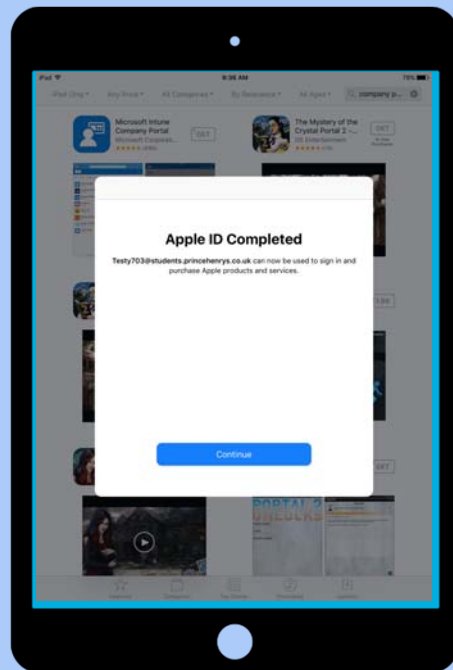

Please Select 3 questions and answer them

Try to choose questions where the answer can not change and make sure your spelling is correct, you will use these questions to recover your password if forgotten.



Now Apple ID is setup , we can continue to download our first App and enroll Device

Enter password you just choose for Apple ID



Click either

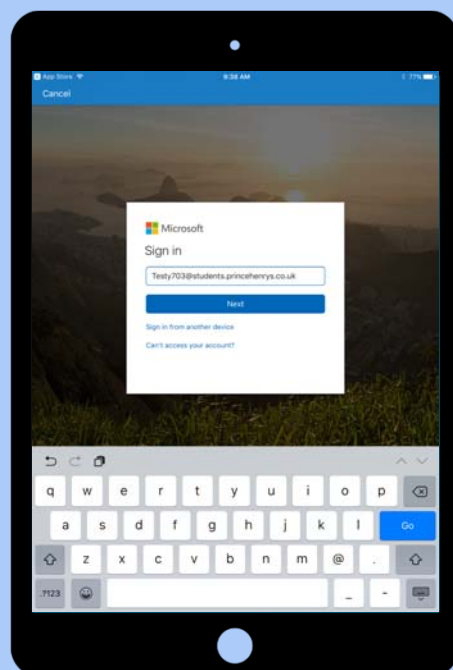

Sign in with
school email
address

username@stud
ents.princehenr
ys.co.uk

