

# iPad Setup Guide

iPad 9th Generation  
Setup Guide 2024

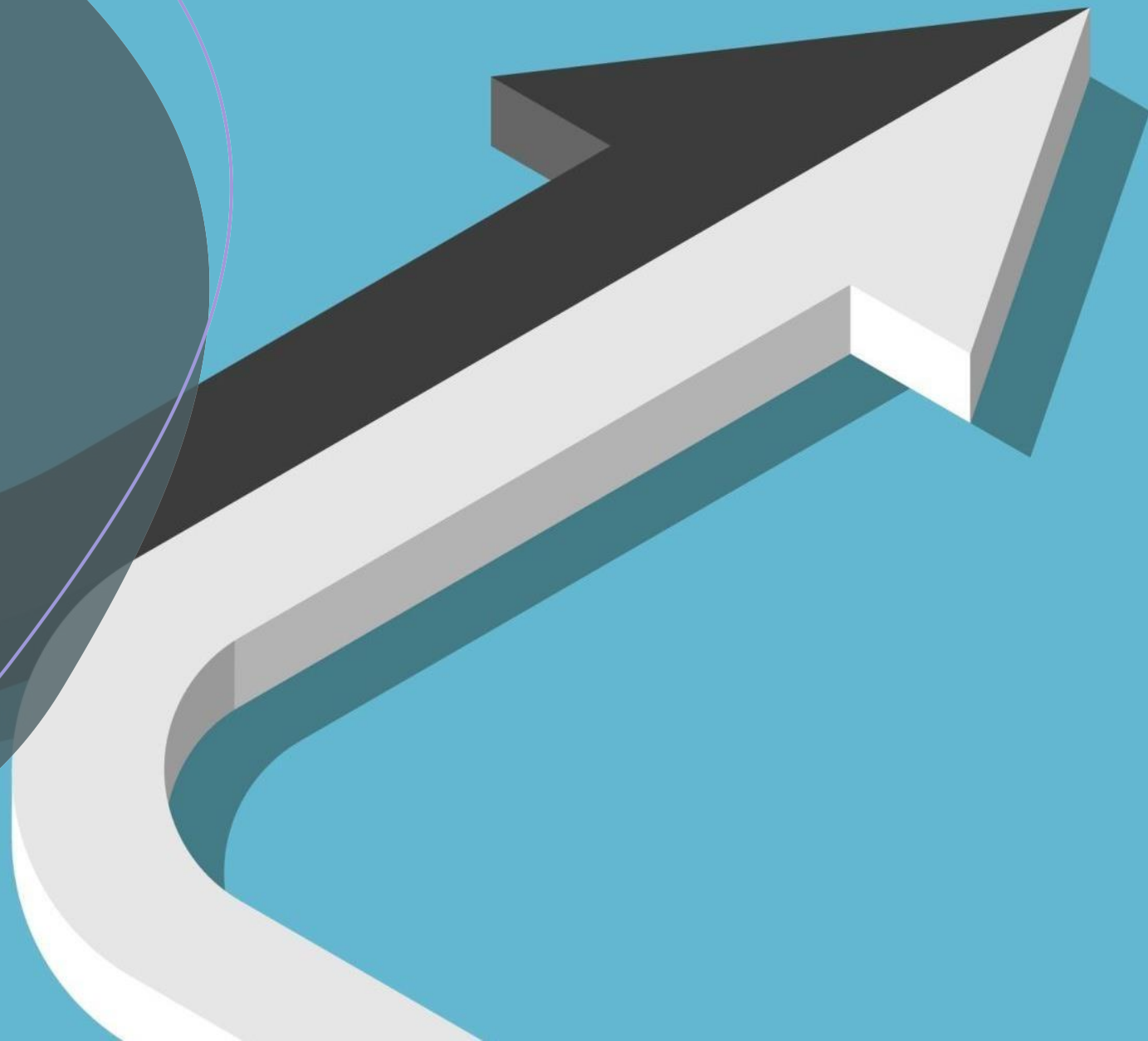

# 1. Press the Home Button.

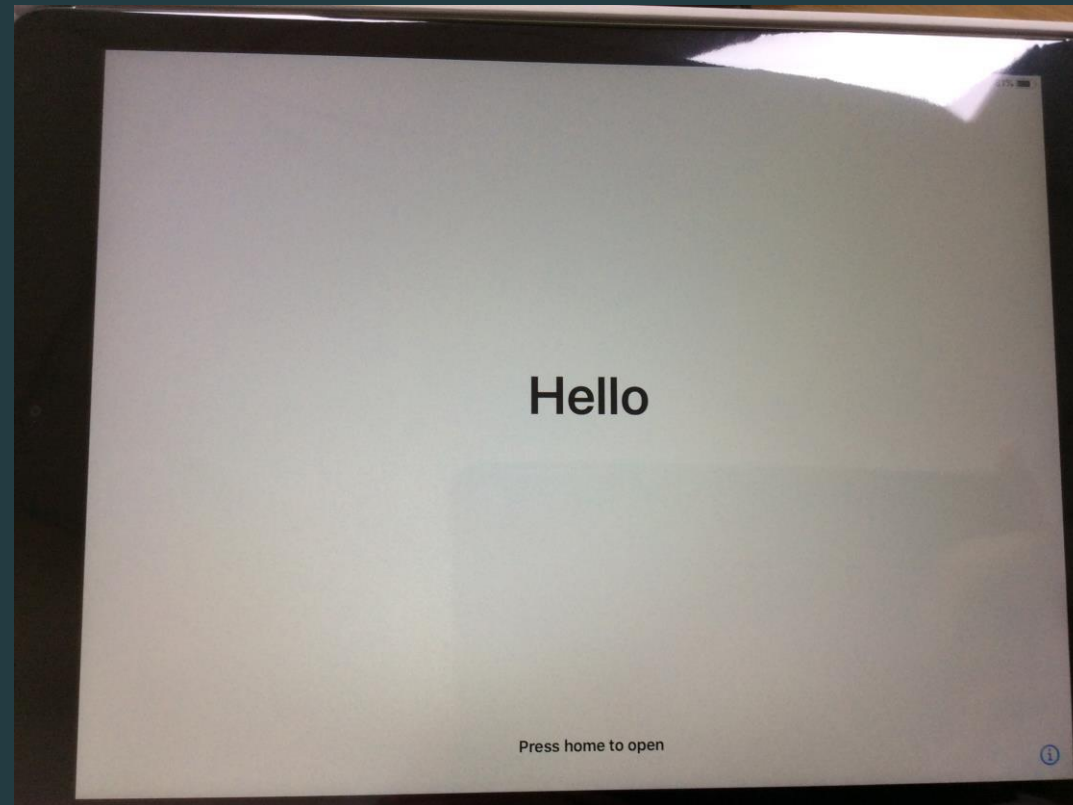

## 2. Tap 'English'

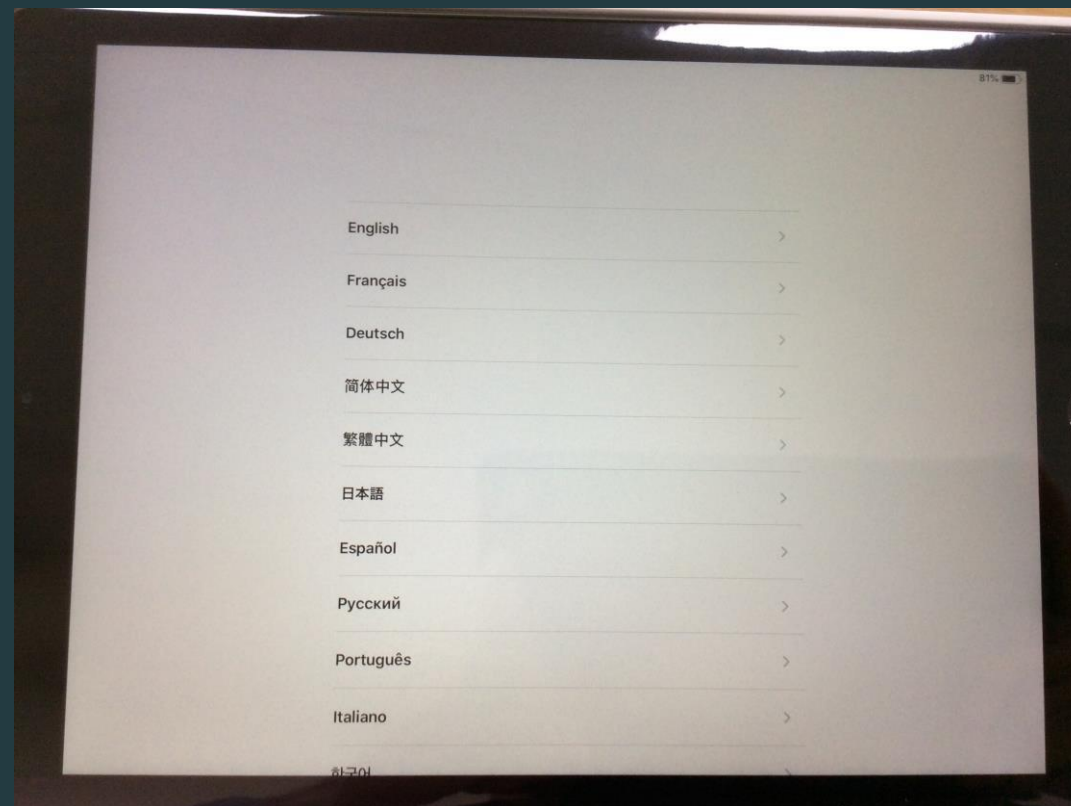

### 3. Tap 'United Kingdom'

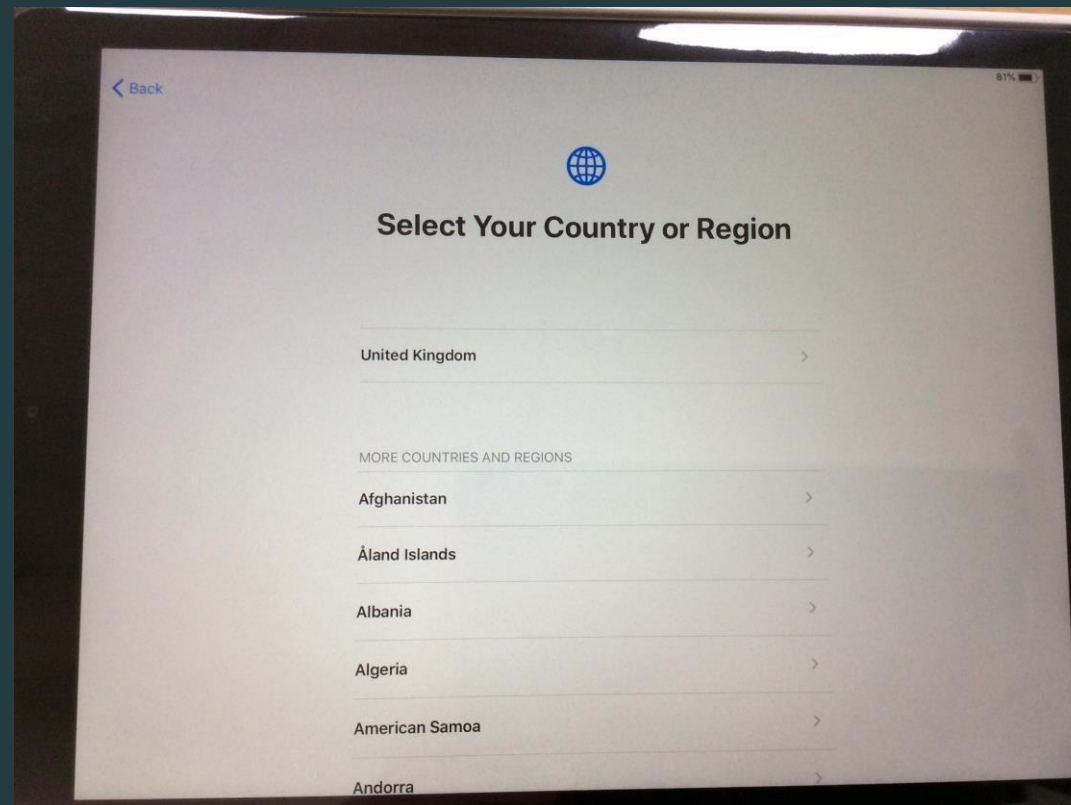

# 4. Tap 'Set Up Manually'

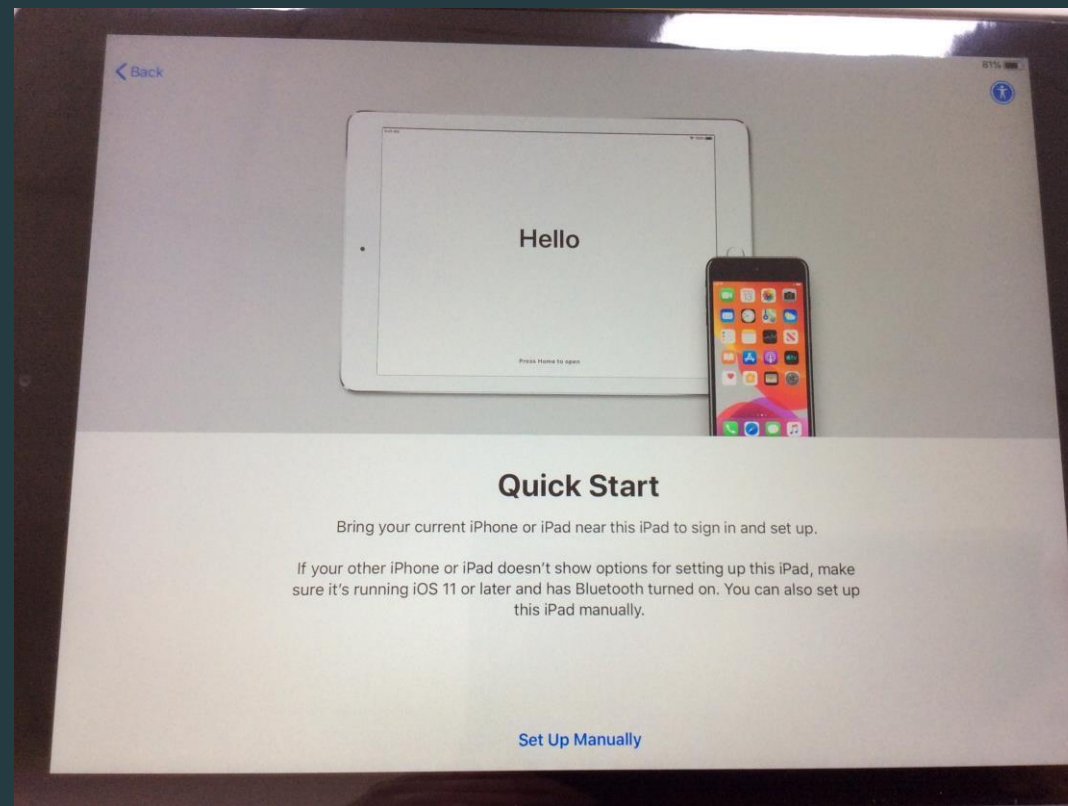

5. Connect it to Wi-Fi by tapping the name of your home Wi-fi Network.

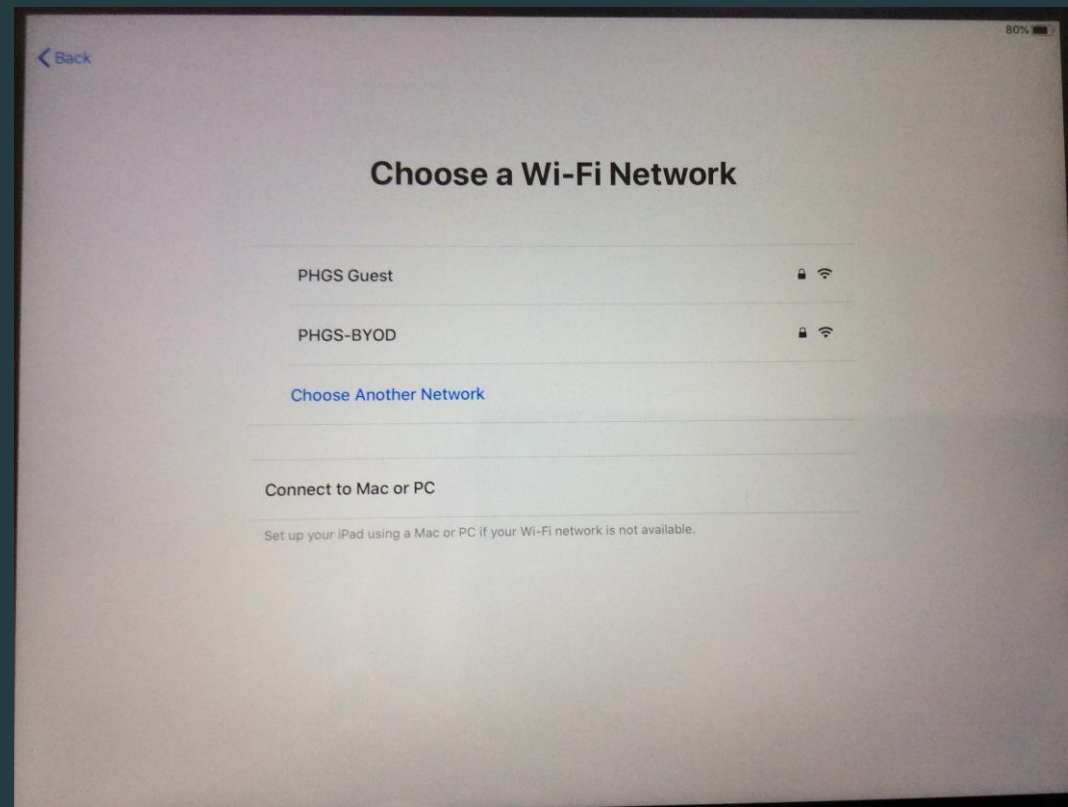

# 6. Tap 'Continue'

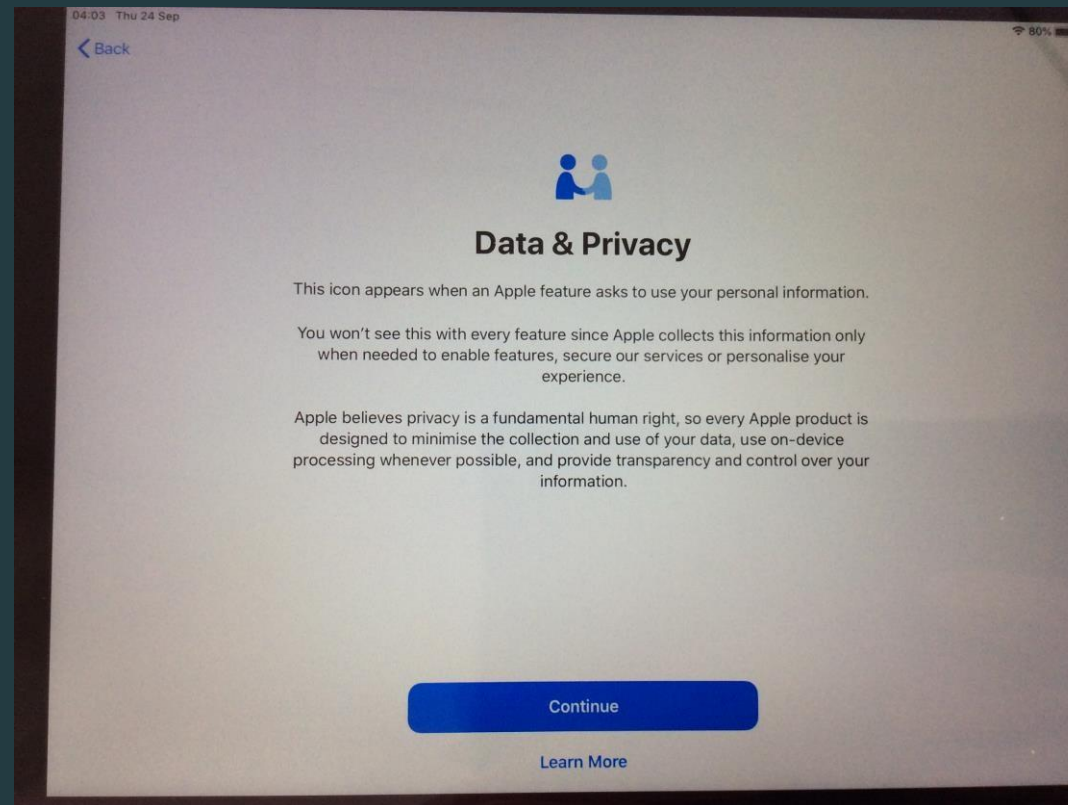

# 7. Tap 'Next'

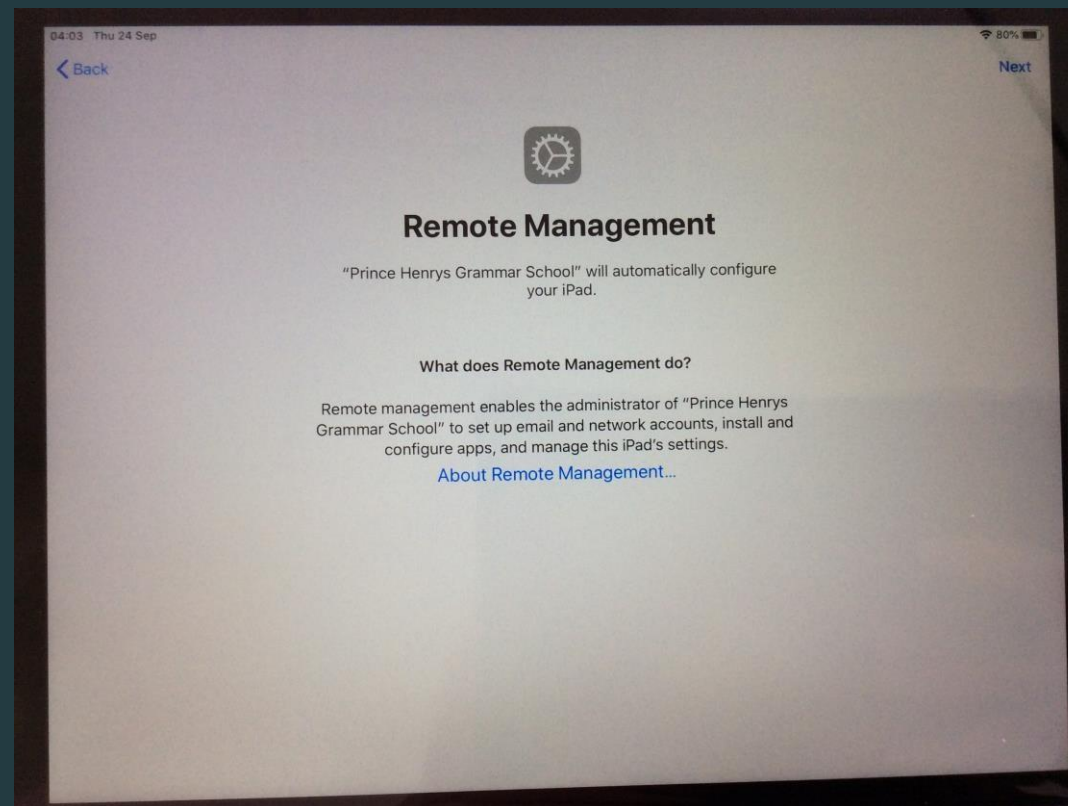



8. Type in your student's email address and password. (The same password they use for the computers at school.)

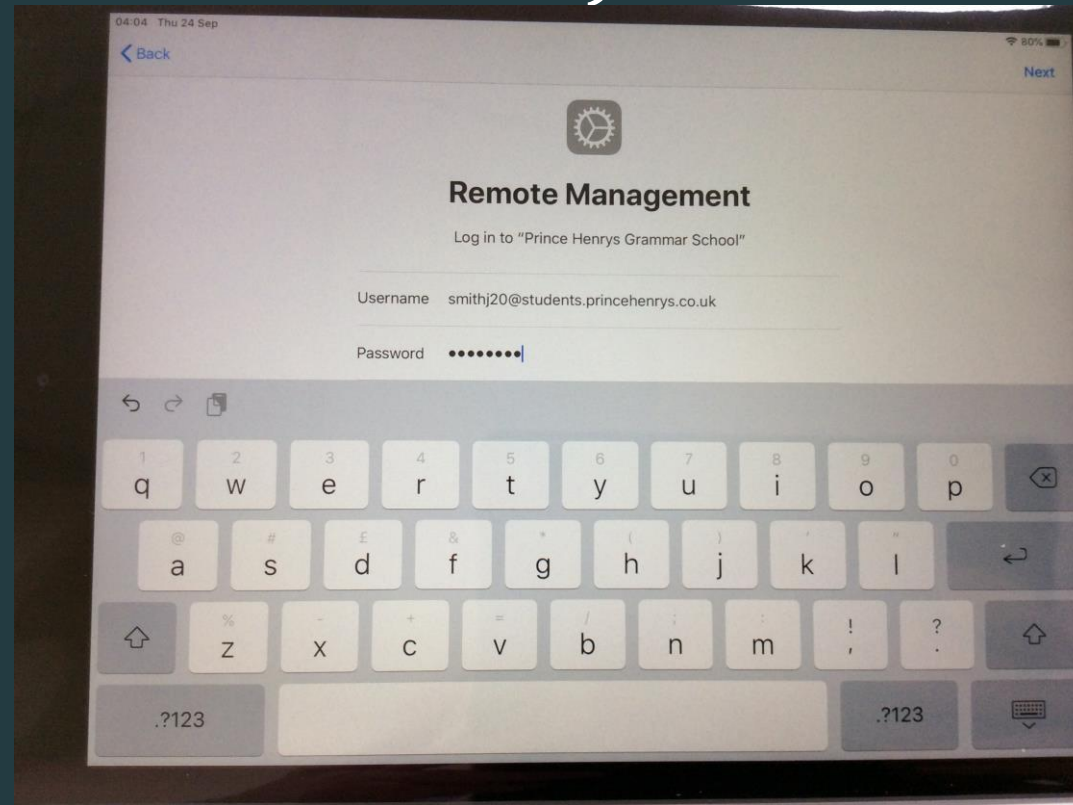

# 9. Tap 'Continue'

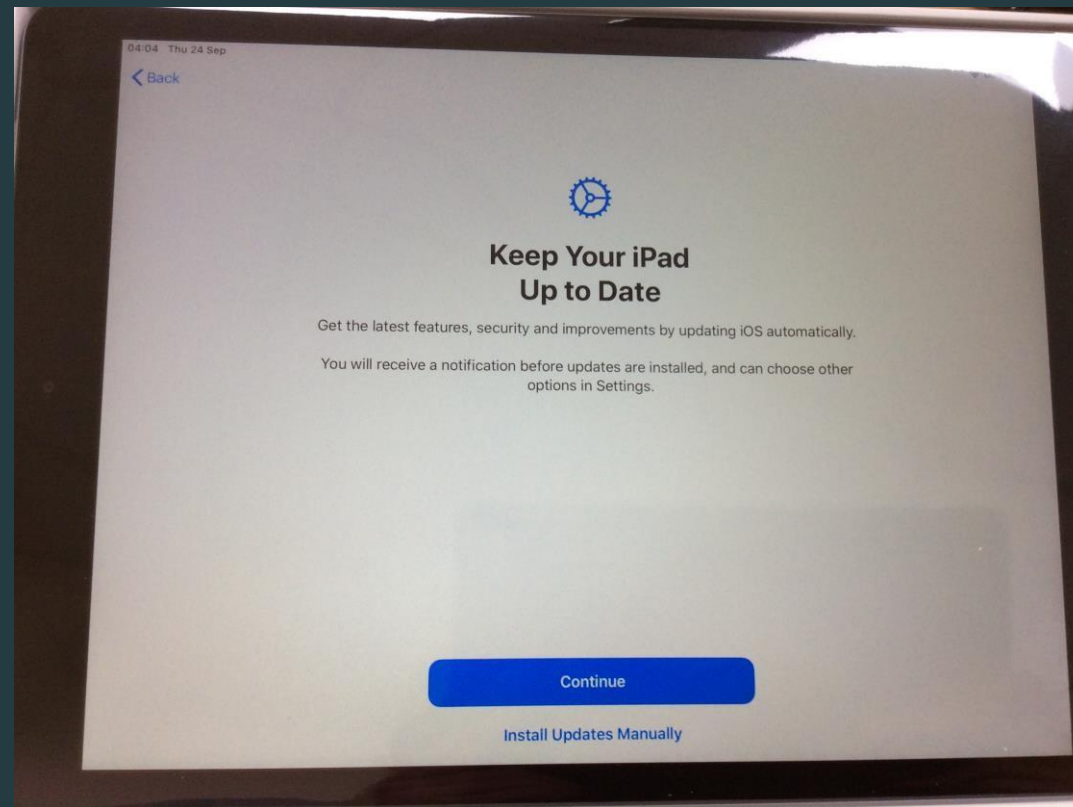

# 10. Tap 'Set Up Later in Settings'

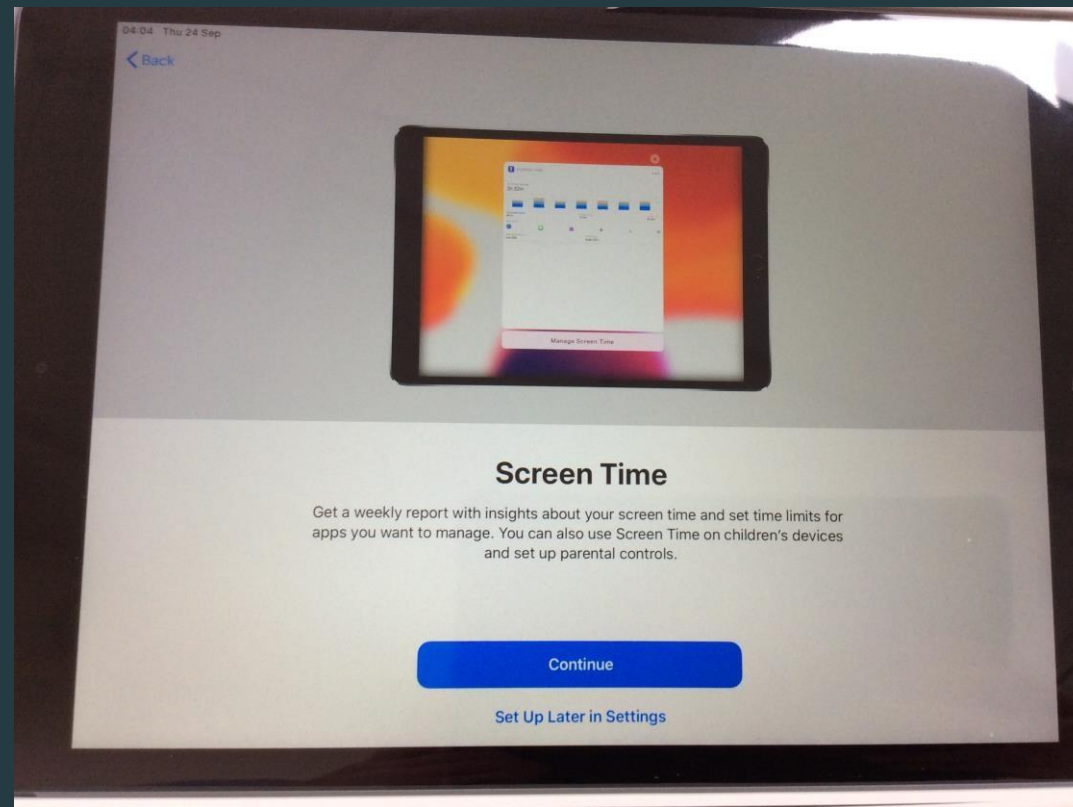

11. This is personal preference on which you choose, once you have selected one, tap 'Continue'.

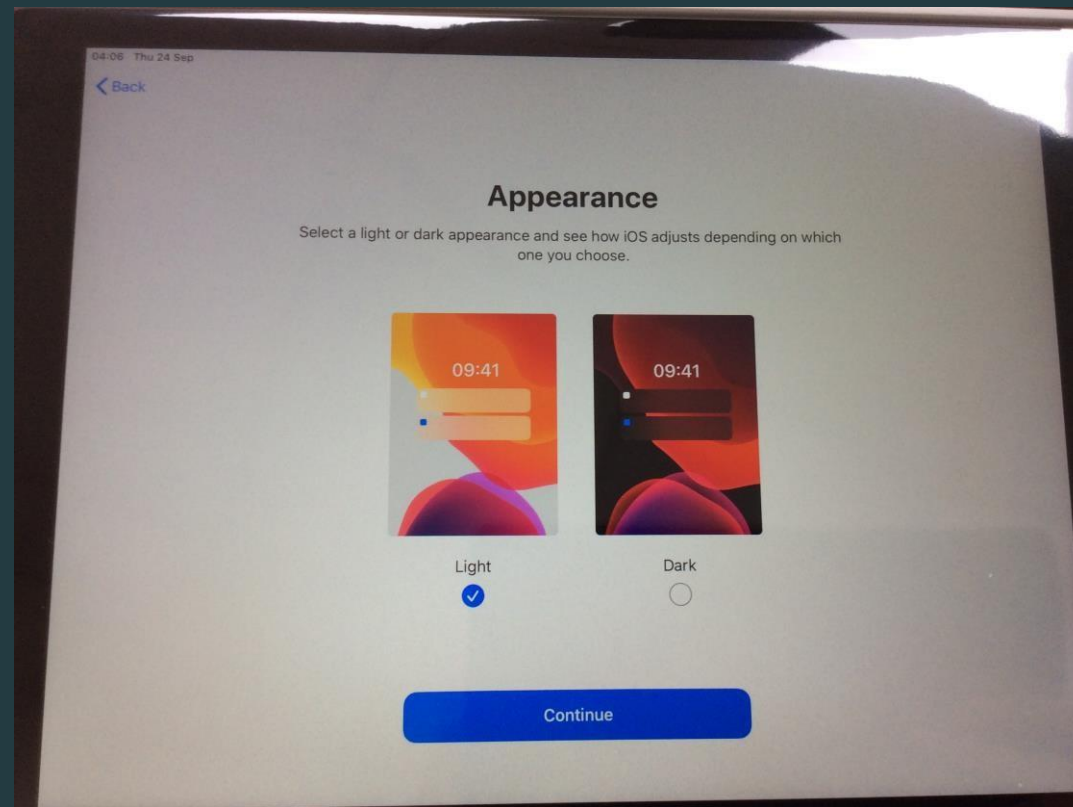

12. Keep tapping continue until you reach the screen displayed on step 13.

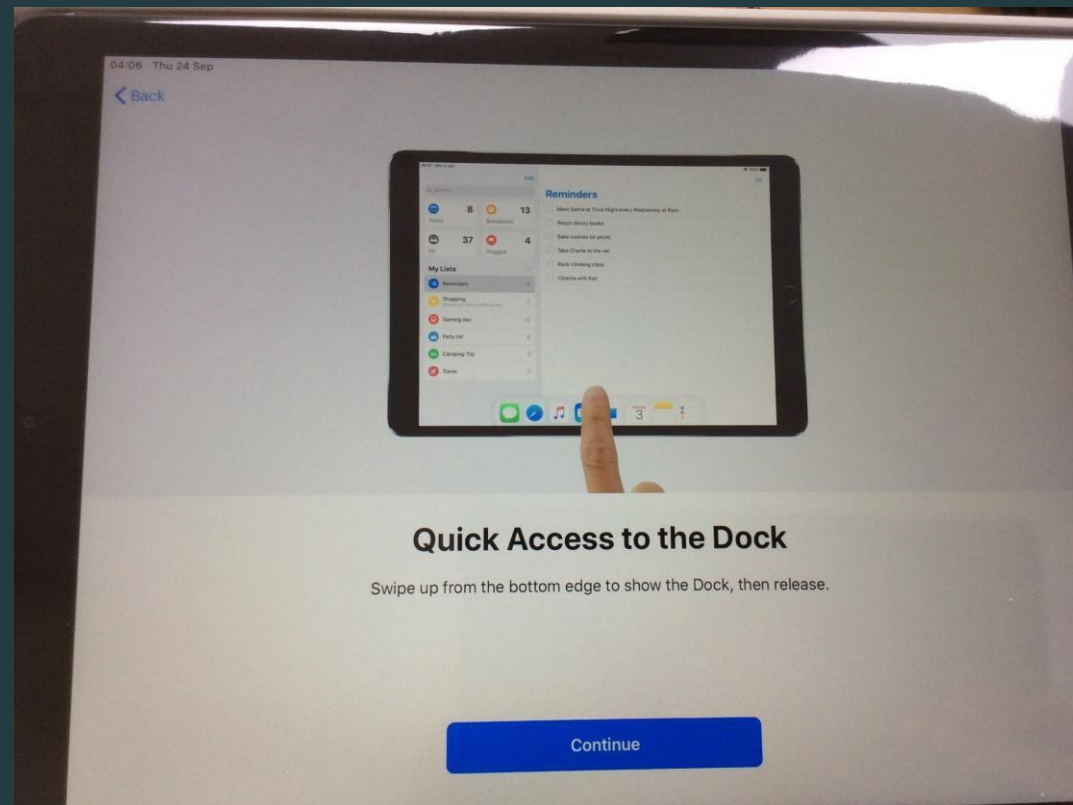

# 13. Tap 'Get Started'

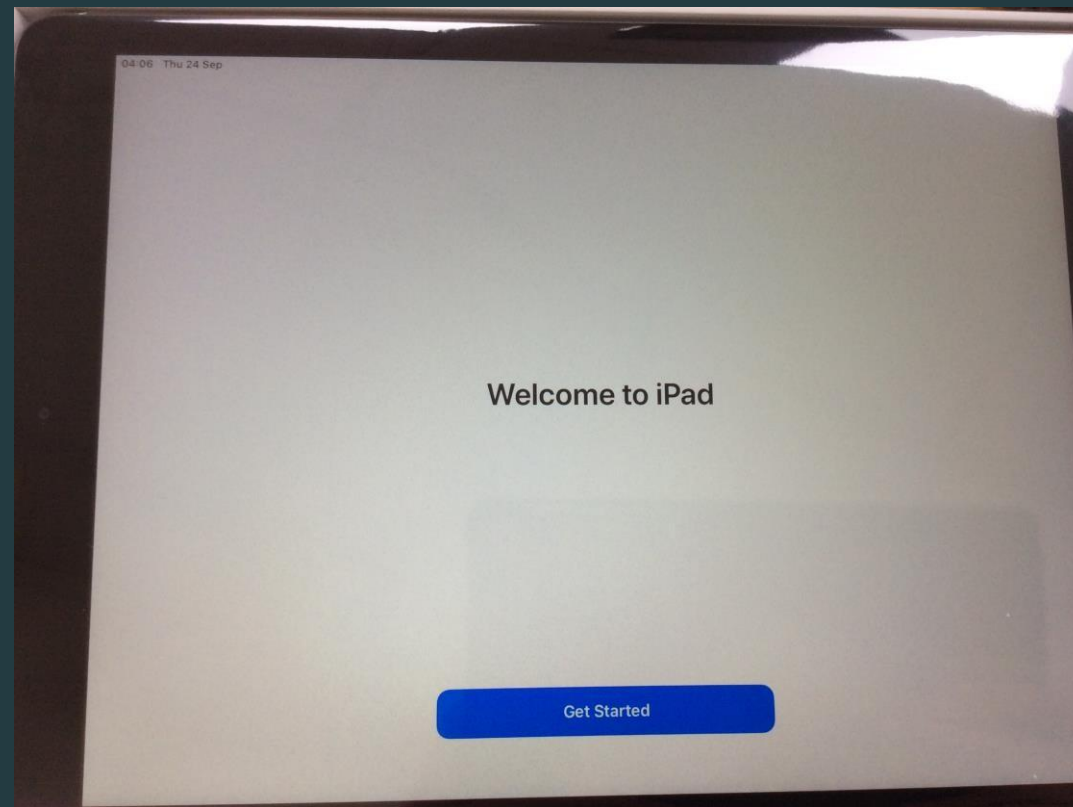

14. Tap 'Settings' and then tap 'Sign in to your iPad'.

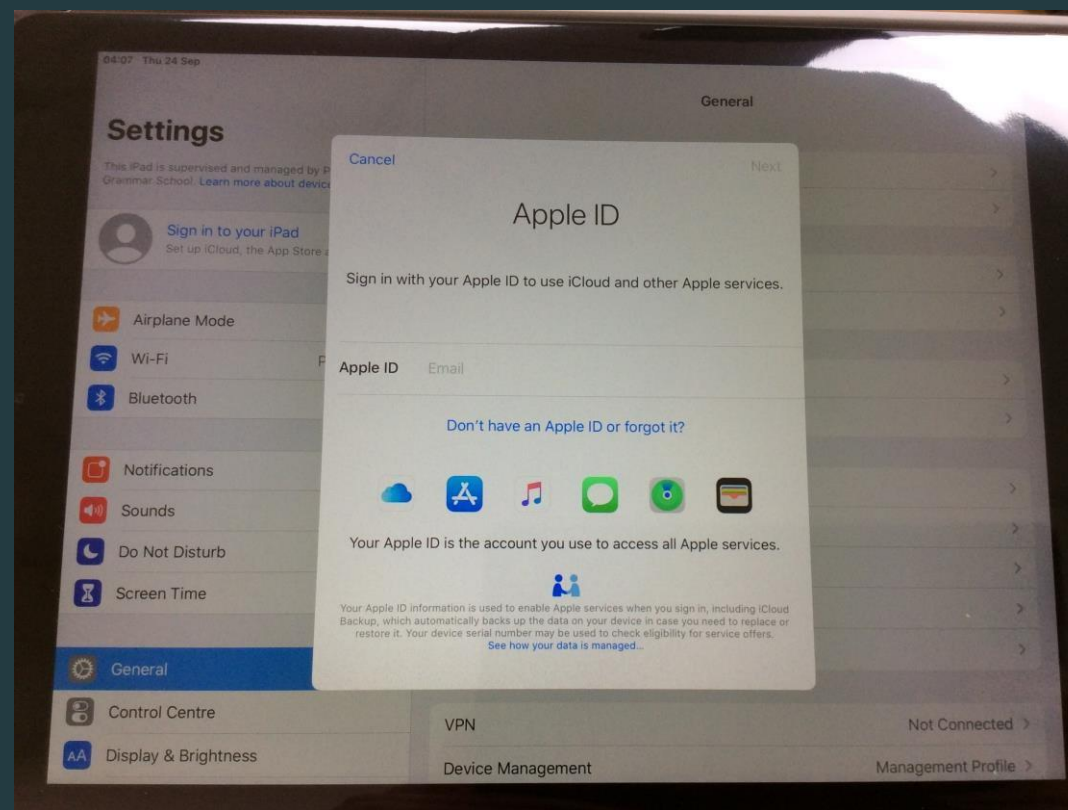



# We will next create an Apple ID.

It is fine with us you have an Apple ID that you currently use at home that you want your student to use.





# 15. Tap 'Create Apple ID'

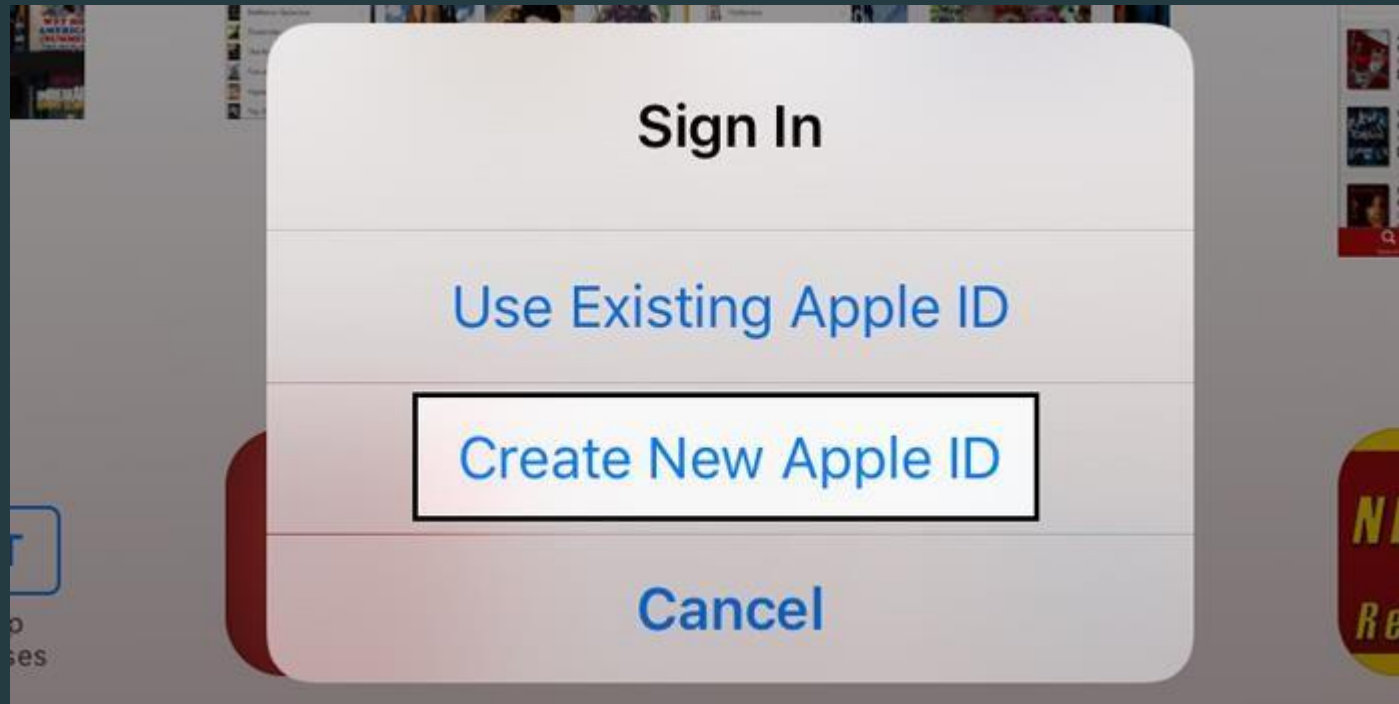

16. Use your details and not the students, we suggest this as you need to be 13 years old to create an Apple ID.

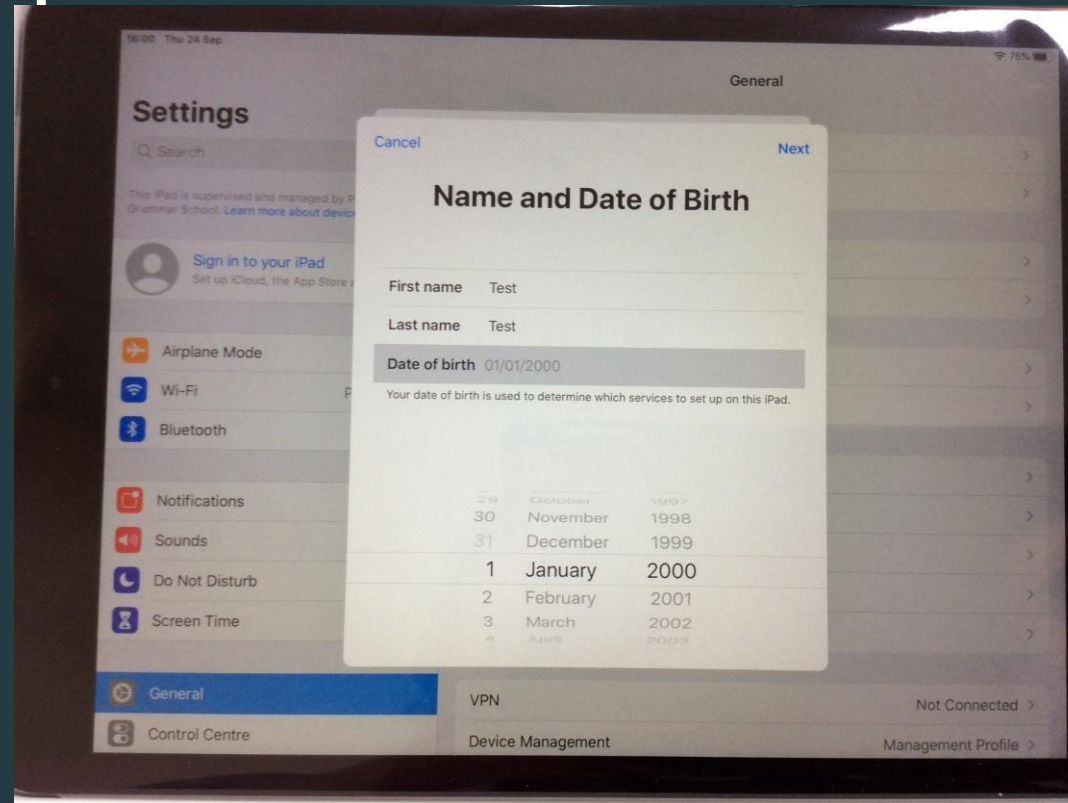

17. Enter an email, we suggest using the student's school email.

(e.g. SmithJ20@students.princehenrys.co.uk)

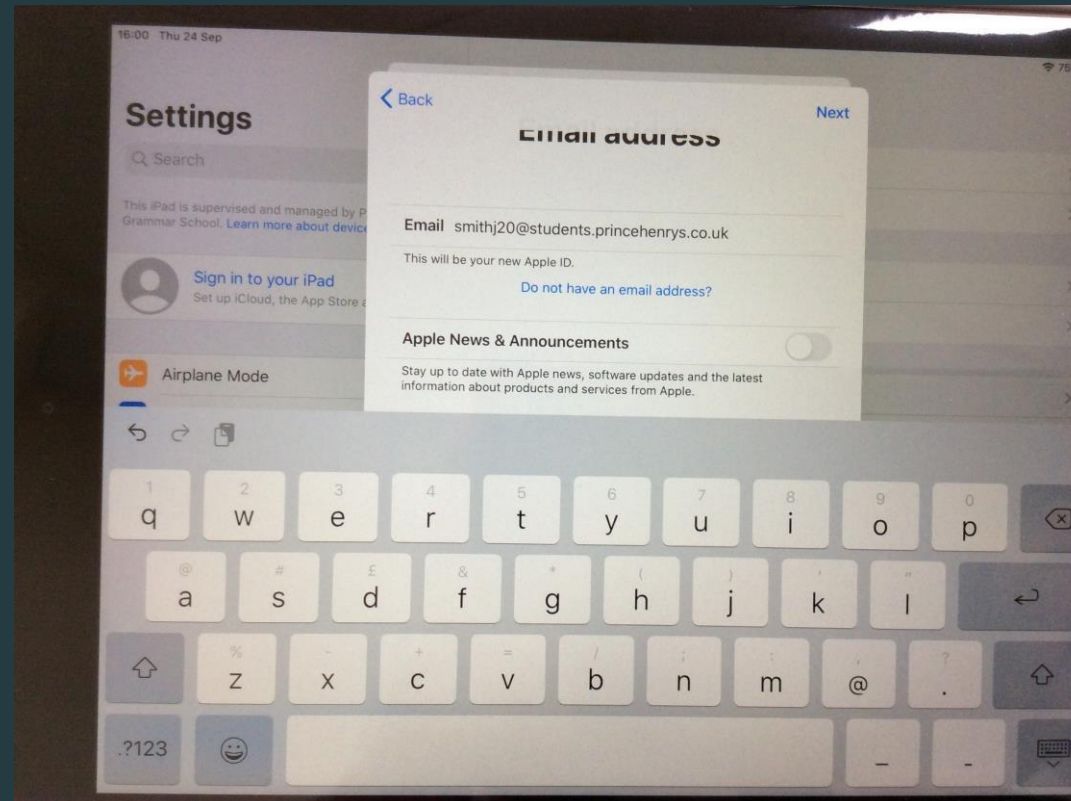

18. This is the password you will use for you Apple ID, please bear in mind this password is not the same password the student uses for the school computers.

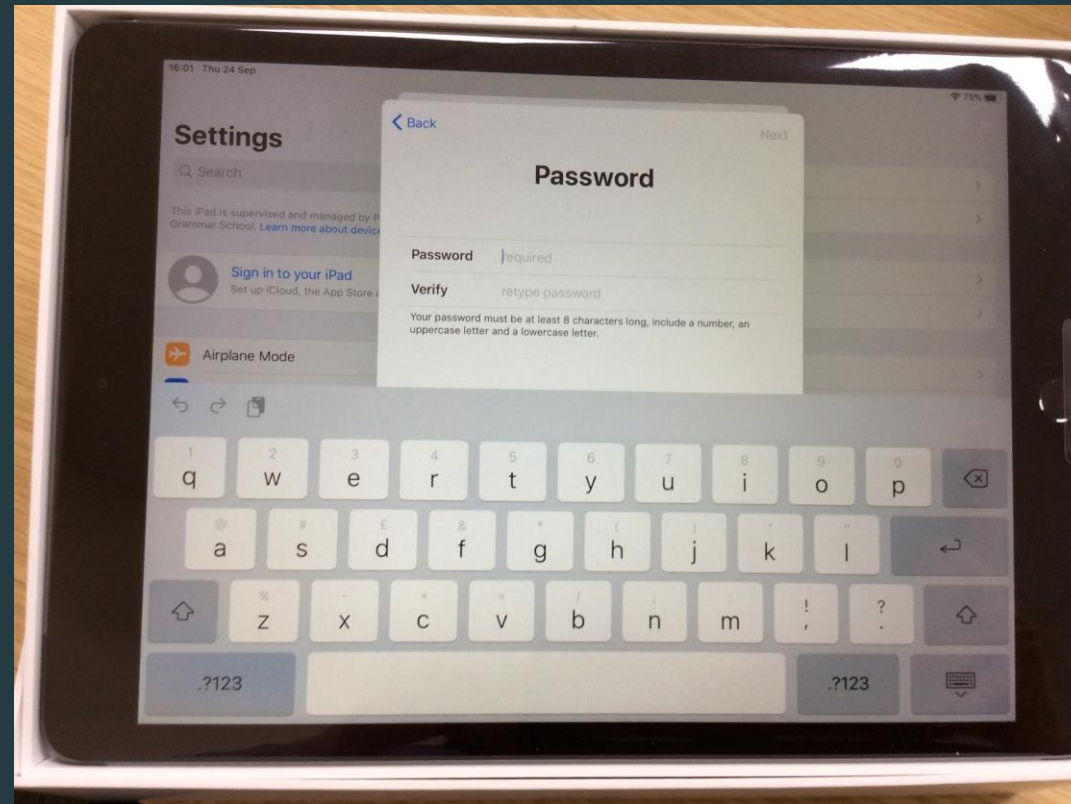

19. Type in your phone number or your student's phone number.

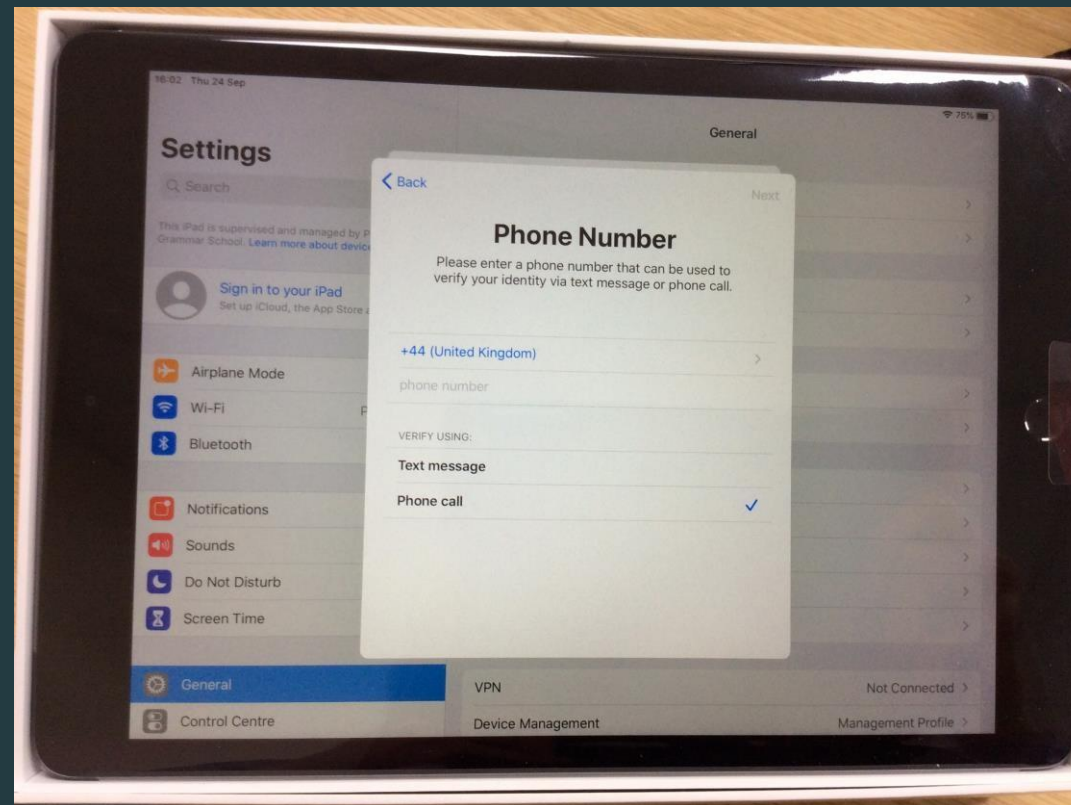

20. This is what you should see after verifying the phone number.

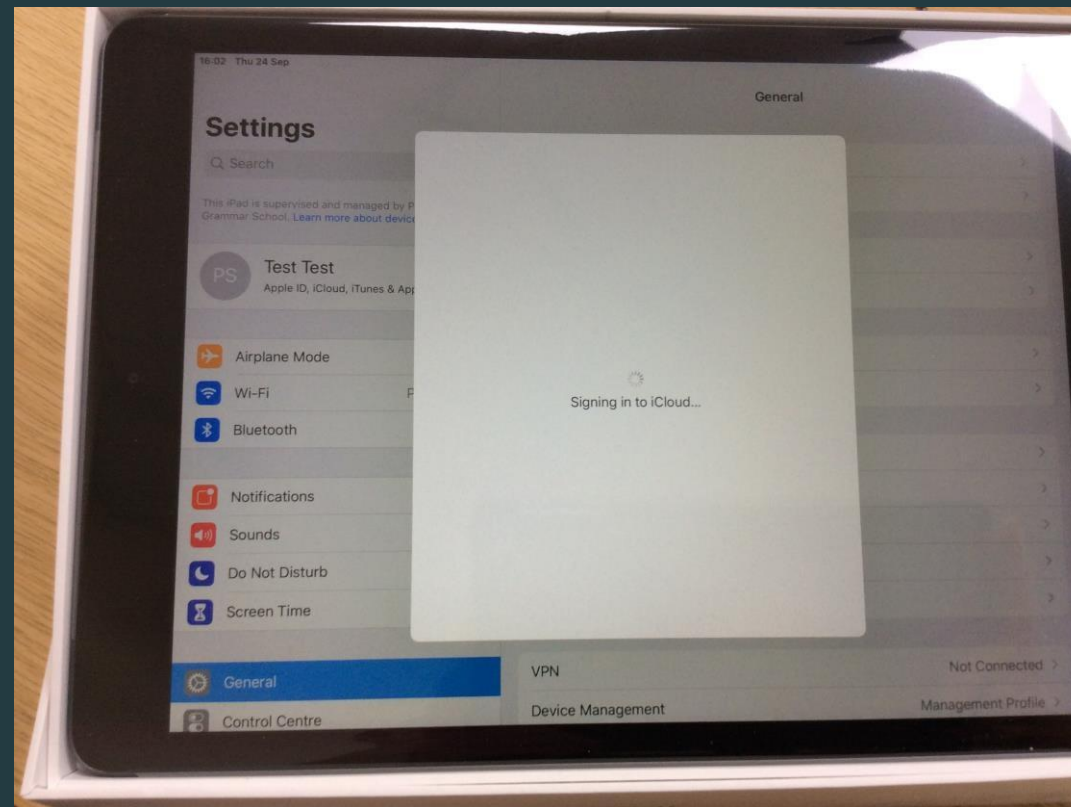

21. When you see this screen it means you have signed in.

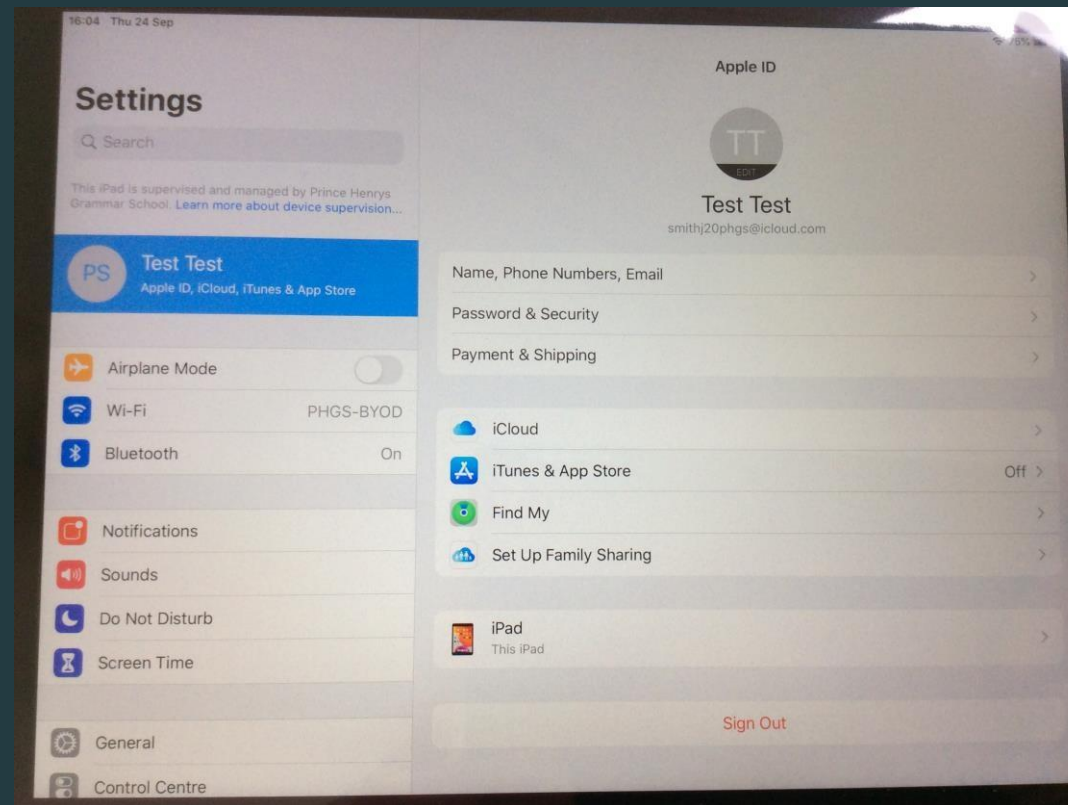

22. Press the home button and swipe right.  
Tap 'Comp Portal'





# 23. Sign in using the school email.

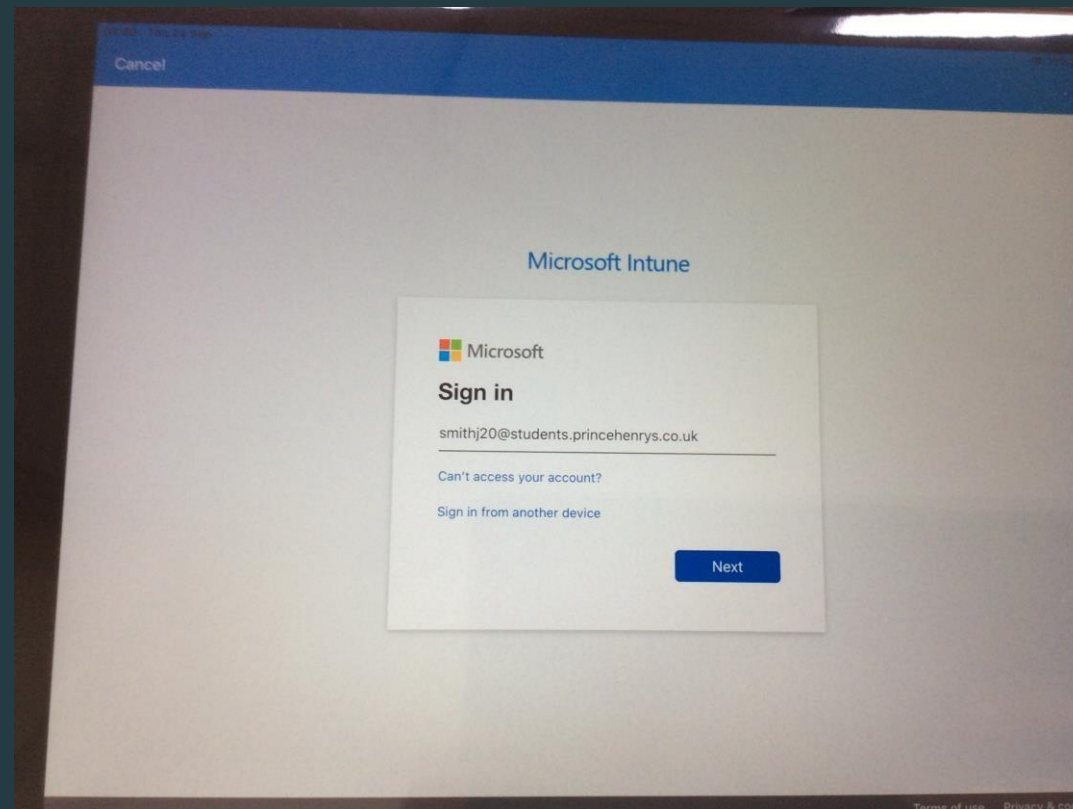

24. Enter the password (same as the computers at school).

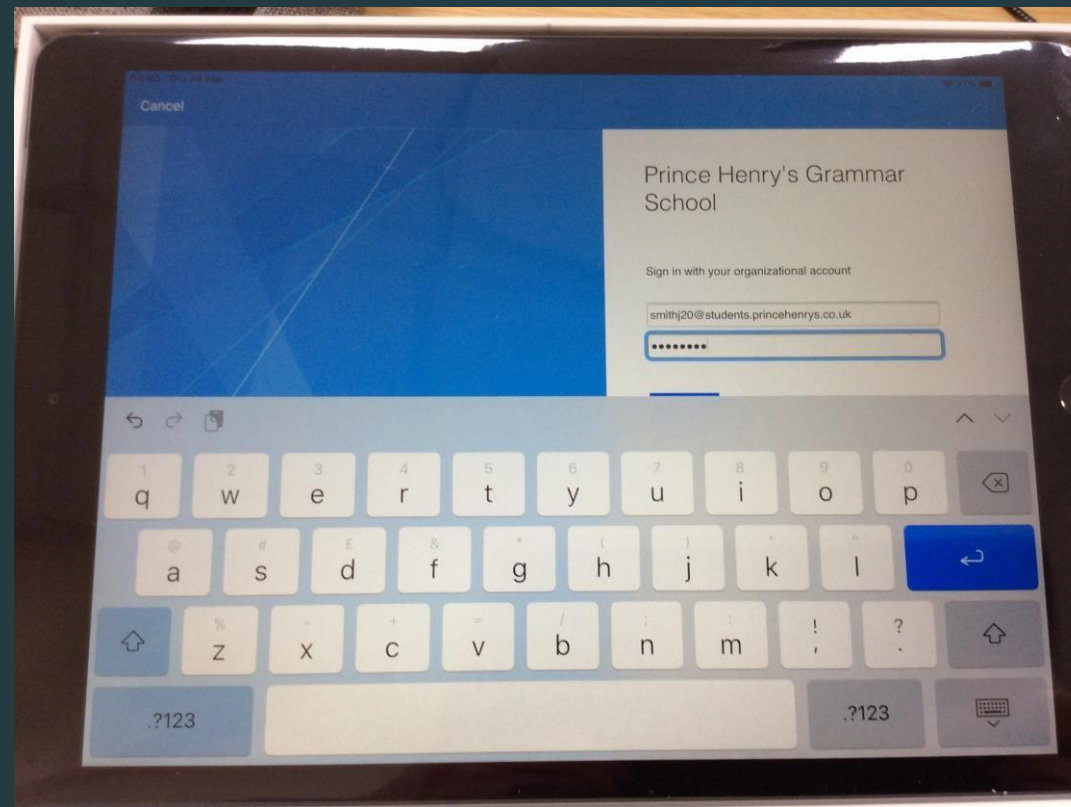

# 25. Tap 'Begin'

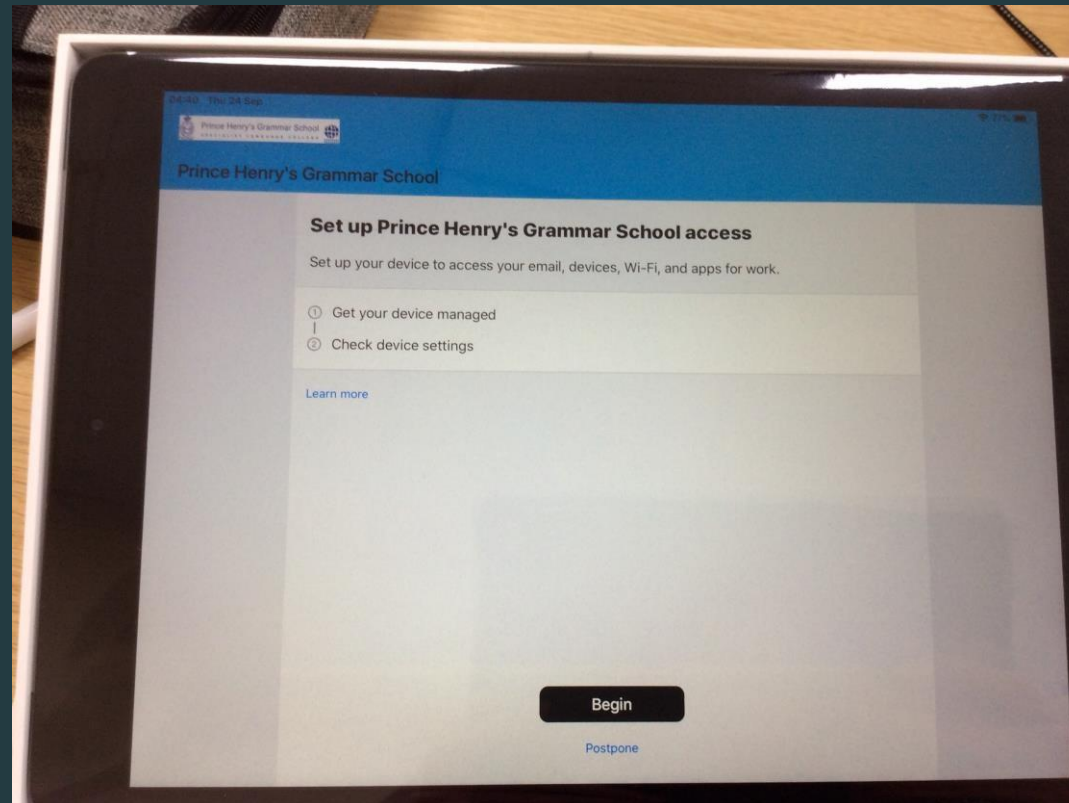

26. Tap 'iPad' and then 'Continue'

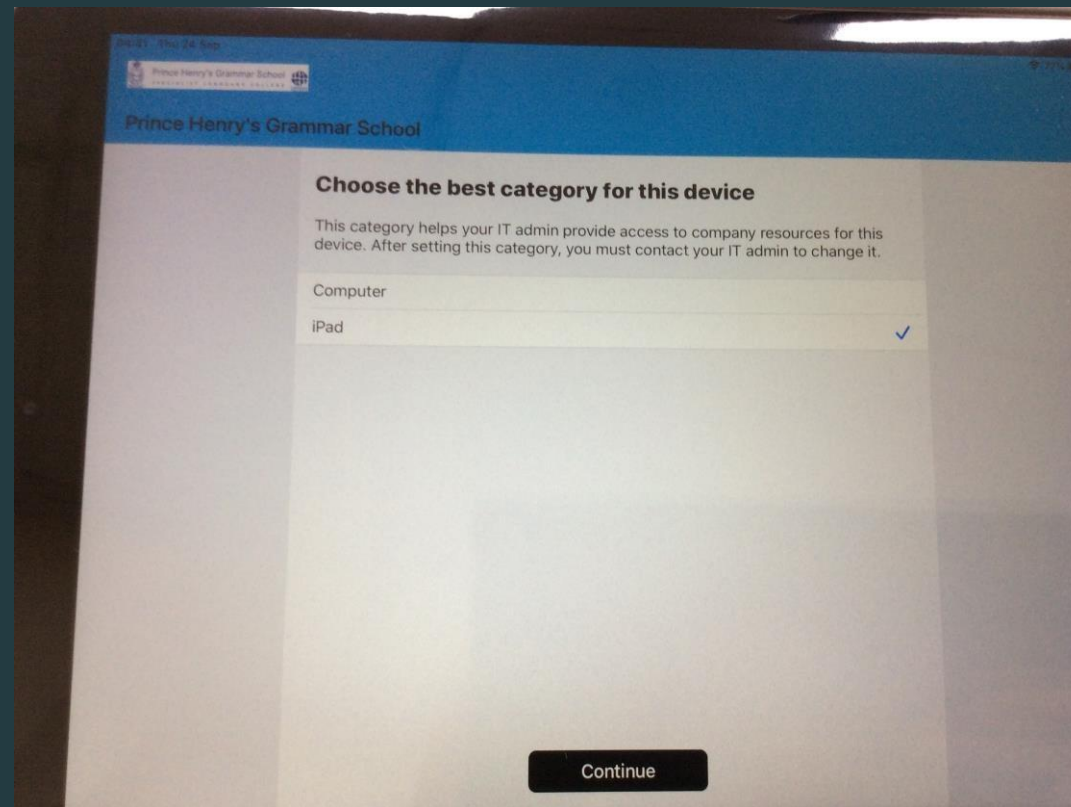

# 27. Tap 'Ok'

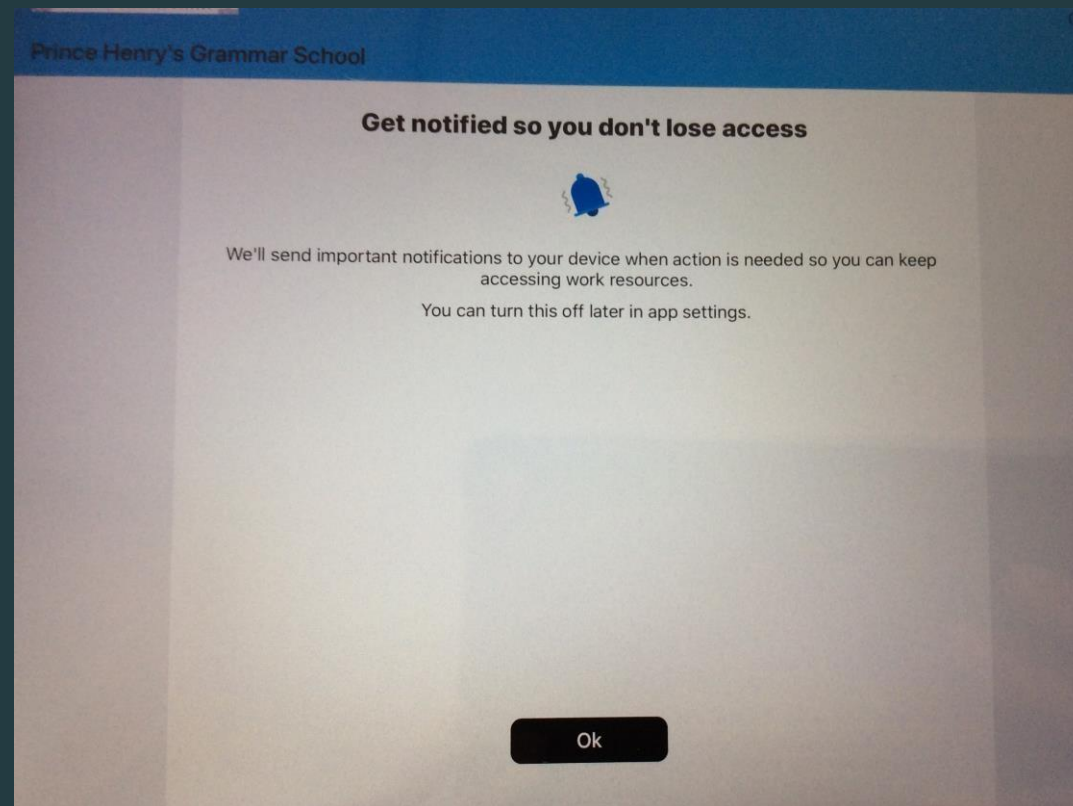

## 28. Tap 'Allow'

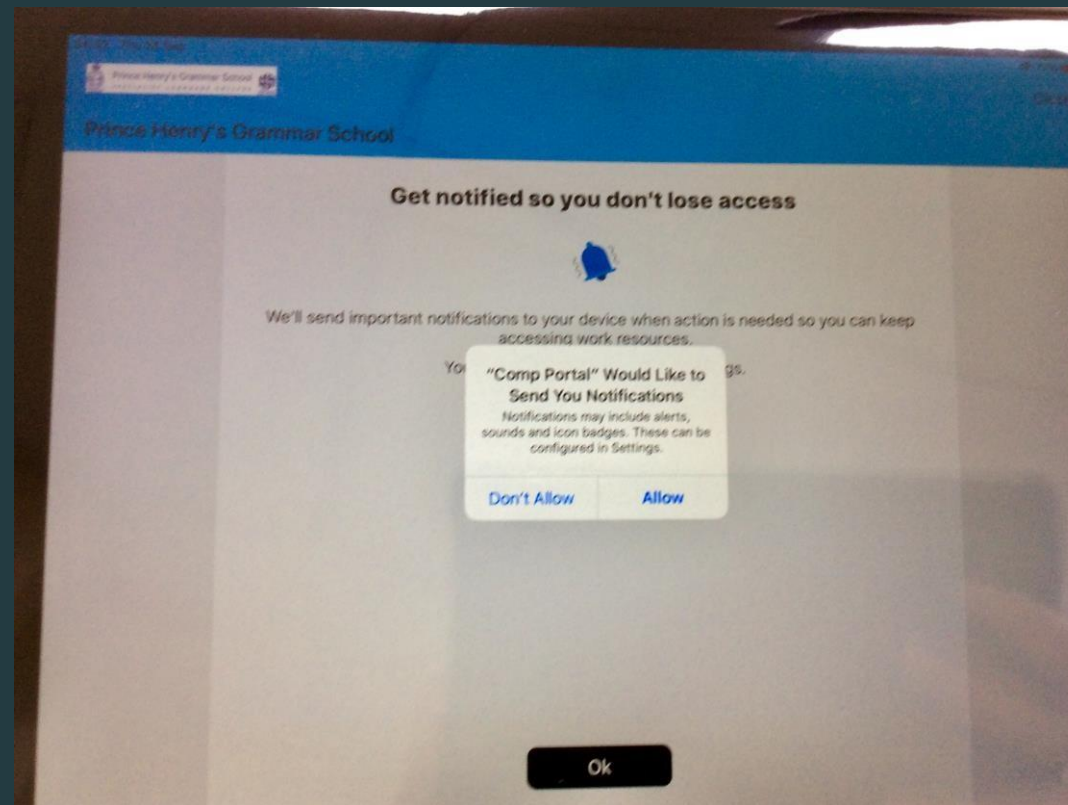



The setup is now complete.

If you need any further assistance, please  
email [itservices@princehenrys.co.uk](mailto:itservices@princehenrys.co.uk) or call 01943 855687

