

September 2025

# iPad Setup Guide

## iPad 11<sup>th</sup> Gen



Prince Henry's Grammar School  
COLLABORATIVE LEARNING TRUST



Respect ♦ Flourish ♦ Achieve

This guide is designed to assist you in setting up your iPad with ease. Please note that due to periodic updates made by Apple, certain steps in the setup process may differ in appearance or order.

1. Press the Home Button.



2. Tap 'English'

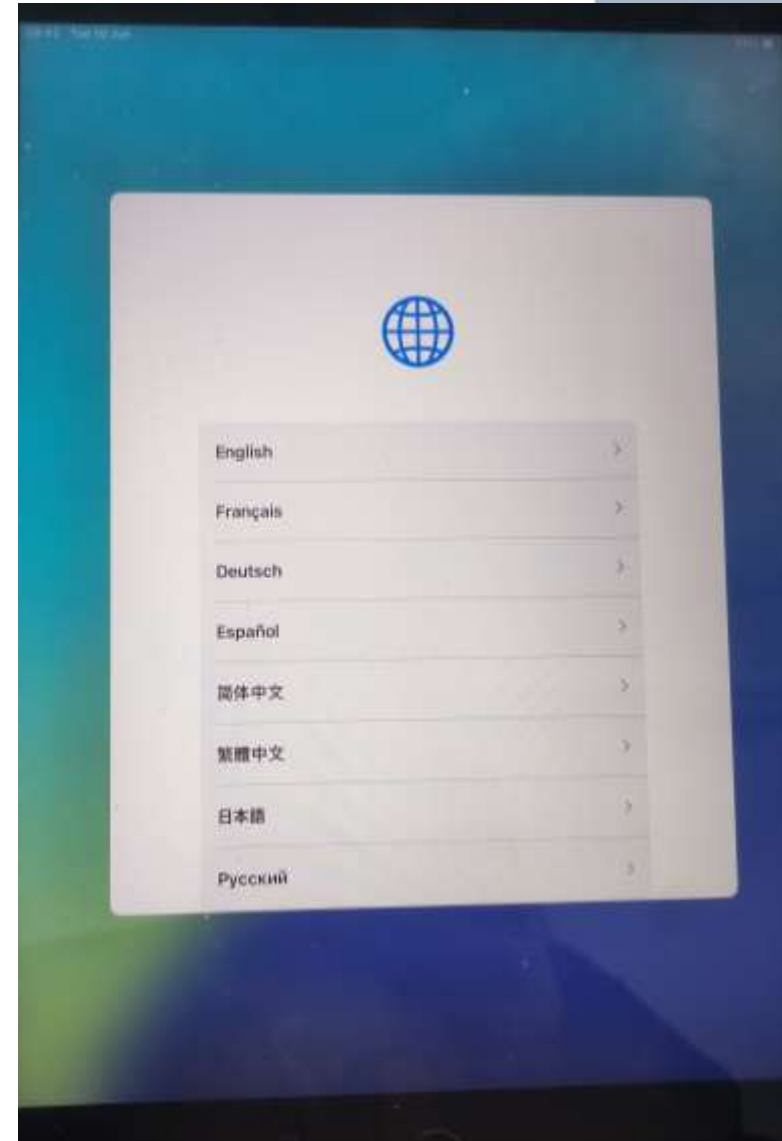

Respect ♦ Flourish ♦ Achieve



3. Tap 'United Kingdom'



4. Choose the text size and click Continue.

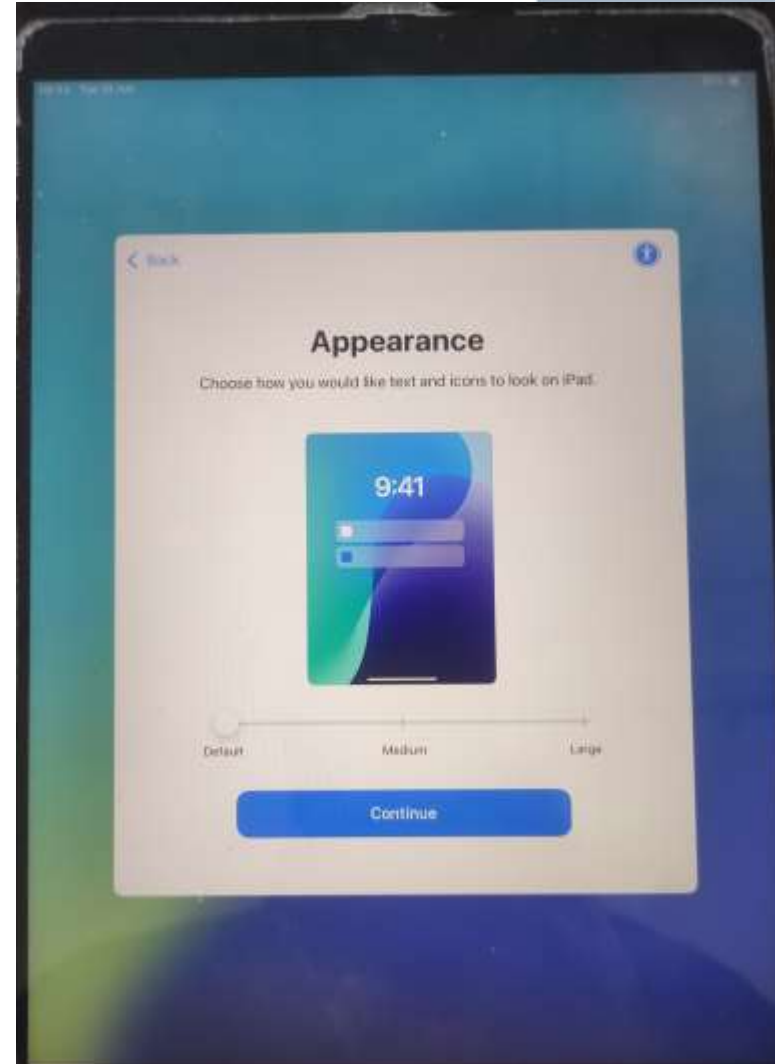

5. Select the Wifi you want to connect to and enter your credentials.

If in School, it will be the “PHGS-BYOD” network, and you will enter the first part of your school email address, which is everything before the @ sign. You then need to enter your school computer/office 365 password.

If in school, it will ask you to “trust” the network. Click Trust.

Once connected, click Continue.

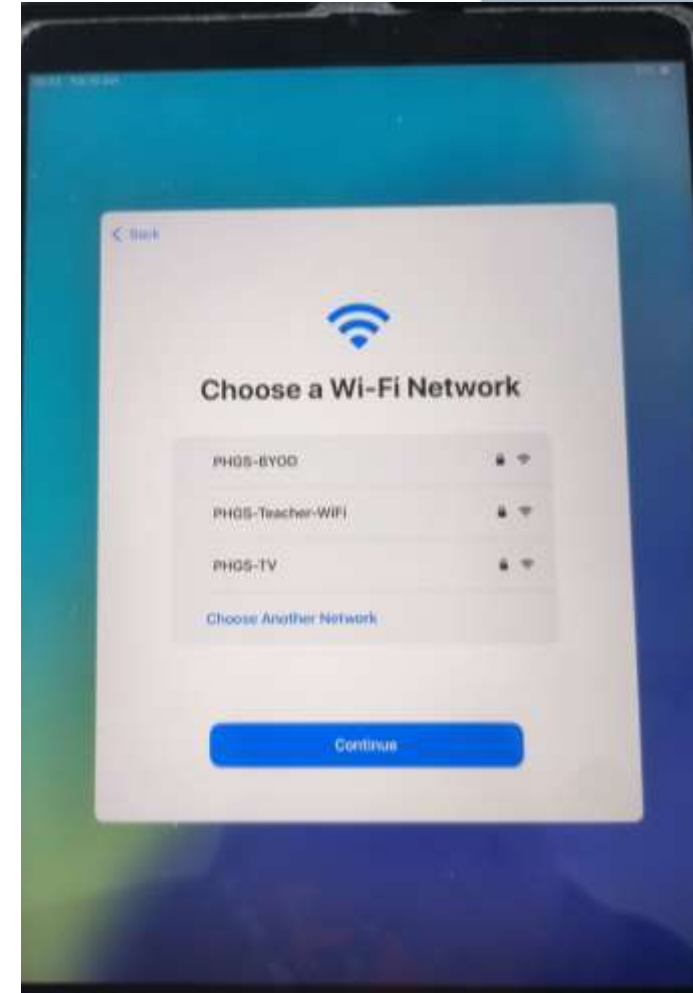

6. Wait for the iPad to retrieve the configuration.



7. Click Continue to agree to the terms and conditions.

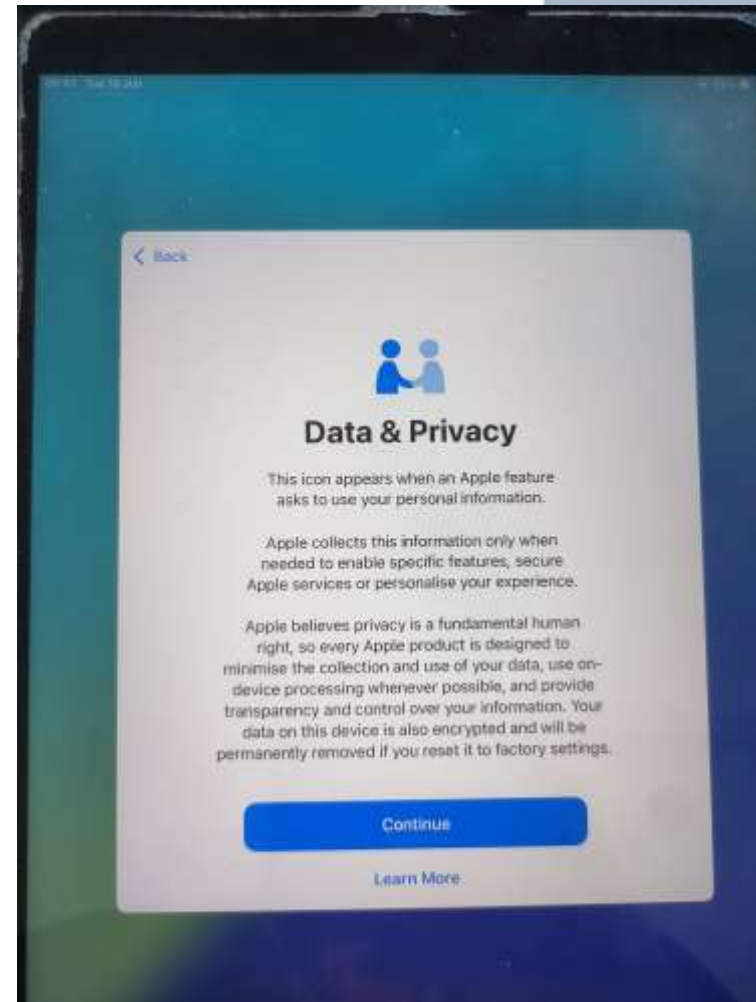

8. Click Enrol to agree to remote management.

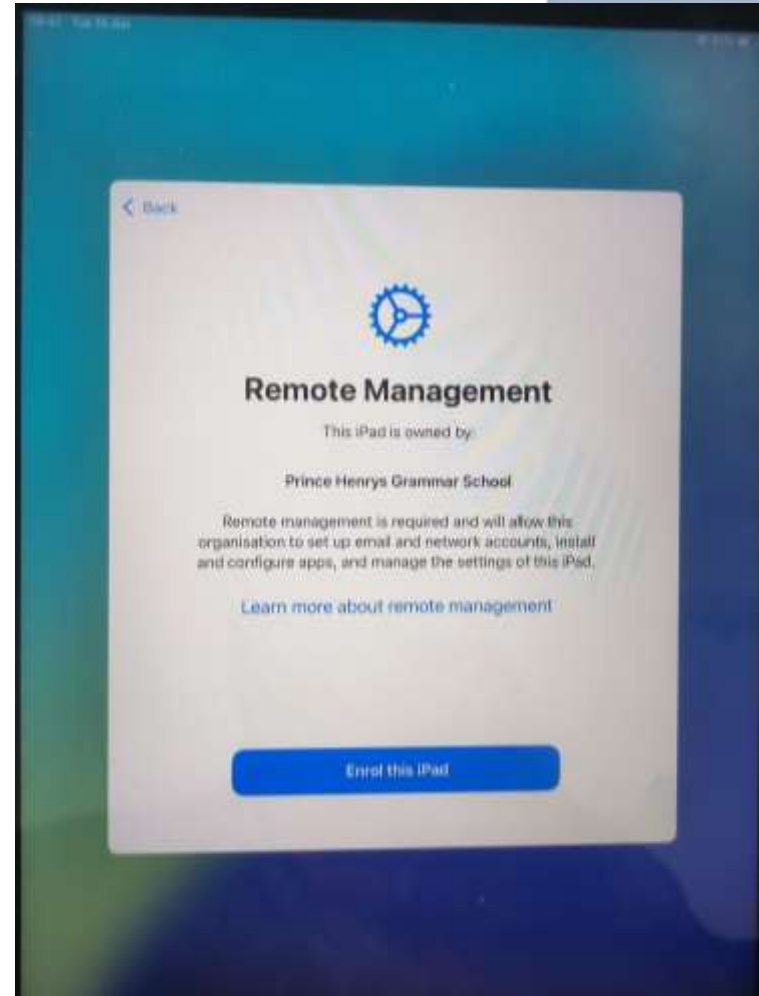

9. Type in your student's email address and password. (The same password they use for the computers at school.)

If you are a Year 7 student, it will be in the following format:

\*\*\*\*@25.princehenrys.co.uk

If you are not a Year 7 student it will be formatted as follows:

\*\*\*\*@students.princehenrys.co.uk

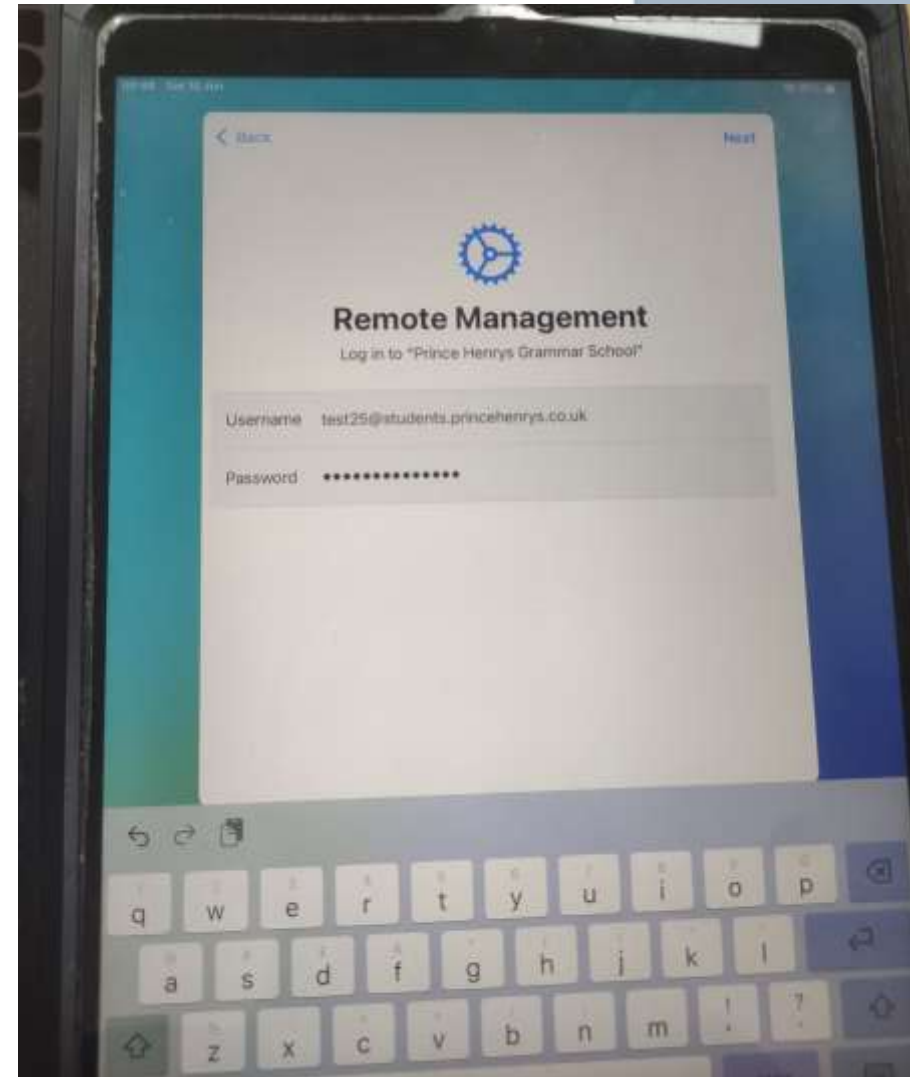

## 10. Tap Continue.

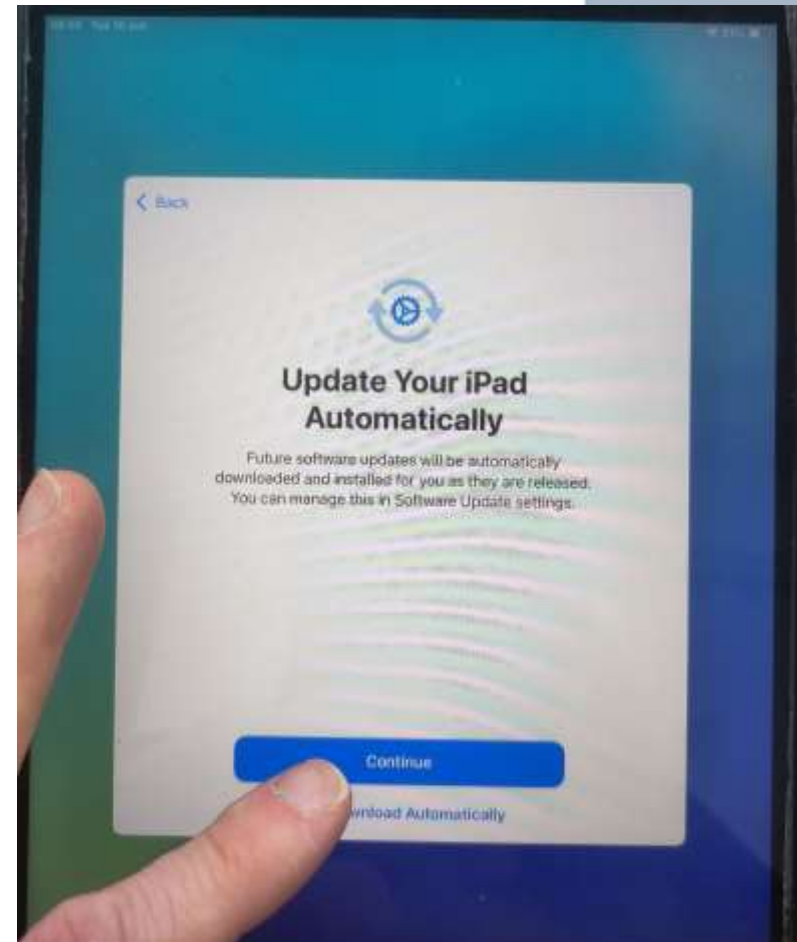

## 11. Tap Continue.

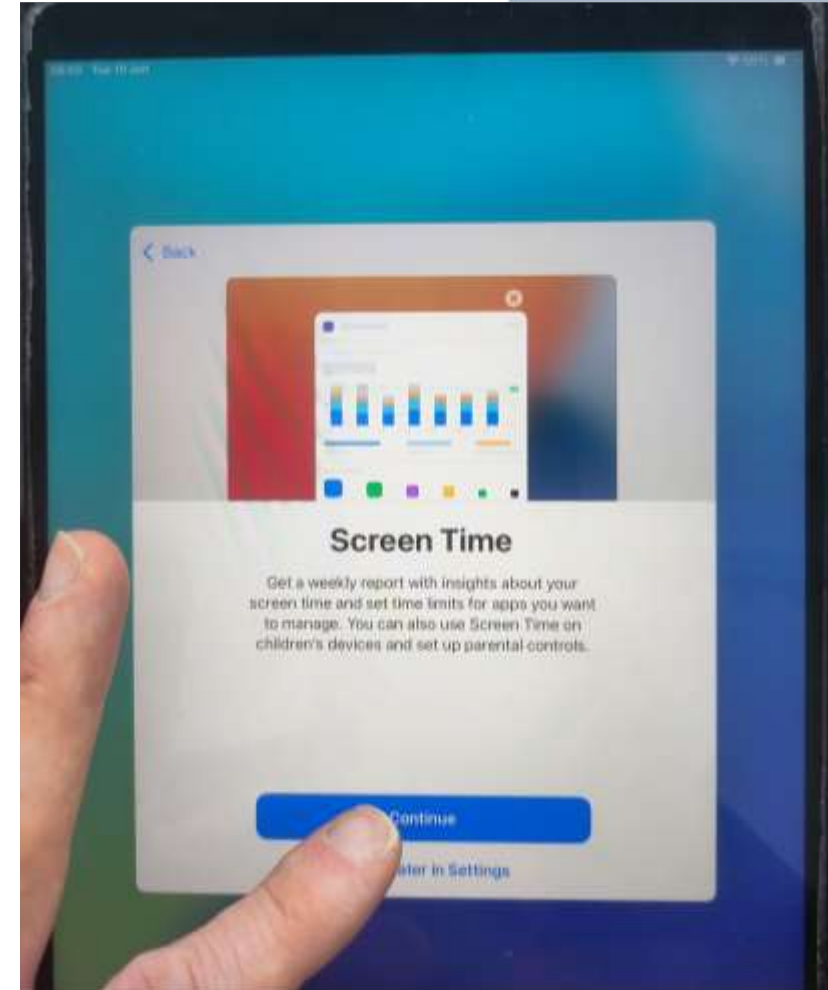

12. Select your preference, and Tap Continue.

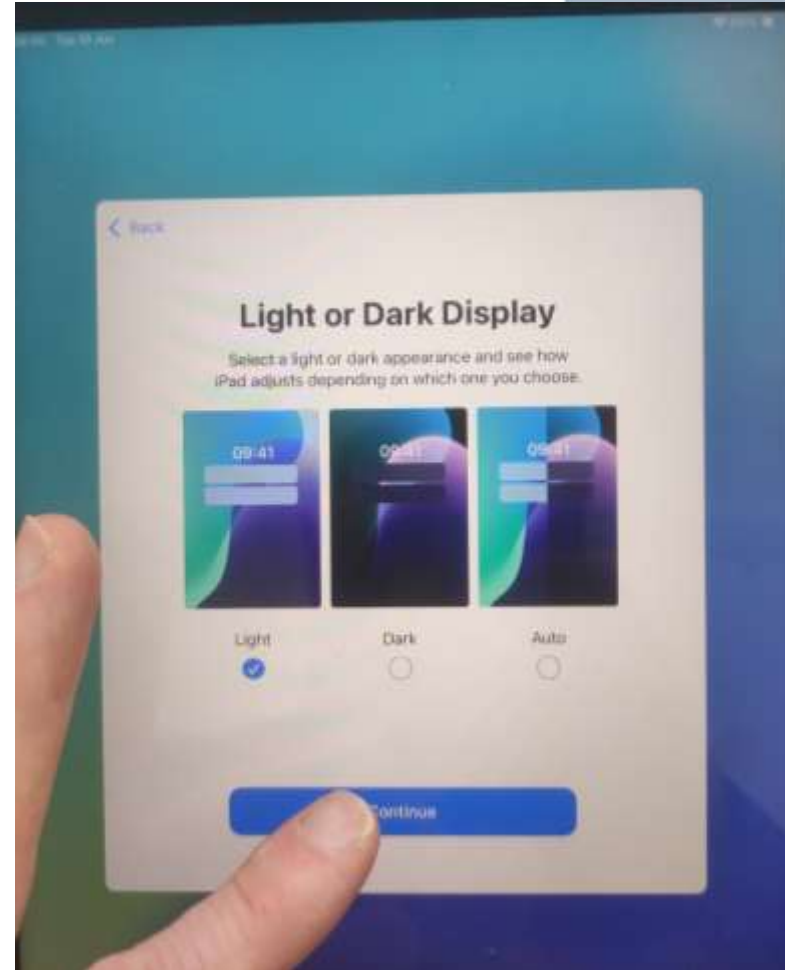

## 13. Tap Get Started.

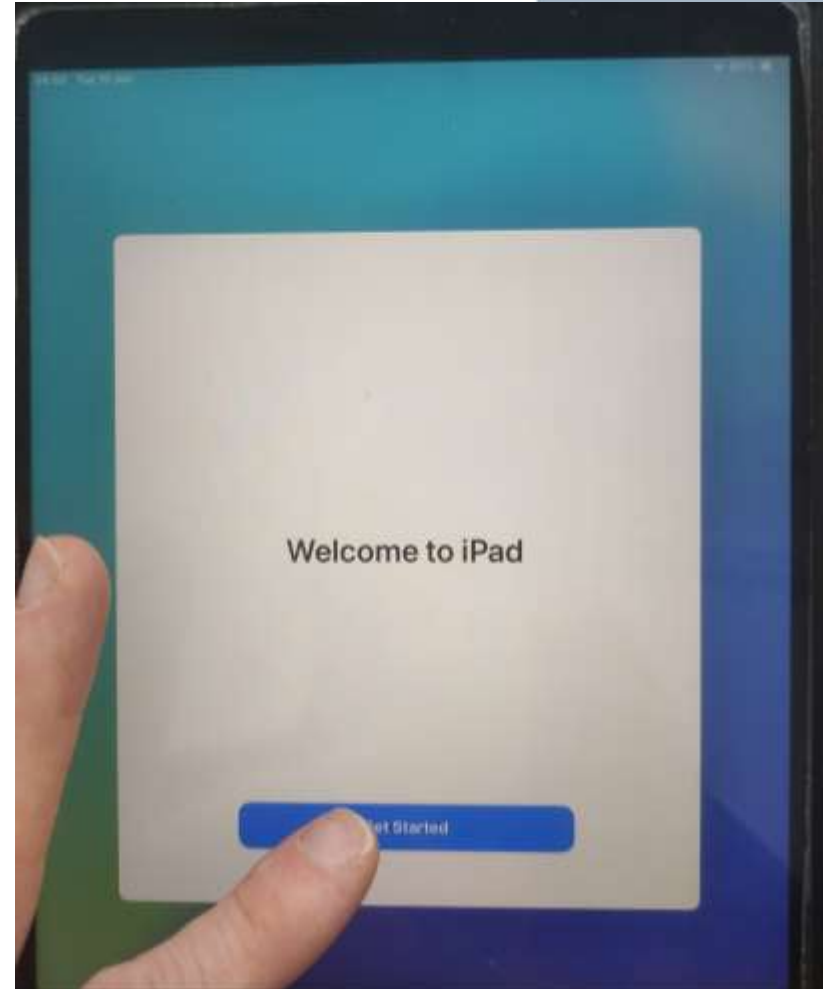

14. If Edit Home Screen appears tap Dismiss

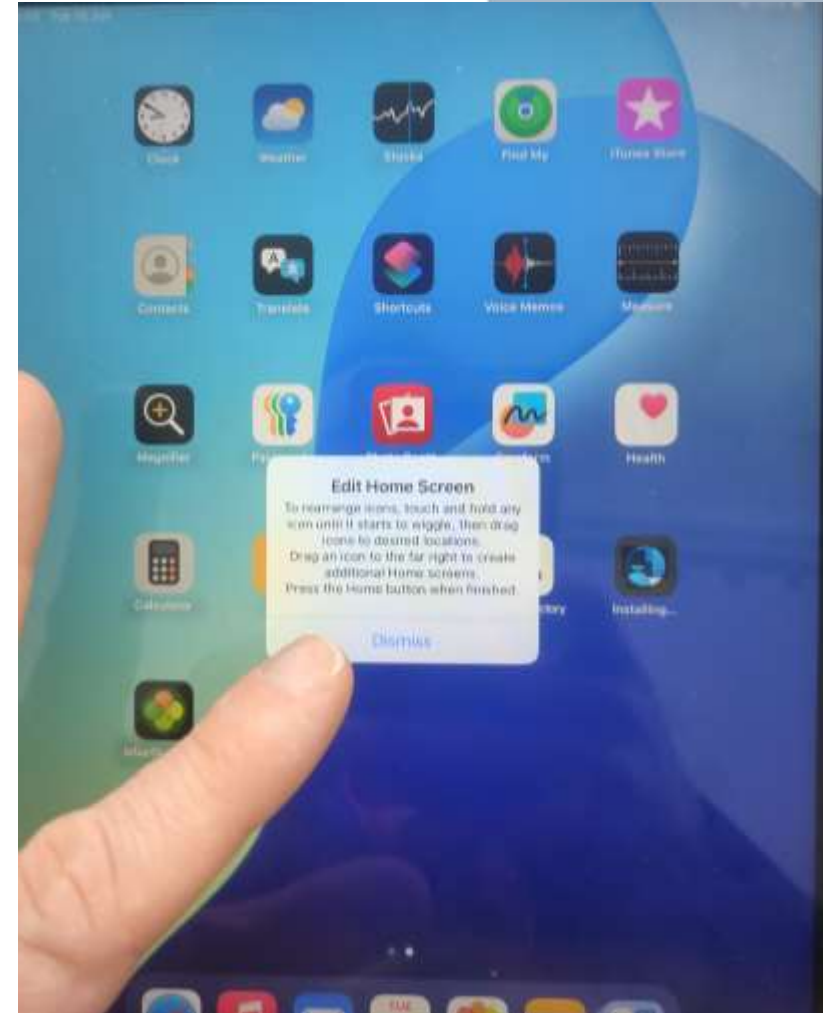

15. If Passcode Requirement box appears set a passcode or you will be continually asked to set a passcode.

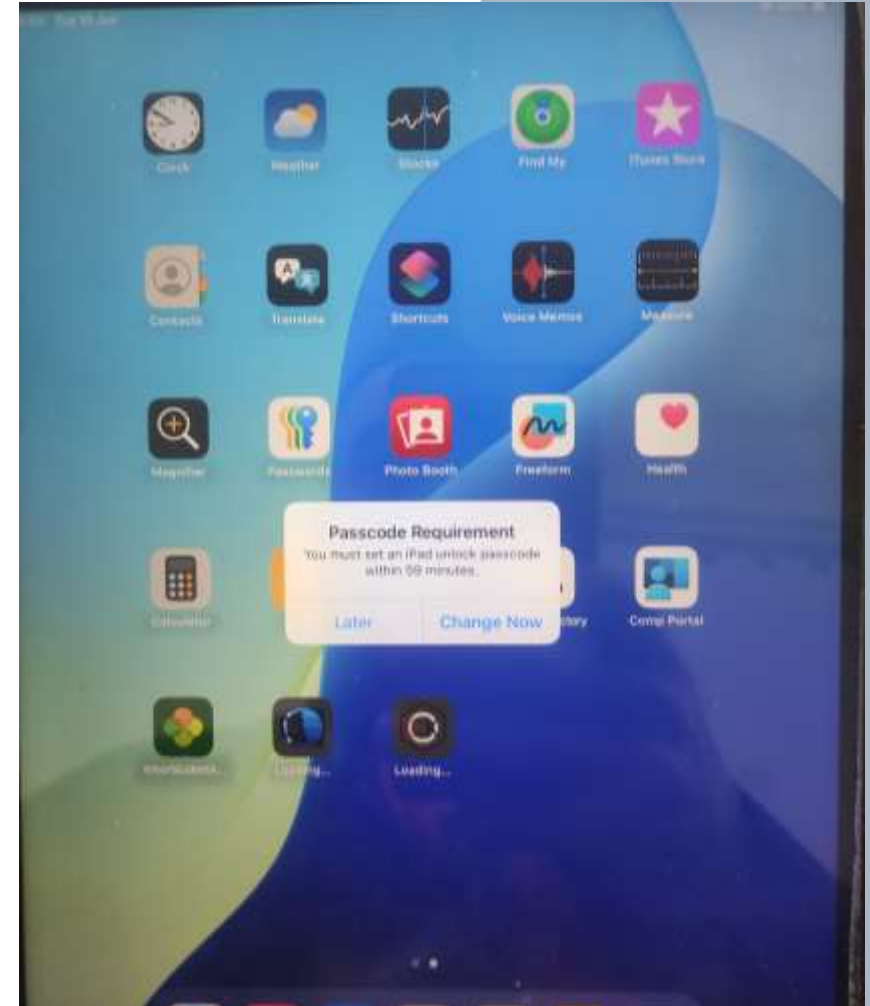

## 16. Navigate to Settings



17. Click the Apple Account box, underneath the search bar, TOP left in Settings.  
Then, click sign in manually.



18. Enter your student email address.

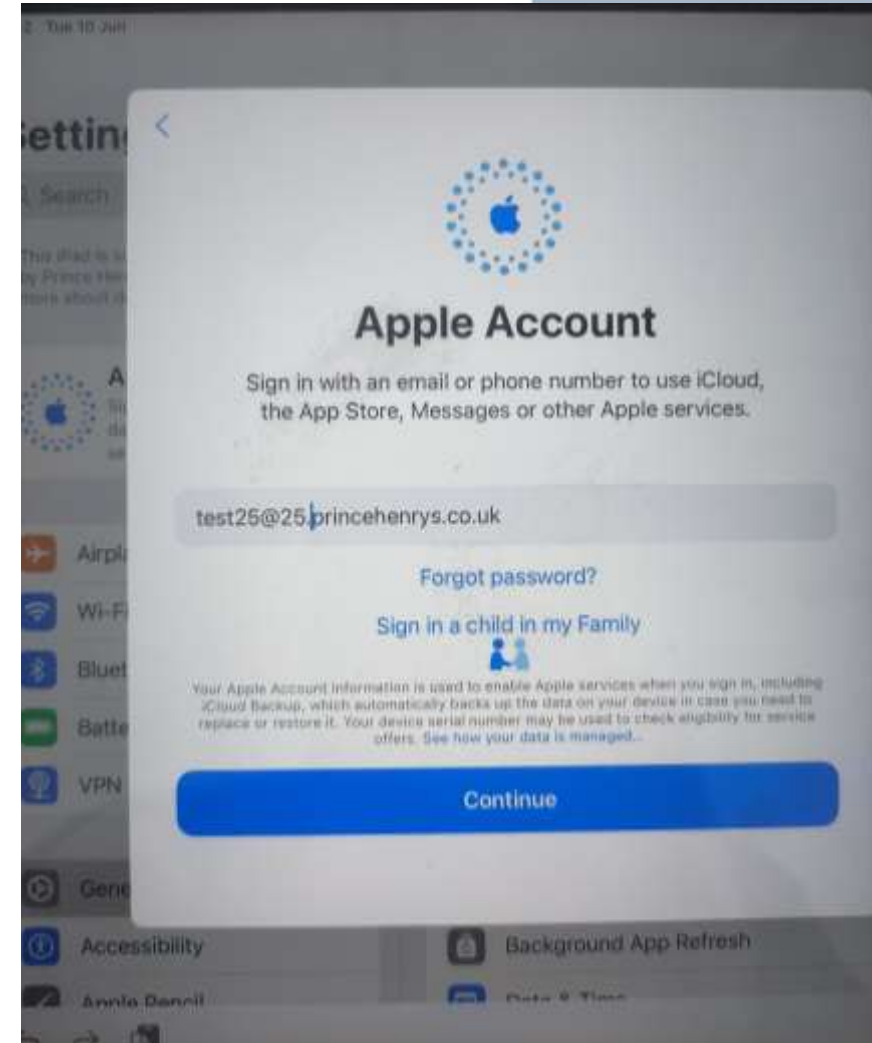

19. Click Continue.

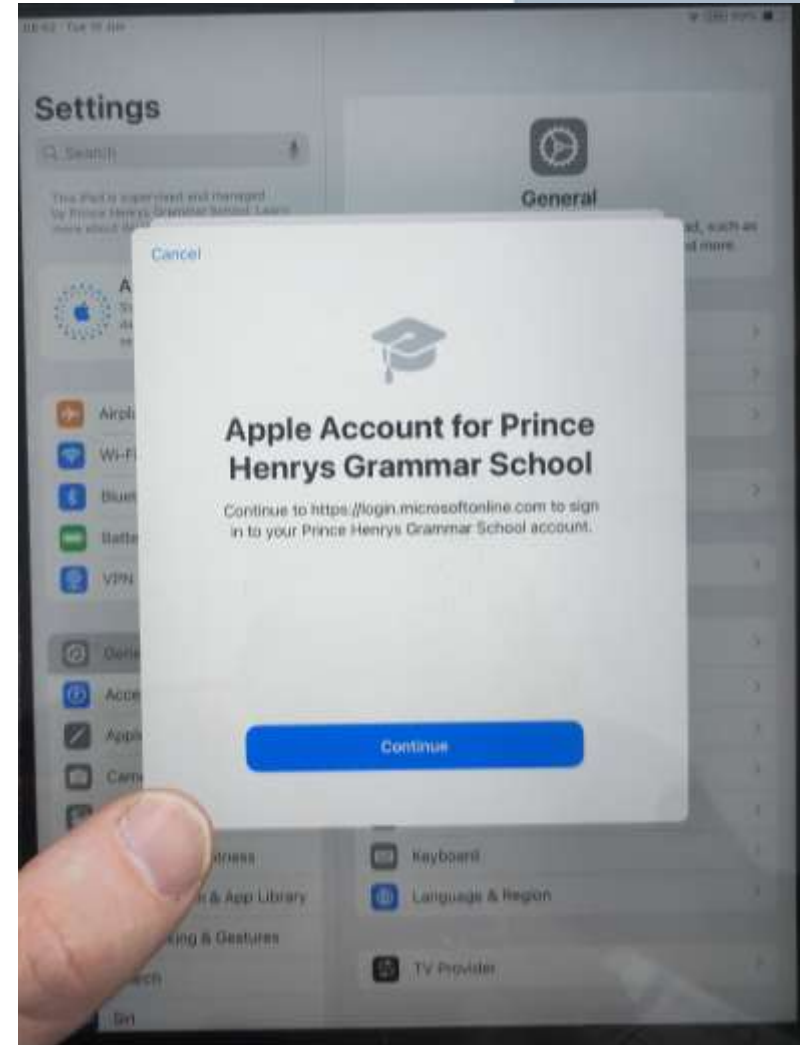

20. Enter your school computer/office 365 password.

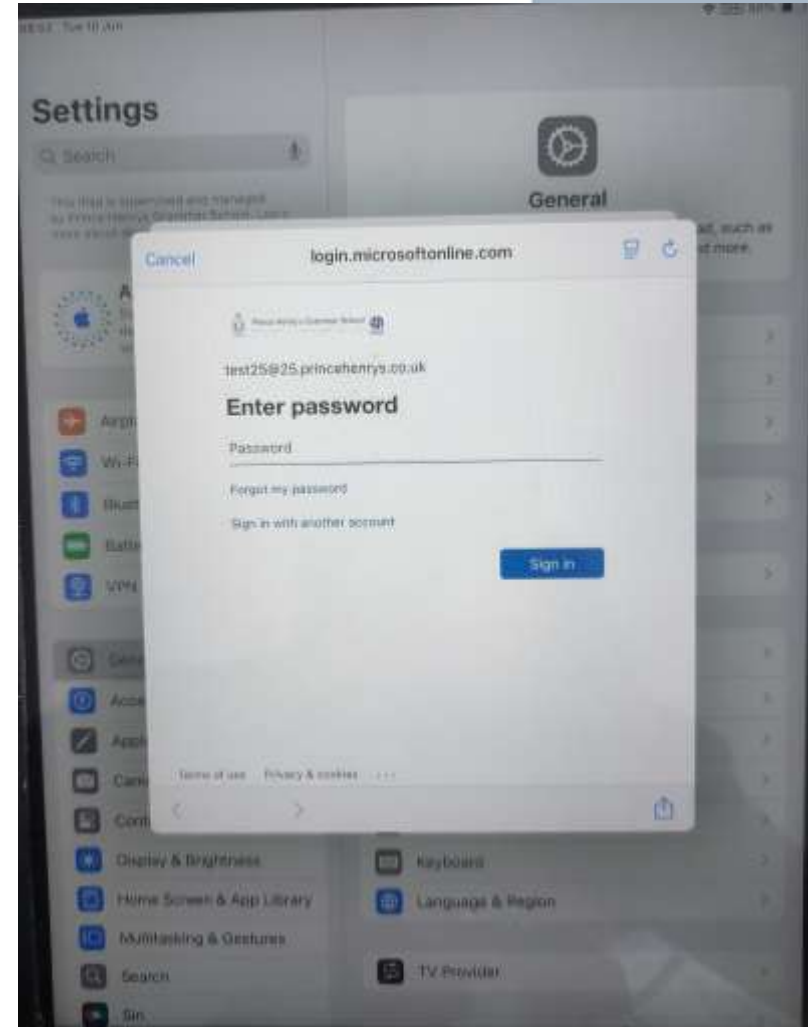

21. Click Save Password.

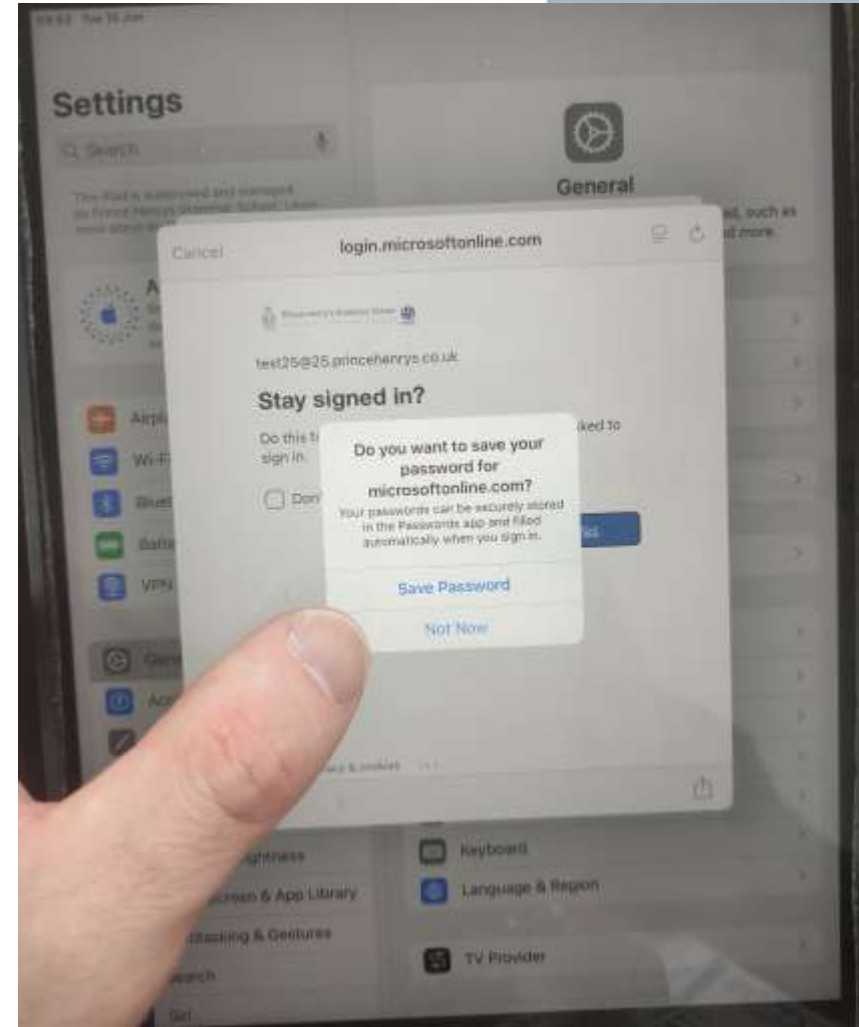

22. Click OK.

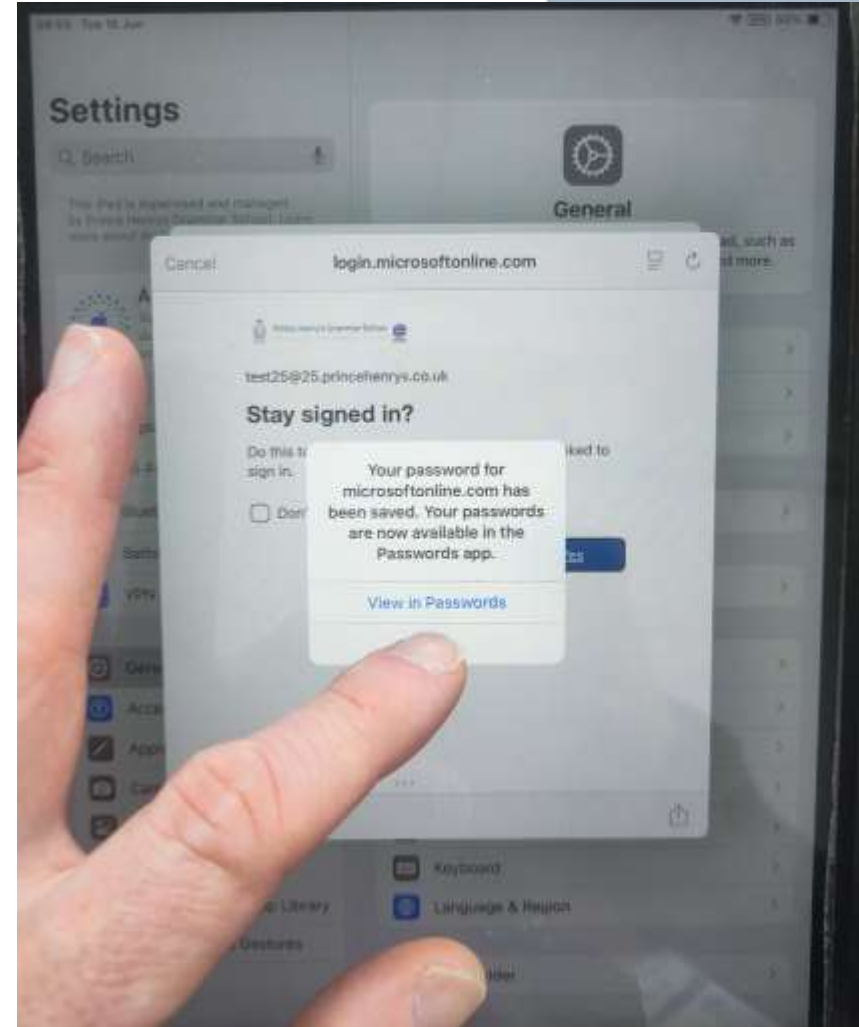

23. Click “Don’t show this again” and click Yes.

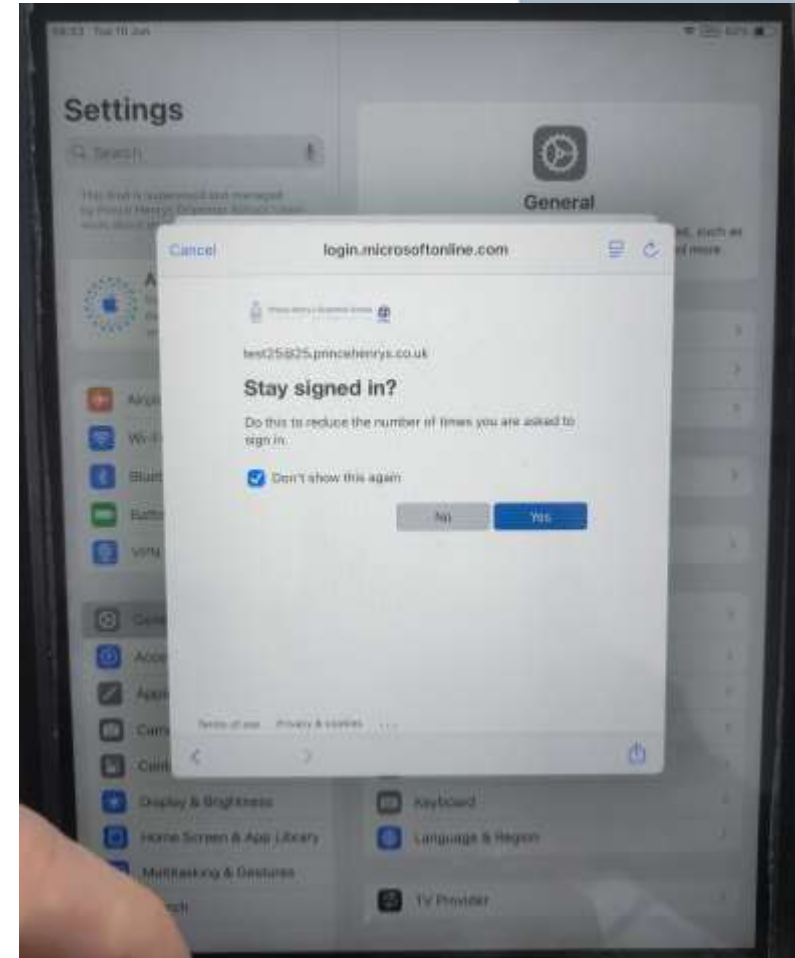

24. Allow the device to finish signing in.

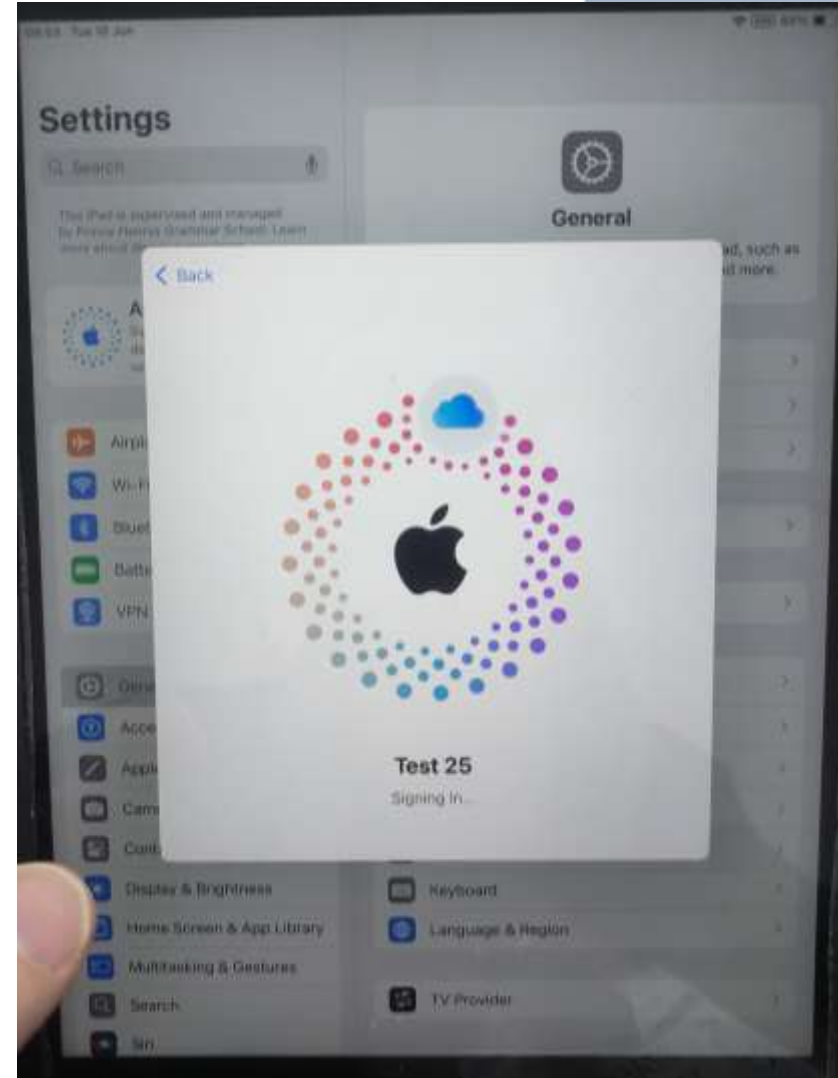

25. You may be asked to enter your iPad passcode if you have set one up!

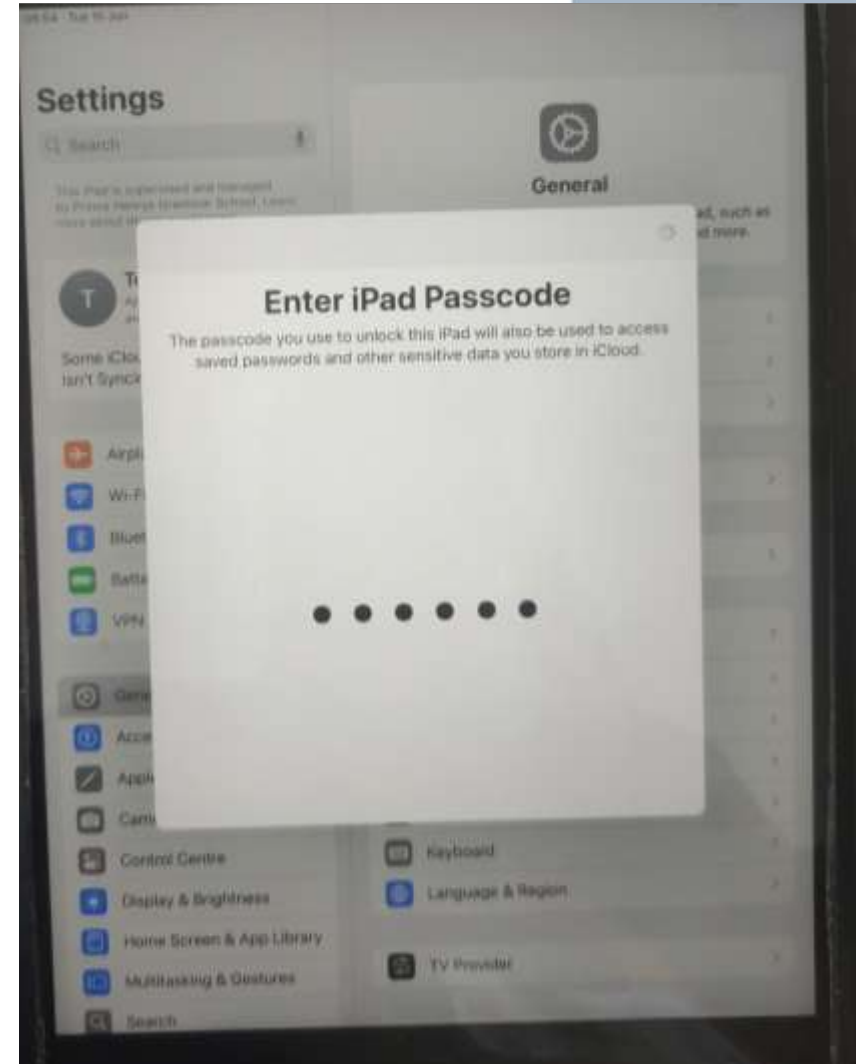

26. Your account should now show you into the school apple account. As a bonus, you will have 200GB of account space instead of 5GB included with a personal account.



27. Find the company Portal, and click it.

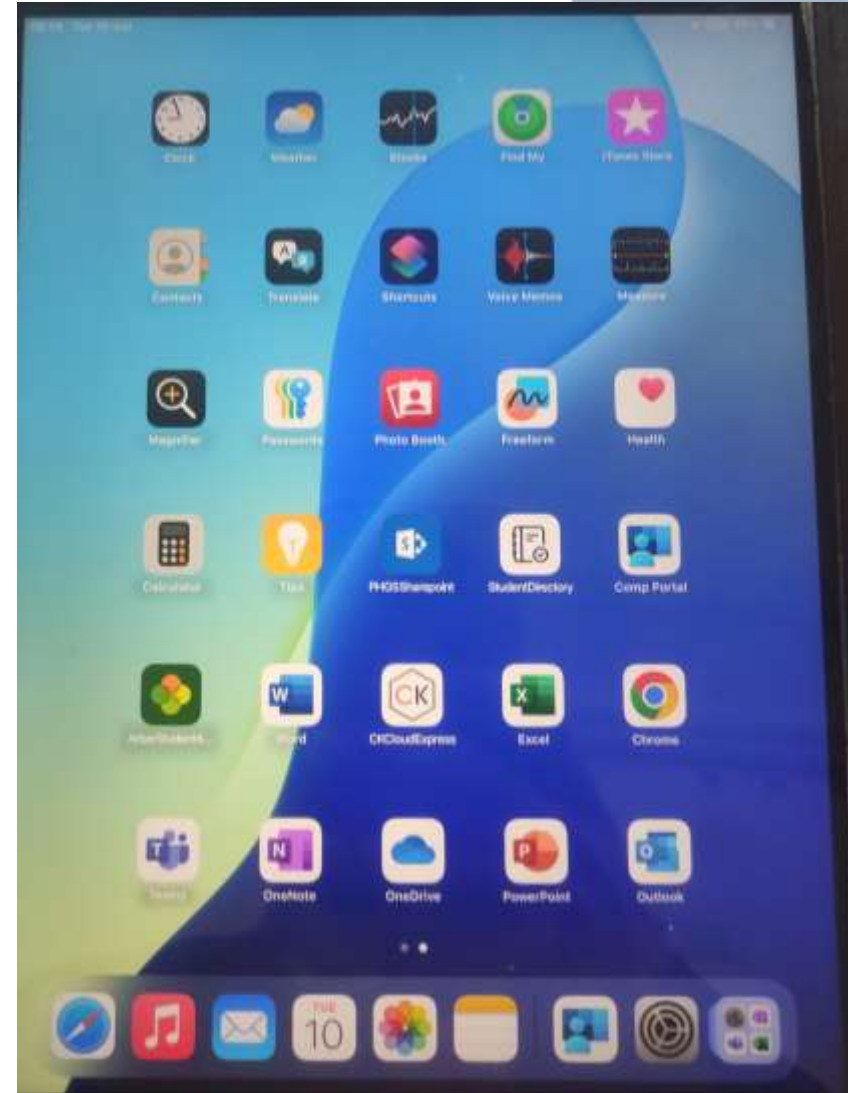

28. Click Sign in.

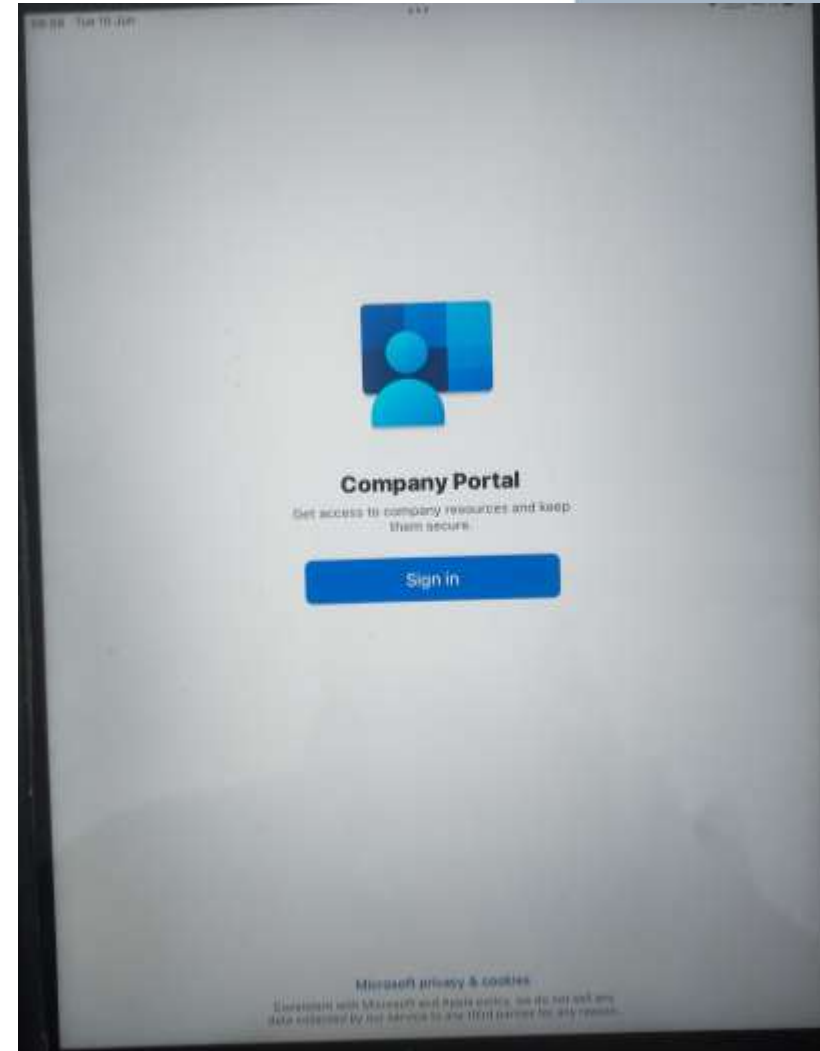

29. Sign in with your student email.

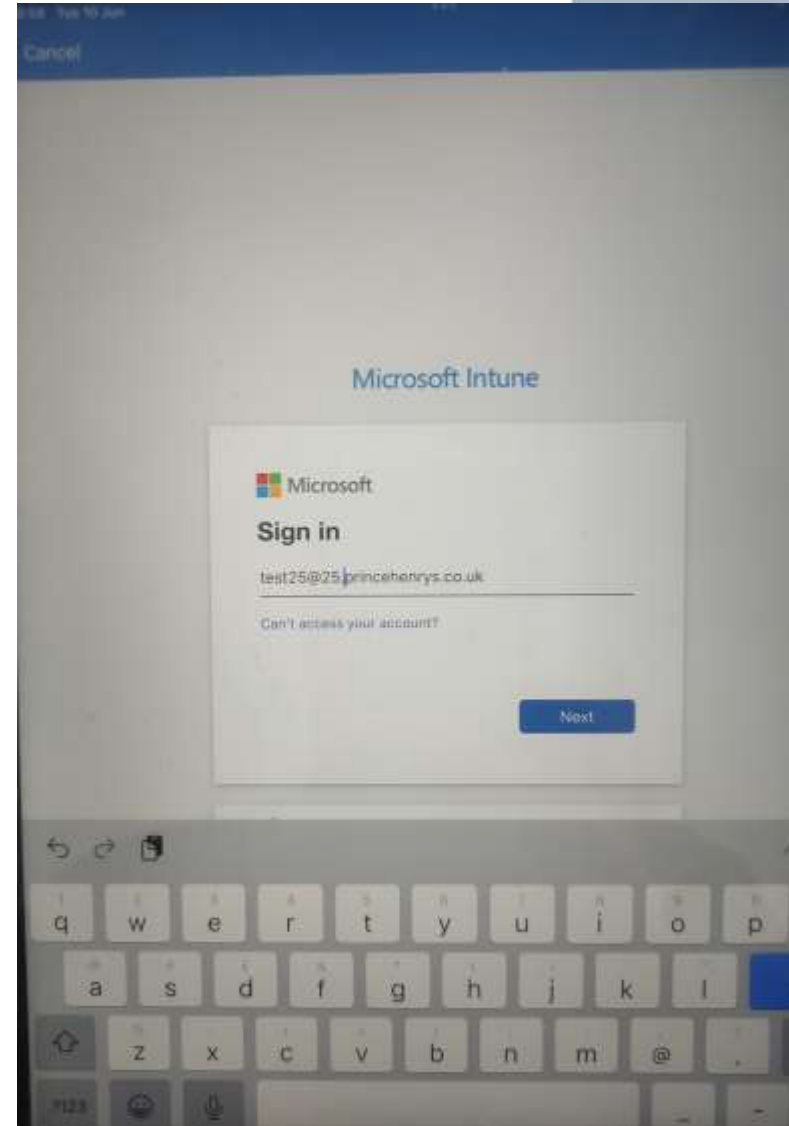

30. Enter your school computer/office 365 password.

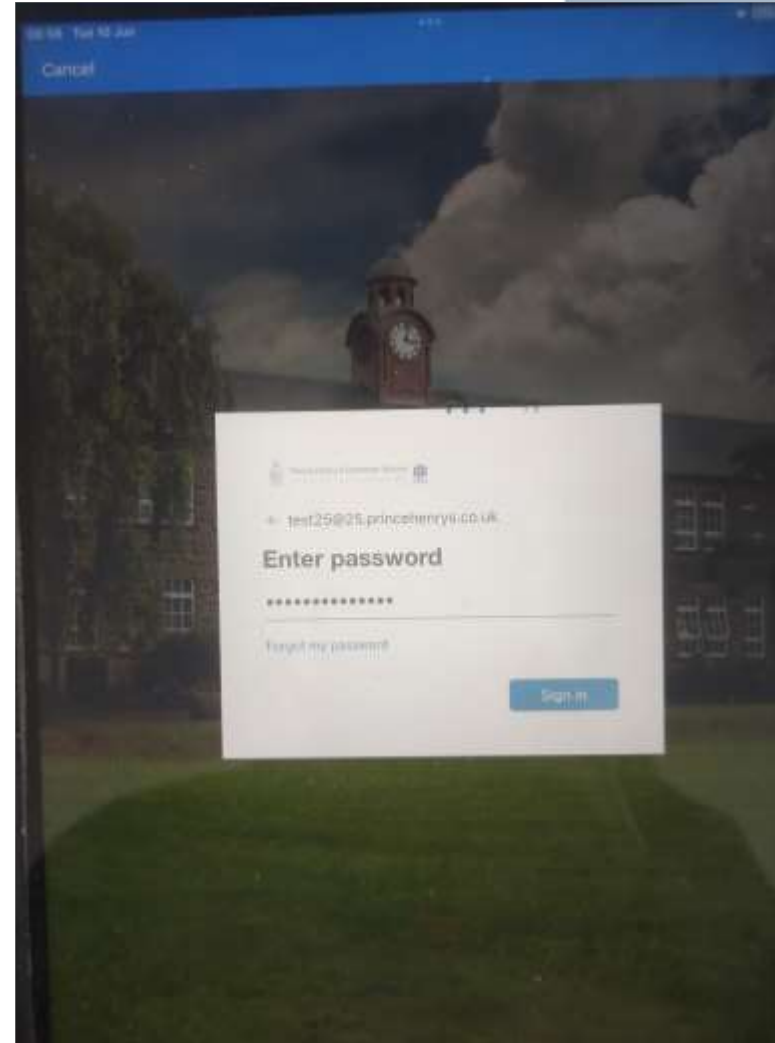

31. Click OK.

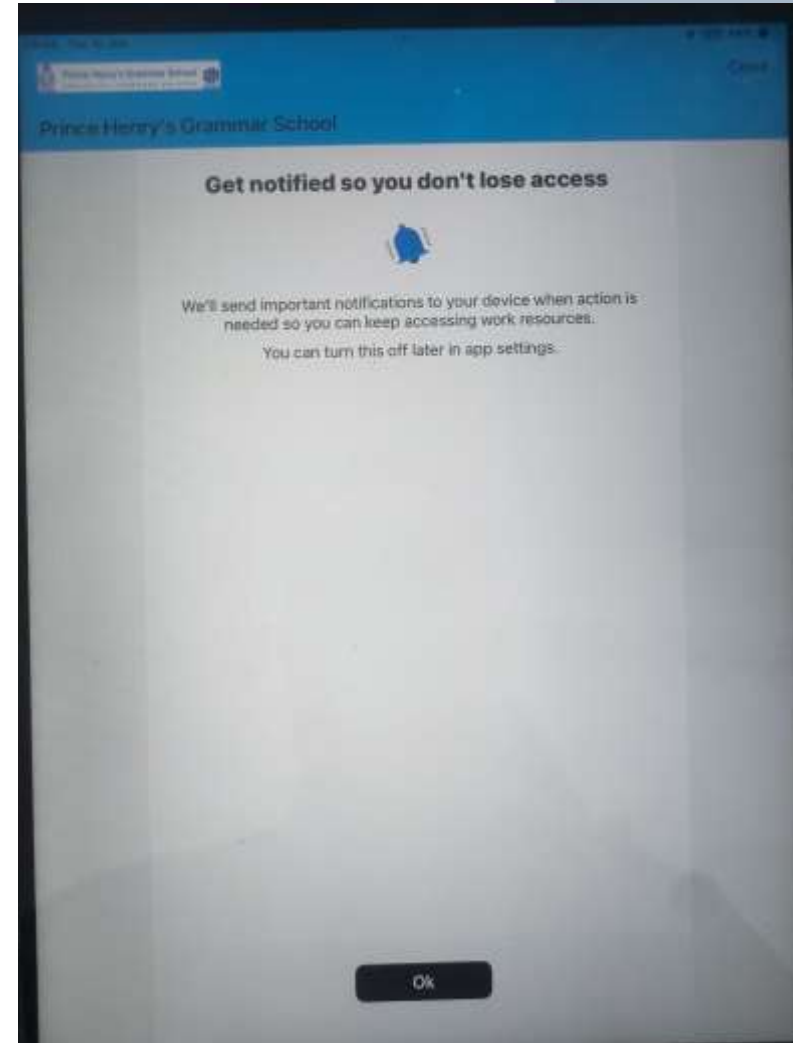

## 32. Click Allow.

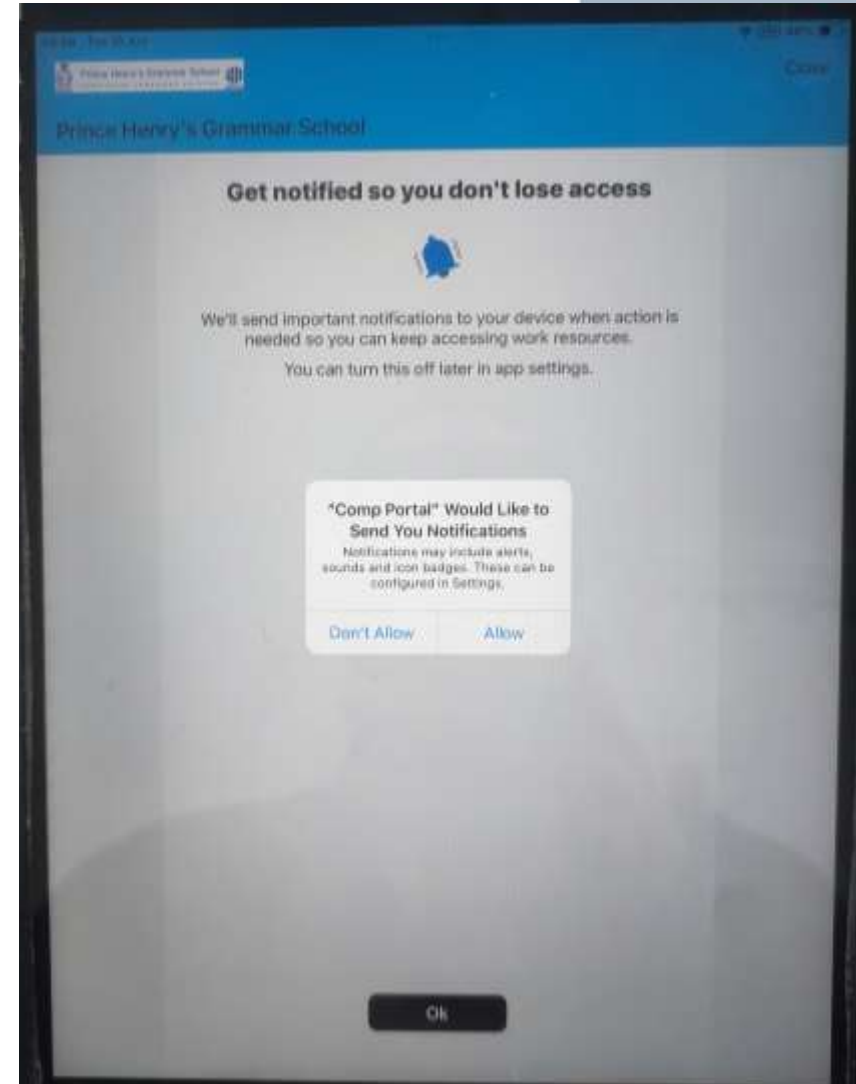

## 33. Click Begin.

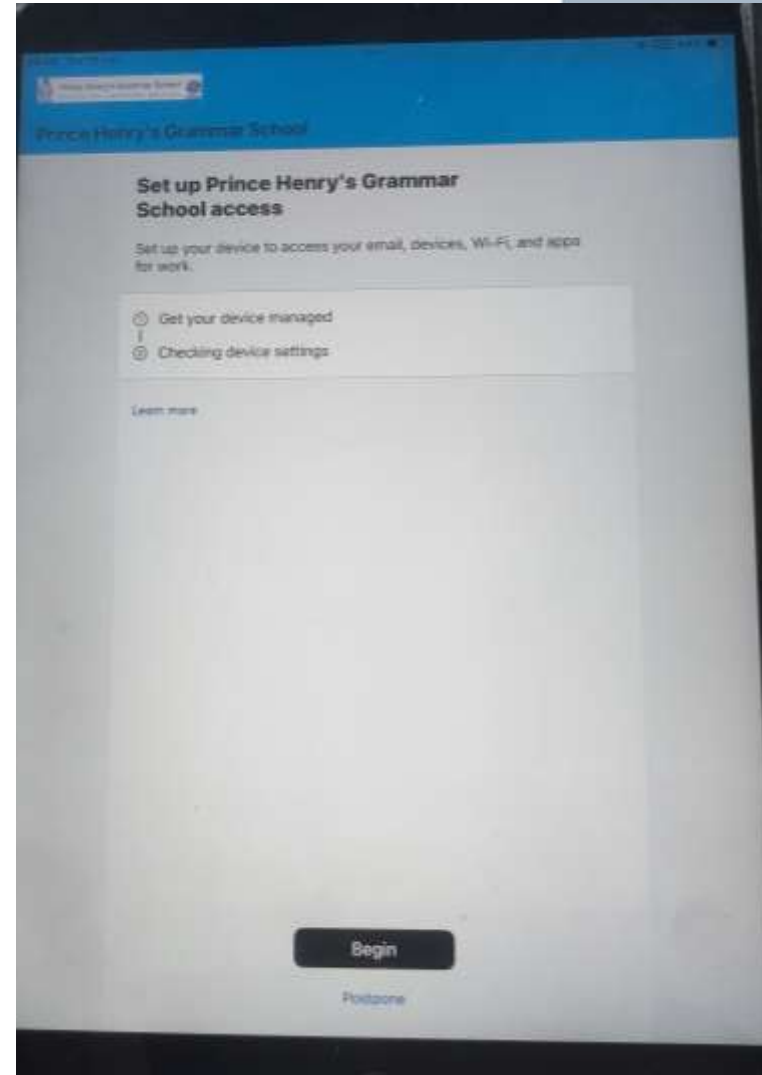

34. If the App asks to update then click update.

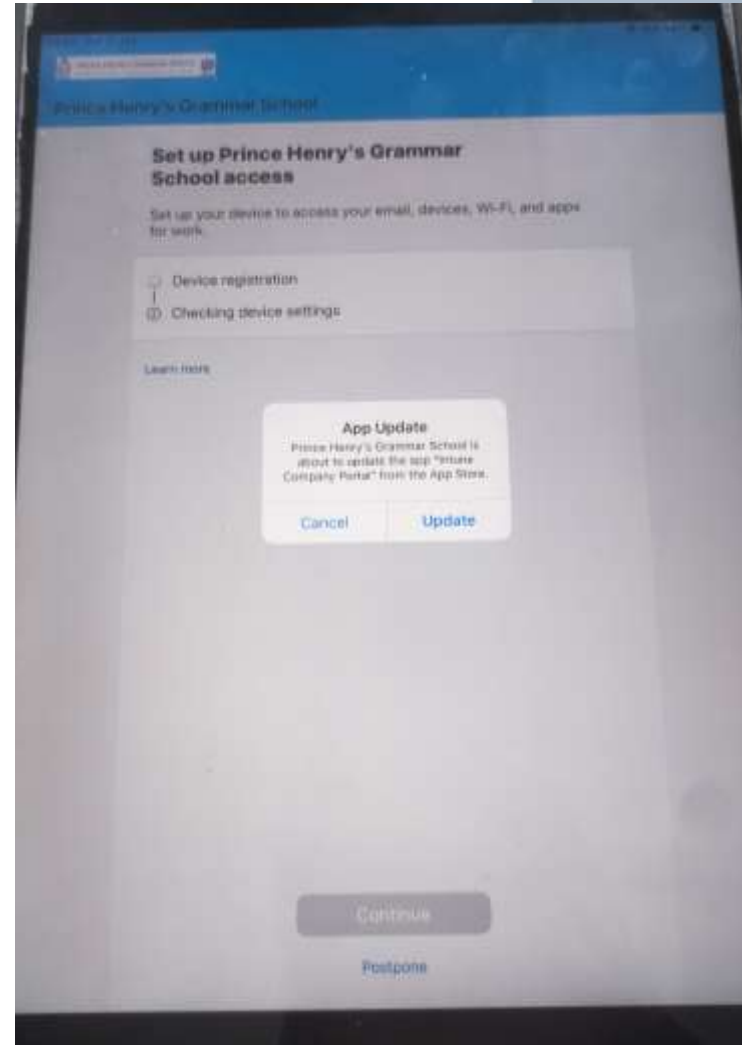

35. Click iPad, then click Continue.

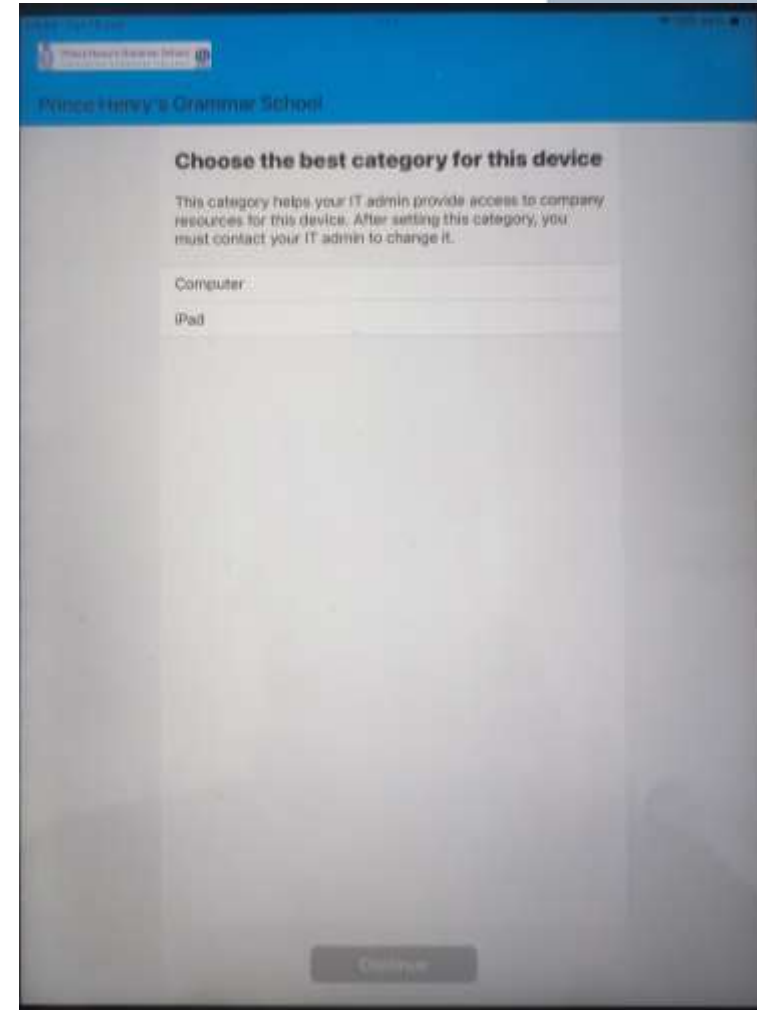

## 36. Click Continue.

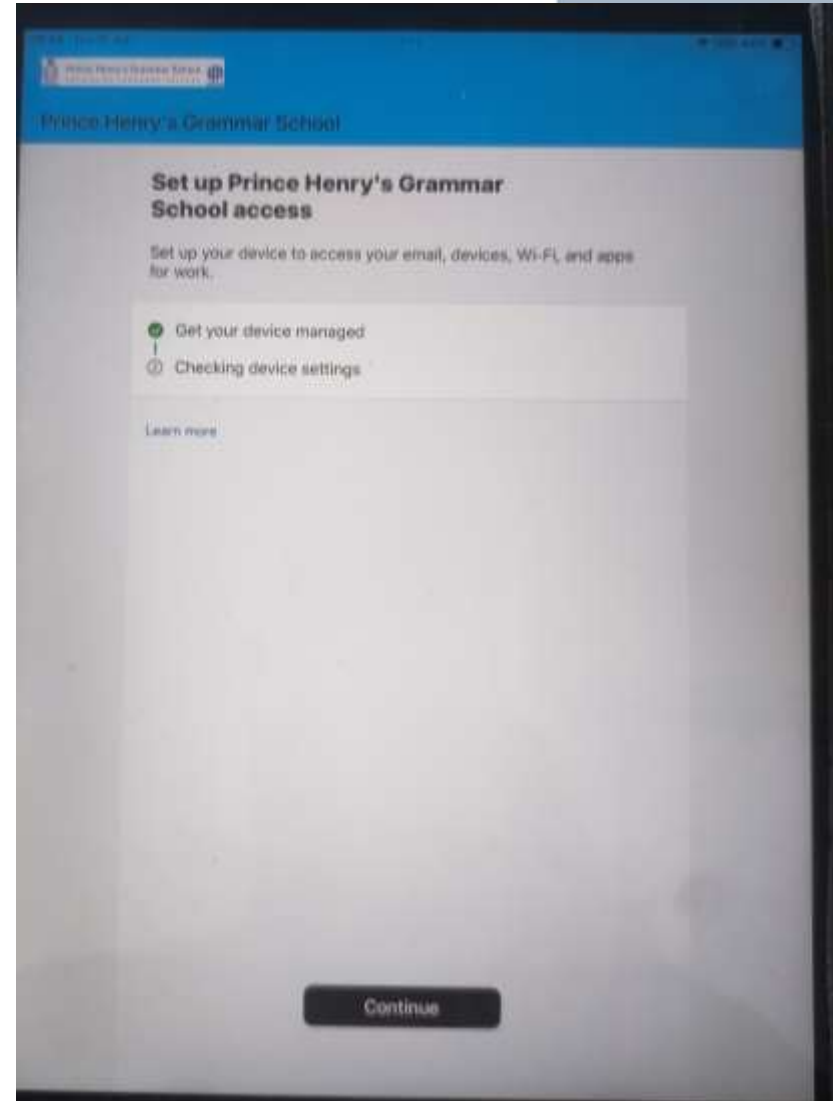

37. Allow the device to run its checks.

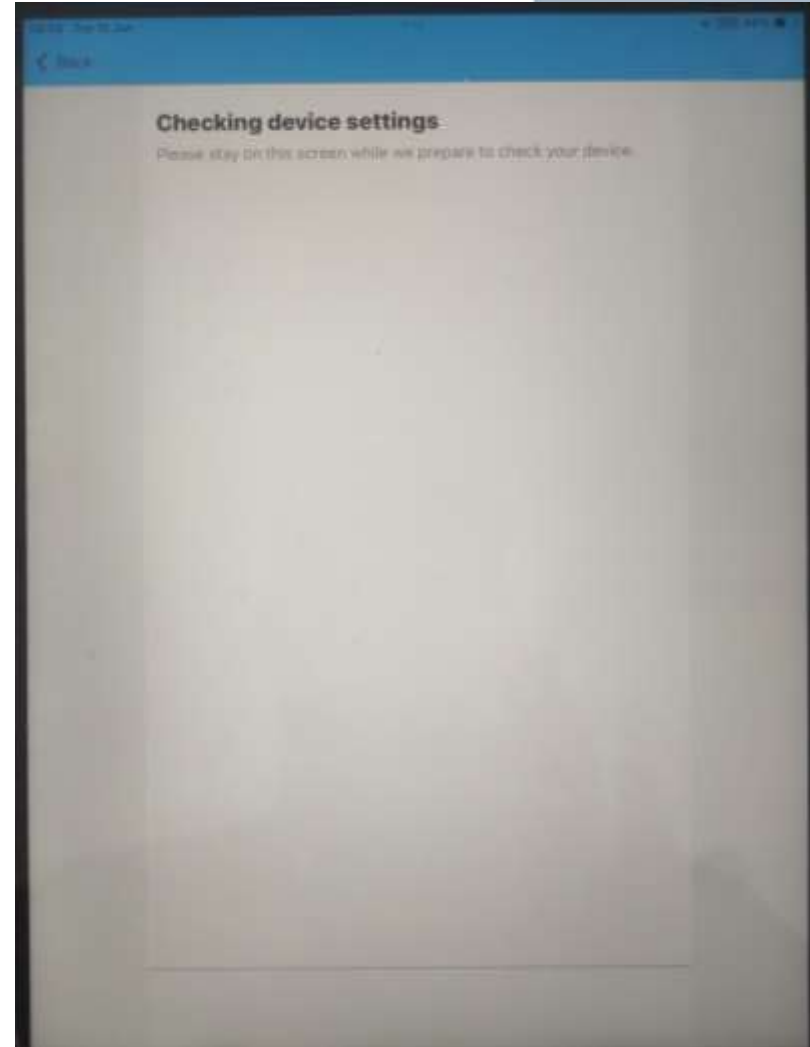

## 38. Click Done.

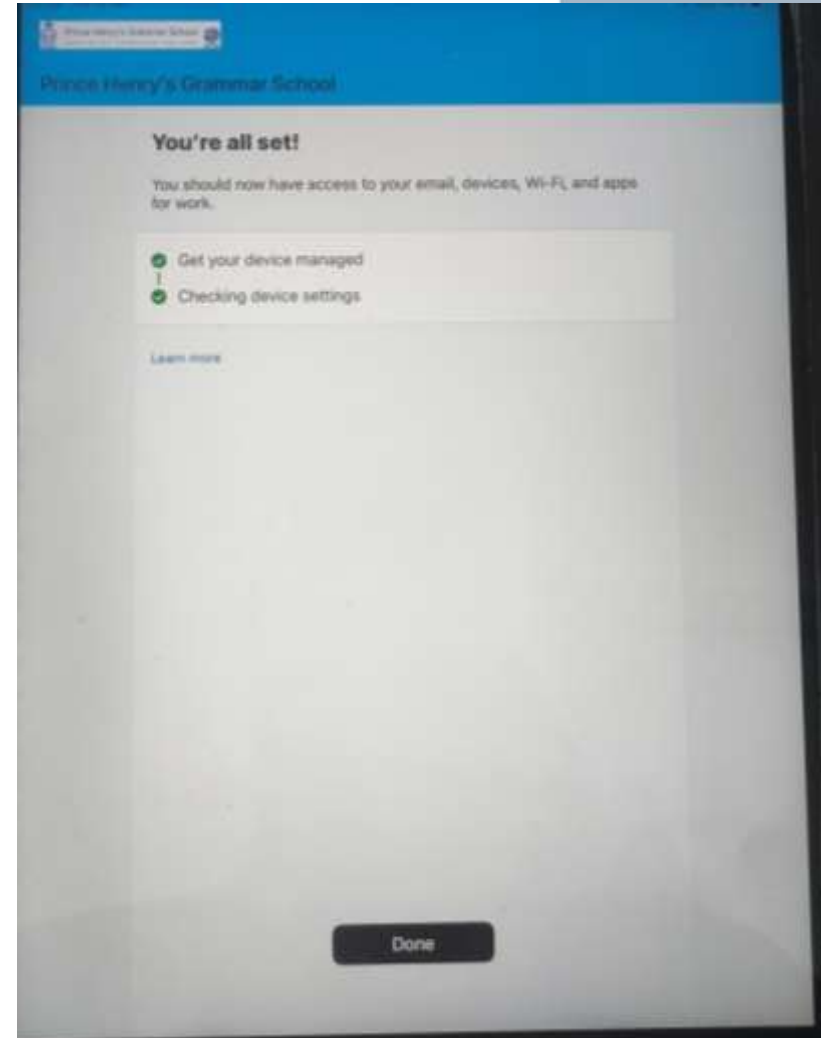

39. Now the setup is complete.

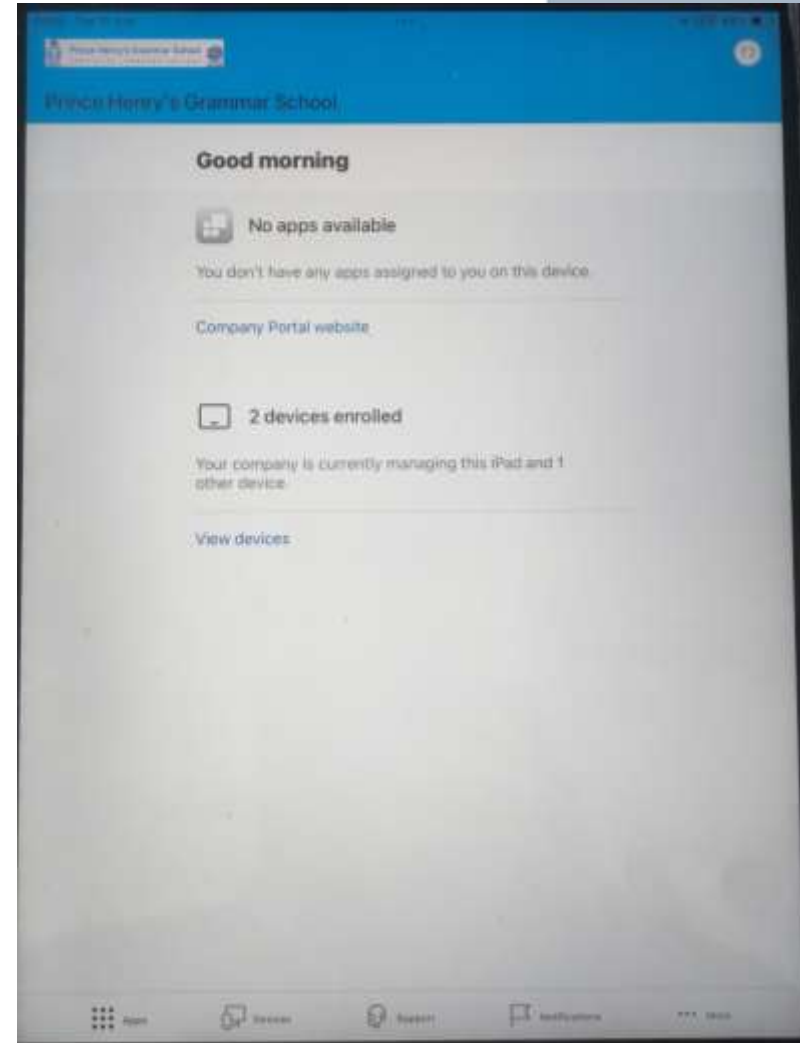



# Prince Henry's Grammar School

COLLABORATIVE LEARNING TRUST



Respect ♦ Flourish ♦ Achieve